

Student as Scholar

23RD ANNUAL UNDERGRADUATE RESEARCH FORUM

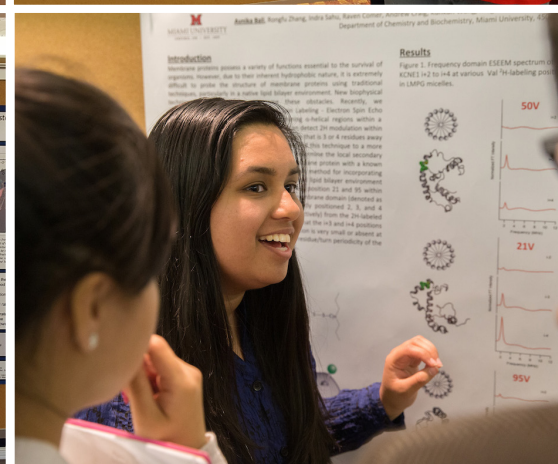

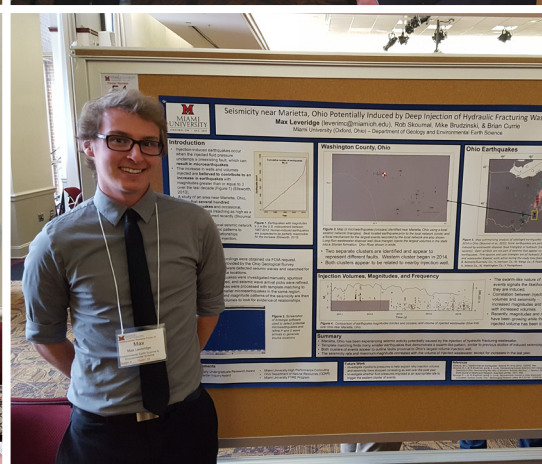
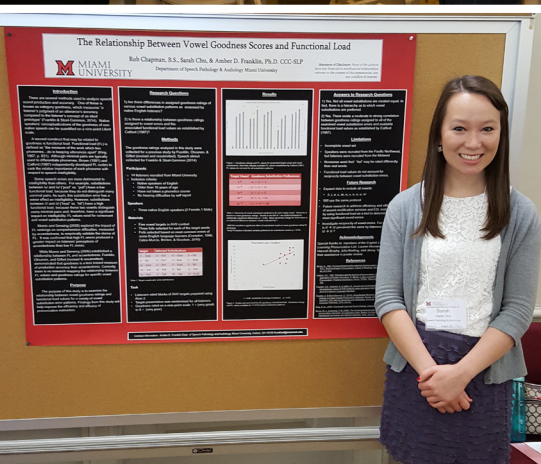
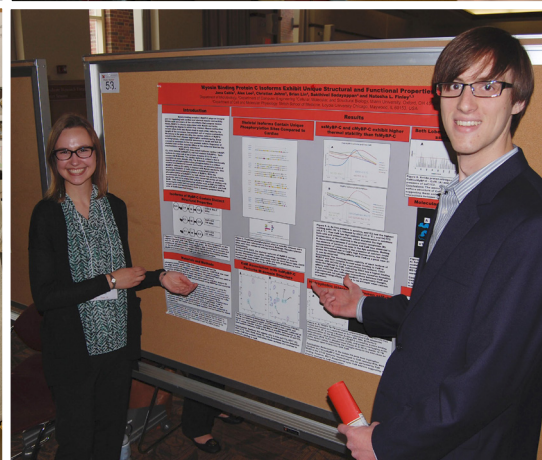
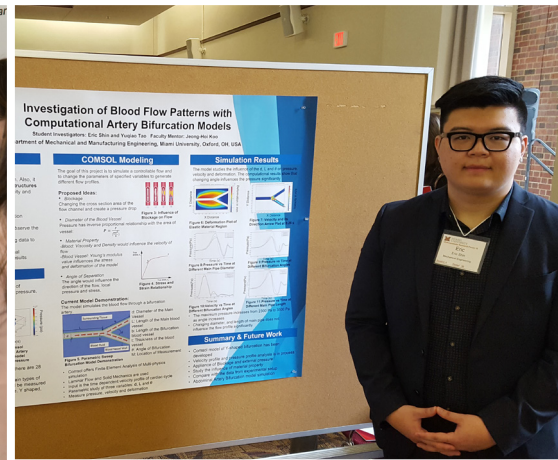
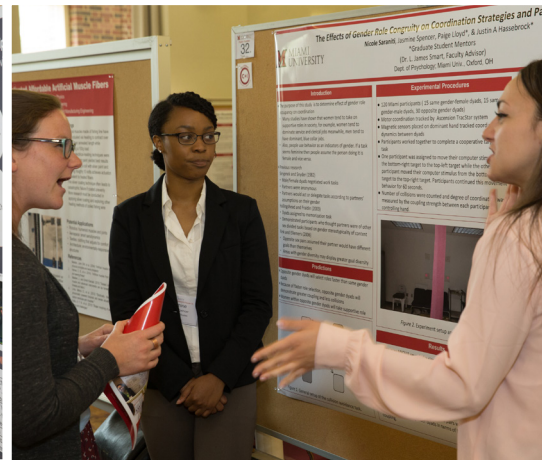

Message from the President and Dr. Crawford

Welcome to the 2017 Miami University Undergraduate Research Forum! We hope you are as excited as we are to participate in this celebration of research and inquiry. This program is your guide to the more than 350 projects being presented by more than 700 undergraduate researchers today.

In designing and implementing studies, analyzing data, and presenting results, these students have worked to move beyond just an idea – becoming innovators, collaborators, and creators. They are a part of a community of scholars that includes their faculty mentors, and the more than 1500 additional undergraduates who worked with professors on funded research this year. Students as scholars and creators of knowledge speak to an essential quality of the Miami Experience.

We invite you to connect with this community by talking with the presenters today. Ask them meaningful questions – not just about their results, but also about the process they went through to achieve them. As valuable as results can be, it's often the process that illuminates the path to innovation and true learning.

In its 23rd year, this Forum is the premier event celebrating independent inquiry by undergraduate students at Miami University. We offer our congratulations to this cohort of the Miami University Undergraduate Research Forum presenters, and we extend our sincere thanks to the students, faculty, and staff whose dedication and passion allow us to celebrate here today.

We are so proud. Enjoy!

Love and Honor,

Greg and Renate Crawford

Contact Information

ORU

Office of Research
for Undergraduates

P: 513-529-2455

122 King Library

MiamiOH.edu/oru

Table of Contents

President's Welcome Message	Inside Front Cover
Armstrong and Shriver Center Map and Sponsors	2
Undergraduate Research Forum Schedule of Events	3
Oral Presentation Schedule	4
Poster Presentation Schedule Session A	10
Poster Presentation Schedule Session B	22
Poster Presentation Schedule Session C	34
Miami Undergraduate Research: Recognizing Our Mentors	44
Miami Undergraduate Research Opportunities	48
<i>Office of Research for Undergraduates (ORU)</i>	48
<i>Council on Undergraduate Research</i> <i>Enhanced Membership thru ORU</i>	48
<i>Doctoral-Undergraduate Opportunities for Scholarship (DUOS)</i>	49
<i>First Year Research Experience (FYRE)</i>	49
<i>Undergraduate Research Award Program</i>	49
<i>Undergraduate Summer Scholars Program</i>	50
<i>College of Arts and Science Dean's Scholars Program</i>	50
<i>College of Arts and Science Hughes Medical Institute</i> <i>Summer Research Internships</i>	50
<i>National Fellowships</i>	51
<i>Global Initiatives</i>	51
<i>University Honors Program</i>	51
Acknowledgements	52
Presenters Index Undergraduate Research Forum	53
Miami Libraries invite student presenters to publish your poster in Miami Scholarly Commons	Inside Back Cover

Shriver Center Floor Plans

1ST FLOOR

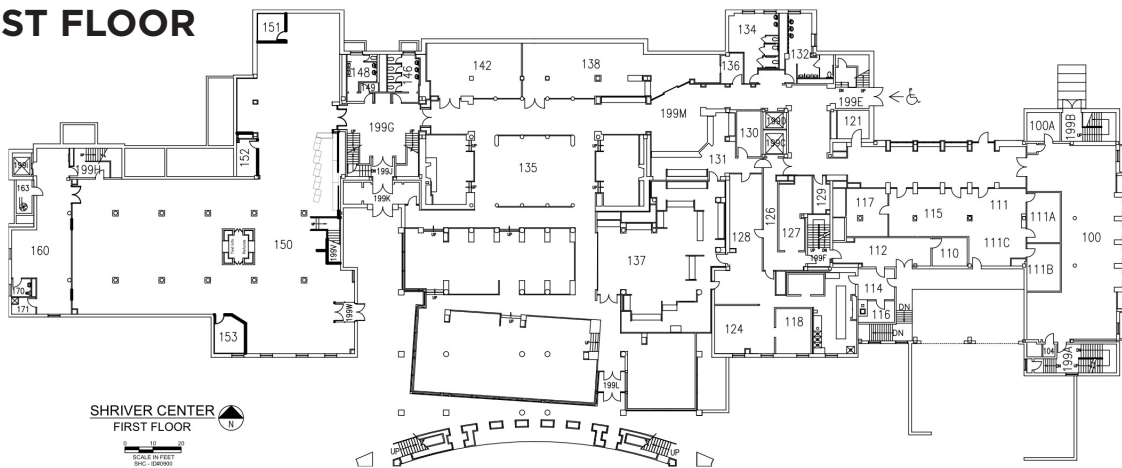

Armstrong Center Floor Plans

2ND FLOOR

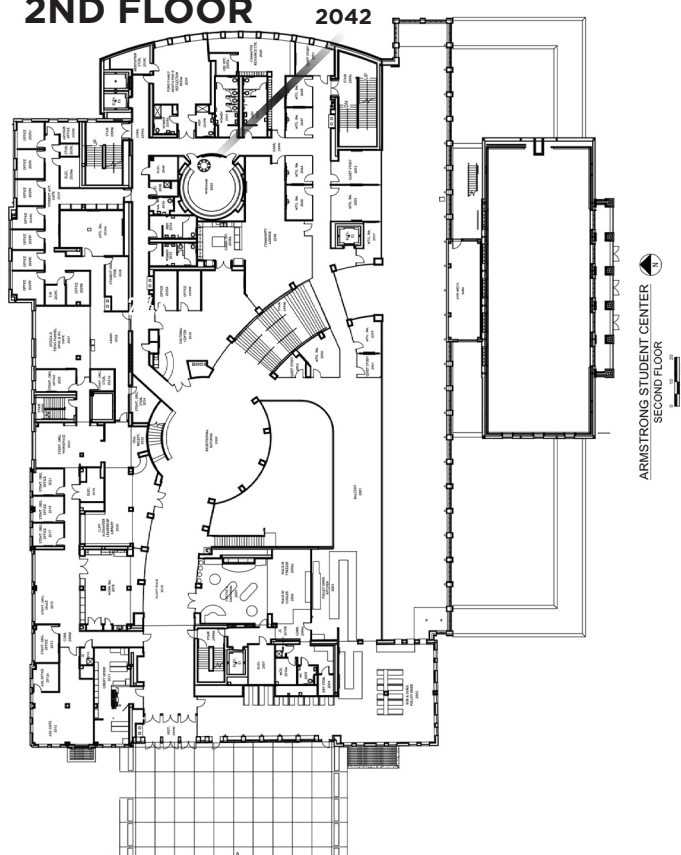

3RD FLOOR

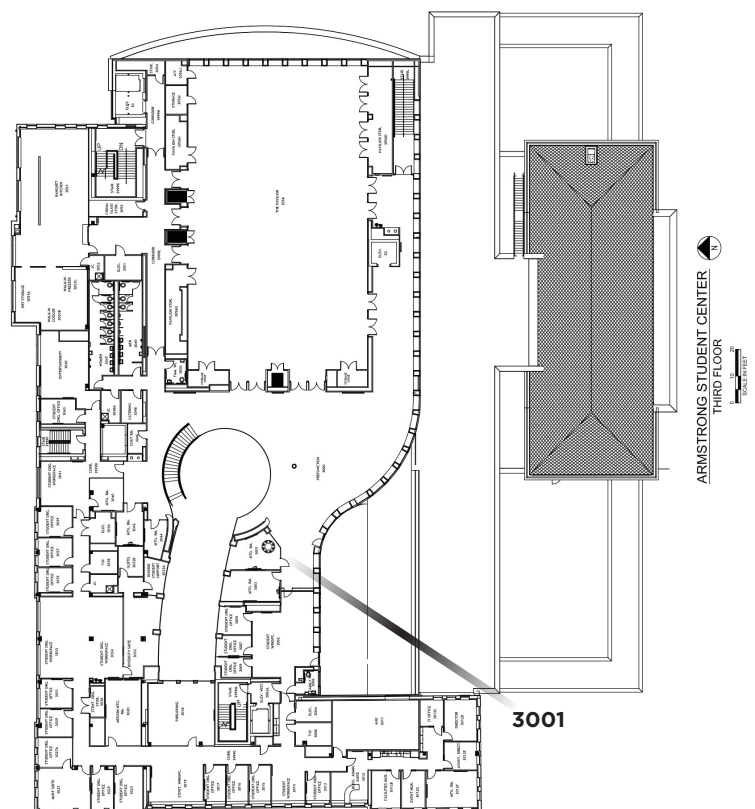

Undergraduate Research Forum 2017 Sponsors

Graduate School and Office for the Advancement of Research and Scholarship
Office of Research for Undergraduates
Provost and President



MIAMI UNIVERSITY
23RD ANNUAL UNDERGRADUATE RESEARCH FORUM

Schedule of Events

APRIL 26, 2017

Oral Presentations – Morning Sessions I, II , III

Session No.	Session Duration	Room	Room	Room
Session I	9:00 a.m. to 9:45 a.m.	ASC-2042	ASC-3001	ASC-3056B Pavilion
Session II	10:00 a.m. to 10:45 a.m.	ASC-2042	ASC-3001	ASC-3056B Pavilion
Session III	11:00 a.m. to 11:45 a.m.	ASC-2042	ASC-3001	ASC-3056B Pavilion

Luncheon

Heritage Room 11:45 a.m. to 1:15 p.m.

UR FORUM LUNCHEON SPEAKERS

12:00 p.m.

Introduction – James T. Oris, Associate Provost and Dean of the Graduate School

Welcome – Gregory P. Crawford, President

Remarks – Phyllis A. Callahan, Provost and Executive Vice President

Oral Presentations – Afternoon Sessions, IV, V, VI

Session No.	Session Duration	Room	Room	Room
Session IV	1:30 p.m. to 2:15 p.m.	ASC-2042	ASC-3001	ASC-3056B Pavilion
Session V	2:30 p.m. to 3:15 p.m.	ASC-2042	ASC-3001	ASC-3056B Pavilion
Session VI	3:30 p.m. to 4:15 p.m.	ASC-2042	ASC-3001	ASC-3056B Pavilion

Poster Sessions (Shriver John Dolibois Rooms)

Over 650 student presenters share the results of their research

Lobby Sessions A B C

Session A 10:00 a.m. – 11:30 a.m.

Session B 1:30 p.m. – 2:45 p.m.

Session C 3:00 p.m. – 4:30 p.m.

Oral Presentation Schedule

(See also index on pages 53 - 73)

SESSION I: 9:00 – 9:45 A.M.

Armstrong ASC-2042

SESSION MODERATOR: Diane Berish

Nathan Burns, Biochemistry Major

ADVISOR(S): Katia Del Rio-Tsonis Department of Biology
The Role of miRNAs in Chick Retina Regeneration

Joseph Landers, Biology Major

ADVISOR(S): Katia Del Rio-Tsonis Department of Biology
Nancy Paola Ruiz-Echeverri Department of Biology
N-acetyl Cysteine as an Inducer of Retina

Jared Tangeman, Biology Major

ADVISOR(S): Katia Del Rio-Tsonis Department of Biology
Agustin Luz-Madrigal Department of Biology
Epigenetic Reprogramming of the Embryonic Chick Retinal Pigmented Epithelium

Armstrong ASC-3001

SESSION MODERATOR: Megan Loftin

Henry Leaman, Sociology Major

ADVISOR(S): Kristen Budd Department of Sociology
and Gerontology
MU Student Opinions on University Discipline for Off Campus Alcohol Violations

Julia Pair, Social Justice Studies and English Professional Writing Major

ADVISOR(S): Kristen Budd Department of Sociology
and Gerontology
Correcting Controlled Substance Schedules to Reflect Scientific Research on Alcohol, Tobacco, and Marijuana and What that Will Mean for American Society

Stephanie Levin, Sociology Major

ADVISOR(S): Stephen Lippmann Department of Sociology
and Gerontology
Who Makes the Choice? Gender and the Pursuit of Entrepreneurship

Armstrong ASC-3056B

SESSION MODERATOR: Brianna Watson

Sydney Brinck, Business Economics Major

Heather Bonsky, Marketing Major
ADVISOR(S): Megan Gerhardt Department of Management
Personalities and Success

Lena Rutherford, Information Systems Major

Josh Sekerak, Accountancy and Finance Major
ADVISOR(S): Megan Gerhardt Department of Management
International Student Inclusion and Engagement

Brandi McConahay, Anthropology Interactive Media Studies Major

ADVISOR(S): Jeb Card Department of Anthropology
3D Archaeology

Oral Presentation Schedule

(See presenter index on pages 53 - 73)

SESSION II: 10:00 – 10:45 A.M.

Armstrong ASC-2042

SESSION MODERATOR: Nicole Cottone

Ken DeRose, Physics Major

ADVISOR(S): Samir Bali Department of Physics

Measurement of Slowlight in Electromagnetically Induced Transparency

Xin Dong, Chemical and Paper Engineering Major

ADVISOR(S): Samir Bali Department of Physics

Lalit Bali Department of Physics

Optical Sensor with Temperature and Flow Control for Particle Sizing in Turbid Media

Linzhaio Zhuo, Physics and Business Economics Major

ADVISOR(S): Andrew Hachtel Department of Physics

Samir Bali Department of Physics

"Twisted" Light: What Is It and How to Create It in the Lab?

Armstrong ASC-3001

SESSION MODERATOR: Luke Stanek

Hehe Wang, Chemistry Major

ADVISOR(S): Hong Wang Department of Chemistry and Biochemistry

Abdullah Bilal Altundas Department of Chemistry and Biochemistry

Synthesis of π -Extended Tetraphenylporphyrins

Christina Haffey, Zoology and Environmental Science Major

ADVISOR(S): David Gorchov Department of Biology

The Effects of Deer and an Invasive Shrub on Understory Herbs and Seedlings

George Gruenhagen, Bioengineering Major

ADVISOR(S): Richard Moore Department of Biology

Chun Liang Department of Biology

MITE Analysis in Angiosperms

Armstrong ASC-3056B

SESSION MODERATOR: Kevin Doherty

Zack McBride, English, Management and Leadership and Finance Major

ADVISOR(S): Karly Geller Department of Kinesiology and Health

Callie Maddox, Department of Kinesiology and Health
Big 5 Personality Traits as a Predictor of Success in Collegiate Track & Field

Daniel Kuperman, Finance and Sustainability Major

Palmer Holcomb, Finance and Business Economics Major

ADVISOR(S): Megan Gerhardt Department of Management
Investigating the Implications of Circadian Typology on Student Performance

Anna Cavagnaro, Psychology Major

ADVISOR(S): Amy Summerville Department of Psychology
Ryan Walker Department of Psychology

Effects of Regret Expressions on Warmth and Competence Ratings in a Social Context and a Business Context

Oral Presentation Schedule

(See presenter index on pages 53 - 73)

SESSION III: 11:00 – 11:45 A.M.

Armstrong ASC-3001

SESSION MODERATOR: Marshawn Brewer

Caleb Lowell, Political Science and Strategic Communication Major

ADVISOR(S): Shelly Jarrett Bromberg Department of Spanish and Portuguese
Elderly Care Facilities in Nicaragua

Julia Behrend, Biology Major

Giovanna Farinazo, Marketing Major

Nubia Colussi, Public Administration Major

ADVISOR(S): Paula Gandara Department of Spanish and Portuguese
Endangered Documents of the Amazon

Armstrong ASC-3056B

SESSION MODERATOR: Colin Widmer

Elizabeth Foley, Latin American, Latino/a, & Caribbean Studies and International Studies Major

ADVISOR(S): Elena Albarrán Latin American Studies Program
Pricing the Disabled Child: The Spectacle of Teletón in Neoliberal Chile

Kaitlin Thompson, Latin American, Latino/a, & Caribbean Studies and Social Work Major

ADVISOR(S): Elena Albarrán Department of History
Babies of the Banana Republic: Unpeeling Cultural Sensitivity in Transnational Adoptions at Home and Abroad

Mikayla Mitchell, International Studies Major

ADVISOR(S): Tani Sebro Global and Intercultural Studies Program
The Need for Intersectional Feminism on Miami's Campus

Oral Presentation Schedule

(See presenter index on pages 53 - 73)

SESSION IV: 1:30 – 2:15 P.M.

Armstrong ASC-2042

SESSION MODERATOR: Melvin Ikwubuo

Anthony Young, Physics Major

ADVISOR(S): Karthik Vishwanath Department of Physics
A Multi-wavelength, Wide-field Laser Speckle System for Imaging Flow

Tiago Schaeffer, Physics and Music Major

ADVISOR(S): Mahmud Khan Department of Physics
Jeffrey Brock Department of Physics
Exchange Bias Effect in Mn₂Ni_{1-x}Ga_{1-x}

Jacob McFarland, Physics Major

ADVISOR(S): Burcin Bayram Department of Physics
Time-Resolved Spectroscopy of Excited Sodium Dimers

Armstrong ASC-3001

SESSION MODERATOR: Veranica Rasicci

Brad Terrace, Latin American, Latino/a, & Caribbean Studies and Diplomacy and Global Politics Major

ADVISOR(S): José Amador Latin American Studies Program
From Home Run to Strikeout: How Politics Has Caused a Change in the Venezuelan Baseball Landscape

Mary Heath, Spanish and Latin American, Latino/a, & Caribbean Studies Major

ADVISOR(S): José Amador Latin American Studies Program
Undocumented Evangelism: Immigration, Detention, and Sanctuary on the U.S.-Mexican Border

Inma Sumaita, English Literature Major

ADVISOR(S): Andrew Hebard Department of English
American Naturalism and White Socialist Narratives

Armstrong ASC-3056B

SESSION MODERATOR: Colin Greig

Victoria Diana, Psychology Major

ADVISOR(S): Elise Radina Department of Family Science and Social Work
The Effect of Poverty on Single Mothers & Their Offspring: Understanding the Impact Beyond Financial Stressors

Mary Martin, Social Work Major

ADVISOR(S): Elise Radina Department of Family Science and Social Work
The Opiate Epidemic's Ground Zero

Claire Stemen, Comparative Media Studies and English Creative Writing Major

ADVISOR(S): Mack Hagood Department of Media Journalism and Film
Pantsuit Nation and the Power of Dress

Oral Presentation Schedule

(See presenter index on pages 53 - 73)

SESSION V: 2:30 – 3:15 P.M.

Armstrong ASC-2042

SESSION MODERATOR: Shelly Jarrett Bromberg

Lauren Gottschalk, Psychology and Environmental Science Major

ADVISOR(S): Allen McConnell Department of Psychology
Making Pledges More Powerful: Environmental Concern Appeals Affect Recycling Behavior

Sandra Glazer, Psychology Major

ADVISOR(S): Barbara Oswald Department of Psychology
Effects of Zen Coloring on Anxiety in Consistent- vs. Inconsistent Handers

Armstrong ASC-3001

SESSION MODERATOR: Kendra DeWater

Jessie Slattery, Physics Major

ADVISOR(S): Samir Bali Department of Physics
Patrick Janovick Department of Physics
Brillouin Resonances in Cold Atoms

Ann Rumsey, Manufacturing and Management Engineering Major

ADVISOR(S): Muhammad Jahan Department of Mechanical and Manufacturing Engineering
Micromachining of Glass for Microfluidic Applications - A Review

Garrett Long, Chemical and Paper Engineering Major

ADVISOR(S): Andrew Paluch Department of Chemical Paper and Biomedical Engineering
The Effect of Force Field Selection on Modeling Binary Aqueous Mixtures

Armstrong ASC-3056B

SESSION MODERATOR: Gisel Valladares

Victoria Diana, Psychology Major

ADVISOR(S): Rhett Brymer Department of Management
Scott Dust Department of Management
Beyond The Numbers: The Impact of Company Culture in Corporate Acquisitions

Catherine Mazanek, American Studies and Sustainability Major

ADVISOR(S): Marguerite Shaffer Global and Intercultural Studies Program
Sustainable Agriculture in Higher Education: Placing Miami University's Institute for Food in Context

McKenzie Crist, Zoology and Environmental Science Major

ADVISOR(S): Hafei Shi Department of Biology
Chris Zhu Department of Chemistry and Biochemistry
Minqian Shen Department of Biology
Effects of Estrogen on Leptin-Induced Growth in Human Colon Cancer Cells

Oral Presentation Schedule

(See presenter index on pages 53 - 73)

SESSION VI: 3:30 – 4:15 P.M.

Armstrong ASC-2042

SESSION MODERATOR: Abby Lyons

Adam Reece, Mechanical Engineering Major

ADVISOR(S): Jeong-Hoi Koo Department of Mechanical and Manufacturing Engineering

Characterization of Dynamic Responses of Bending Actuators Based on Magneto-Rheological Elastomers

Takdanai Tantiartyanontha, Mechanical Engineering Major

Eric Shin, Mechanical Engineering Major

ADVISOR(S): Jeong-Hoi Koo Department of Mechanical and Manufacturing Engineering

Generating Human Arterial Pulse Waveforms Using Controllable Magnetic Fluid

Imokhai Okolo, Social Justice Major

ADVISOR(S): Kristen Budd, Department of Sociology and Gerontology

MU Student Opinions on University Discipline for Off Campus Drug Violations

Armstrong ASC-3001

SESSION MODERATOR: Margaret Breidenbaugh

Hannah Regan, English Linguistics Major

ADVISOR(S): Jacque Daugherty Western Program

Abstinence-Only Sexuality Education Standards as Reflected in "The Secret Life of the American Teenager"

Ali Preissing, International Studies and Political Science Major

ADVISOR(S): Erica Edwards Department of Political Science

Immigration Irony: the UK after Brexit

Paul Fredrick, Political Science and History Major

ADVISOR(S): Erica Edwards Department of Political Science

The Rise of Radicalization and Terrorism in France

Armstrong ASC-3056B

SESSION MODERATOR: Caleb Stidham

Caitlin McElligott, Anthropology Major

ADVISOR(S): John Schaefer Department of Anthropology

The Educational Crisis: Viewpoints Ranging from Local to International

Lauren Ramsey, Biology Major

Mary Martin, Social Work Major

Danielle Jones, Public Health Major

Alyssa Oddo, Social Work Major

ADVISOR(S): Elise Radina Department of Family Science and Social Work

Welcome to My World: A Mix-Method Study of Parent's Lived Experiences in Raising Children with Primary Lymphedema

Poster Presentation Listing by Poster Number

SESSION A: 10:00 – 11:30 A.M.

SHRIVER LOBBY

(See presenter index on pages 53 – 73)

A01L Rachel Poyfair, Anthropology and Individualized Studies (Western Program) Major

Advisor(s): James Bielo, Department of Anthropology
The Aesthetics of Ideology

A02L Brandi McConahay, Anthropology and Interactive Media Studies Major

Advisor(s): Eric Hodgson, Armstrong Institute for Interactive Media Studies
Jeb Card, Department of Anthropology
Augmented Archaeology

A03L Kristine Camper, Biology and Anthropology Major

Advisor(s): Linda Marchant, Department of Anthropology
*Environmental Factors on Well-Being of Captive Pottos (*Perodicticus potto*) at the Cincinnati Zoo*

A04L Clayton Musolff, Architecture Major

Greg Heinrich, Architecture and Geography Major
Ruben Victoria, Architecture and Interactive Media Studies Major
Advisor(s): Murali Paranandi, Department of Architecture
Robotics and Kinetics Investigation

A05L Jimmy Devitt, Marketing Major

Advisor(s): Murali Paranandi, Department of Architecture
Unity 3D

A06L Madison Scheper, Architecture Major

Advisor(s): Murali Paranandi, Department of Architecture
Exploring Digital Manufacturing: Joinery Through 3D Printing

A07L Diana Suarez, Architecture and Sustainability Major

Advisor(s): Murali Paranandi, Department of Architecture
3D Printing and Design

A08L Tara Miller, Interactive Media Studies Major

Advisor(s): Murali Paranandi, Department of Architecture
3D Design

A09L Lindsay Thurston, Interactive Media Studies Major

Advisor(s): Murali Paranandi, Department of Architecture
Exploration in 3D Printing

A10L Carly Moro, Interior Design Major

ADVISOR(S): Murali Paranandi, Department of Architecture
3d Printing Technology Exploration

A11L Reed Gerber, Architecture Major

Zhengjia Huo, Architecture Major
Sam Olmsted, Architecture Major
Connor Wigton, Interactive Media Studies Major
Advisor(s): Murali Paranandi, Department of Architecture
Pop-up Art Gallery: Exploring Digital Fabrication

Poster Presentation Listing by Poster Number

SESSION A: 10:00 – 11:30 A.M.

JOHN DOLIBOIS ROOM

(See presenter index on pages 53 - 73)

- A01 Patrick Carroll**, Physics Major
Advisor(s): Jennifer Blue, Department of Physics
Social Collaboration and the Usage of Textbooks in an Introductory Physics Class
- A02 Sarah Hiner**, Medical Laboratory Science and Microbiology Major
Advisor(s): Annette Bollmann, Department of Microbiology
Keely Icardi, Department of Microbiology
Microbial Communities and Wild Beer Enrichments
- A03 Matthew Koehler**, Athletic Training Major
Advisor(s): Eric Brooks, Department of Kinesiology and Health
Bilateral Os Trigonum and Calcaneal-Navicular Coalition in a Female Collegiate Soccer Player
- A04 Quentin Mullen**, Athletic Training and Kinesiology Major
Advisor(s): Eric Brooks, Department of Kinesiology and Health
Complete Knee Dislocation and Associated Orthopedic Damage in a Division One Collegiate Football Player: A Case Report
- A05 Bri Higgins**, Nutrition and Kinesiology Major
Natalie Briggs, Nutrition Major
Advisor(s): Kyle Timmerman, Department of Kinesiology and Health
Victoria Warren, Department of Kinesiology and Health
Quantifying the Abilities of Older Adults to Meet Recommended Dietary Allowances
- A06 Sean Boyles**, Microbiology Major
Advisor(s): Yoshinori Tomoyasu, Department of Biology
Courtney Clark-Hachtel, Department of Biology
*Tracing the Developmental and Evolutionary Origin of Wing in Red Flour Beetle, *Tribolium castaneum**
- A07 Monica Fernandez**, Biology Major
Advisor(s): Yoshinori Tomoyasu, Department of Biology
Courtney Clark-Hachtel, Department of Biology
Elucidating the Role of Tergal and Pleural Tissues during Wing Formation in Red Flour Beetle
- A08 Samuel James**, Biology Major
Advisor(s): Yoshinori Tomoyasu, Department of Biology
David Linz, Department of Biology
Stinky Wings... Maybe?
- A09 Jacob Schultz**, Biology and Premedical Studies Major
Advisor(s): Yoshinori Tomoyasu, Department of Biology
Courtney Clark-Hachtel, Department of Biology
*Establishing the Giant Mayfly (*Hexagenia*) as a Model to Study the Origin of Insect Wings*
- A10 Michael Gunderman**, Mechanical Engineering Major
A Study of Augmented Flight Control Systems on a Radio-Controlled Aircraft
- A11 Anthony Rapp**, Physics and Music Major
Tiago Schaeffer, Physics and Music Major
Ben Amend, Physics and Mathematics Major
Jayson Rook, Physics and Computer Science Major
The Education Uses of an Interferometer
- A12 Hong Cai**, Physics and Mathematics Major
Advisor(s): Anna Ghazaryan, Department of Mathematics
Dynamic System Approach to Rosenzweig-MacArthur Model
- A13 Dylan Palo**, Physics and Mathematics Major
Symeon Stefan, Biology Major
Advisor(s): Paul Urayama, Department of Physics
Using Real Time Quantification of Autofluorescence Spectrum Shape to Distinguish Between Metabolic Responses Involving NADH Utilizing Pathways

Poster Presentation Listing by Poster Number

SESSION A: 10:00 – 11:30 A.M.

JOHN DOLIBOIS ROOM

(See presenter index on pages 53 – 73)

- A14 David Noviski**, Chemical and Paper Engineering Major
Anna Haralson, Psychology Major
Linh Le, Biology Major
Taylor Hurt, Biology and Premedical Studies Major
Advisor(s): Karthik Vishwanath, Department of Physics
Joseph Johnson, Department of Psychology
A New Method for Determining Heart Rate via Video Recording
- A15 Joshua Rutowski**, Mathematics Major
Advisor(s): Jiangjiang Zhu, Department of Chemistry and Biochemistry
Metabolic Shift of Staphylococcus aureus under Sublethal Dose of Methicillin in the Presence of Glucose
- A16 Anjali Prior**, Chemistry and Premedical Studies Major
Advisor(s): Haifei Shi, Department of Biology
Jiangjiang Chris Zhu, Department of Chemistry and Biochemistry
Minqian Shen, Department of Biology
Anthony Sallese, Department of Chemistry and Biochemistry
Differential Effects of Leptin on Normal Colon Cells and Colon Cancer Cells
- A17 Bradley Glazier**, Biology Major
Benjamin Hinkel, Biology Major
Advisor(s): Haifei Shi, Department of Biology
Qi Zhu, Department of Biology
Regulation of Lipid Metabolism by the Sympathetic Nervous System in Male and Female Mice
- A18 Mike Deal**, Biology and Kinesiology Major
Adam Meisler, Chemical and Paper Engineering Major
Advisor(s): Kyle Timmerman, Department of Kinesiology and Health
Physical Activity Level is Associated with Endogenous Antioxidants in Older Adults
- A19 Meredith Moser**, Psychology Major
Advisor(s): Amy Summerville, Department of Psychology
Ryan Walker, Department of Psychology
Influence of Counterfactual Thought on Academic Performance
- A20 Le Chang**, Mathematics and Statistics and Finance Major
Advisor(s): Ying-Ju Chen, Department of Information Systems and Analytics
A Study of Statistical Inference for Kidney Transplant
- A21 Marie Brake**, Zoology Major
Advisor(s): Jon Costanzo, Department of Biology
James Wiebler, Department of Biology
Analysis of Gut Microflora in the Wood Frog (Rana sylvatica) from Interior Alaska
- A22 Tori Ethridge**, Biology and Premedical Studies Major
Paul Bissmeyer, Biology and Premedical Studies Major
Advisor(s): Ann Rypstra, Department of Biology
Michael Stanley, Department of Biology
Jake Godfrey, Department of Biology
Foraging Effects of Atrazine on Wolf Spiders Pardosa milvina
- A23 Erin Enright**, Biochemistry Major
Zachary DeMartini, Chemistry Major
Daniel Stoecklein, Chemistry and Premedical Studies Major
Sean Inutsuka, Biochemistry Major
Michael Harris, Chemistry Major
Advisor(s): Michael Crowder, Department of Chemistry and Biochemistry
Politics and Global Warming
- A24 Savannah Rice**, Geology and Sustainability Major
Jack Miles, Geology Major
Noah Frey, Geology and Spanish Major
Advisor(s): Brian Currie, Department of Geology and Environmental Earth Science
Patrick Cullen, Department of Geology and Environmental Earth Science
Creating an Initial Exploration Framework for the Berea Sandstone within the Appalachian Basin

Poster Presentation Listing by Poster Number

SESSION A: 10:00 – 11:30 A.M.

JOHN DOLIBOIS ROOM

(See presenter index on pages 53 - 73)

- A25 Maren Osterholt**, Biology Major
Advisor(s): Carole Dabney-Smith, Department of Chemistry and Biochemistry
Christopher Makaroff, Department of Chemistry and Biochemistry
Ramja Sritharan, Department of Chemistry and Biochemistry
Investigating the Role of SYN3 in Chloroplasts
- A26 Sarah Kosse**, Biology and Premedical Studies Major
Advisor(s): Katia Del Rio-Tsonis, Department of Biology
Agustin Luz-Madrigal, Department of Biology
Analysis of DNA Methylation During RPE Reprogramming Towards Retina Regeneration
- A27 Annie Bryan**, Psychology Major
Advisor(s): Amanda Diekman, Department of Psychology
Melissa Fuesting, Department of Psychology
Benevolent Sexism as a Predictor of Critical Feedback
- A28 Lana Pochiro**, Urban and Regional Planning and Political Science Major
Advisor(s): Bruce D'Arcus, Department of Geography
Play in the Neoliberal City: A Study of Youth Spaces in Over-the-Rhine, Cincinnati
- A29 Jeffrey Caldwell II**, Media and Culture Major
Advisor(s): Rodney Coates, Black World Studies Program
Let's Make America Great Again: Let's Start in the Ghetto
- A30 John Latimer**, Biology and Neuroscience Major
Advisor(s): Dawn Blitz, Department of Biology
Central Effects of Hormonal Neuromodulation on Muscle Contraction
- A31 Jack Bennett**, Chemistry Major
Justin Moon, Medical Laboratory Science Major
Emily Curen, Psychology and Neuroscience Major
Brooke Buckingham, Biology Major
Advisor(s): Joyce Fernandes, Department of Biology
Divyalakshmi Soundararajan, Department of Biology
FYRE: Similarities and Differences in the Way Organisms Make Muscle
- A32 Isaiah Jacques**, Microbiology Major
Ryan Kaplevatsky, Biology Major
Mitchell Singstock, Philosophy Major
Matt Megura, Biology Major
Advisor(s): Joyce Fernandes, Department of Biology
Divyalakshmi Soundararajan, Department of Biology
FYRE: Investigating Intercellular Signalling During Flight Muscle Development in Drosophila
- A33 Natalie Cavalco**, University Studies Major
Jeffrey Rhoades, Biology Major
Sam Lewis, Biology Major
Jermaine Carew, Biology Major
Advisor(s): Joyce Fernandes, Department of Biology
Divyalakshmi Soundararajan, Department of Biology
First Year Research Experience: UNV171A/UNV172A: A Pilot Research Based Course in Invertebrate Neurobiology
- A34 Leah Kuhn**, Chemistry Major
Nick Simbartl, Biochemistry Major
Jenn Peters, Biochemistry Major
Megan Jackson, Microbiology Major
Advisor(s): Joyce Fernandes, Department of Biology
Divyalakshmi Soundararajan, Department of Biology
FYRE: Manipulating Muscle Development in Drosophila

Poster Presentation Listing by Poster Number

SESSION A: 10:00 – 11:30 A.M.

JOHN DOLIBOIS ROOM

(See presenter index on pages 53 – 73)

- A35** **Brittany Nordhaus**, Psychology and Neuroscience Major
Kira Osowski, Psychology Major
Nikita Patel, Kinesiology and Neuroscience Major
Caitlin Douglas, Zoology Major
Keith Schilstra, Zoology Major
Madison Enderson, Zoology and Premedical Studies Major
Mallory Myers, Zoology and Neuroscience Major
Adam Davisson, Zoology Major
Jennifer Nixdorf, Zoology Major
Yitong He, Biology Major
Christina Ebenroth, Biology and Premedical Studies Major
Taylor Boll, Biology and Premedical Studies Major
Rishav Banerjee, Biology and Premedical Studies Major
Advisor(s): Joyce Fernandes, Department of Biology
Valerine Rajathi, Department of Biology
Aswati Subramanian, Department of Biology
Change is Inevitable: Plasticity in the Brain
- A36** **Brittany Nordhaus**, Psychology and Neuroscience Major
Nikita Patel, Kinesiology and Neuroscience Major
Christina Ebenroth, Biology and Premedical Studies Major
Taylor Boll, Biology and Premedical Studies Major
Rishav Banerjee, Biology and Premedical Studies Major
Madison Enderson, Zoology and Premedical Studies Major
Mallory Myers, Zoology and Neuroscience Major
Caitlin Douglas, Zoology Major
Keith Schilstra, Zoology and Gerontology Major
Kira Osowski, Psychology Major
Adam Davisson, Zoology Major
Jennifer Nixdorf, Zoology Major
Yitong He, Biology Major
Advisor(s): Joyce Fernandes, Department of Biology
Aswati Subramanian, Department of Biology
Valerine Rajathi, Department of Biology
It's All in the Genes: Manipulating Glia in Drosophila
- A37** **Sydney O'Wesney**, Anthropology and Sustainability Major
Advisor(s): Melany Fisk, Department of Biology
Shinjini Goswami, Department of Biology
Seedling Allocation Response to Nutrient Addition in Northern Hardwood Forest
- A38** **Mayu Nakano**, English Creative Writing and East Asian Languages and Cultures Major
Advisor(s): Kazue Harada, GRAMELAC Department
A Tale of Two Nations: The Perception and the Role of Disability in Flowers for Algernon and A Personal Matter
- A39** **Madison Baker**, Zoology and Psychology Major
Advisor(s): Richard Lee, Department of Biology
J. D. Gantz, Department of Biology
The Effects of Drought- and Cold-Induced Rapid Cold-Hardening on Flight Ability in the Flesh Fly, Sarcophaga bullata
- A40** **Olivia Richter**, Biology and Environmental Science Major
Advisor(s): Maria Gonzalez, Department of Biology
Tanner Williamson, Department of Biology
Interactive Effects of Sediment and Nutrients on Zooplankton Communities
- A41** **Ella Sedacca**, Zoology Major
Advisor(s): Maria Gonzalez, Department of Biology
Michael Vanni, Department of Biology
Amber Rock, Department of Biology
Tanner Williamson, Department of Biology
Differences in Rotifer Population Dynamics in an Ohio Reservoir in Years with Contrasting Environmental Conditions
- A42** **Carly Gemma**, Biology and Premedical Studies Major
Advisor(s): Paul Harding, Department of Biology
Sean Taylor, Department of Biology
Novel Insights into the Molecular Mechanisms of Transdifferentiation of Cells into Brown Adipose Tissue-like Cells

Poster Presentation Listing by Poster Number

SESSION A: 10:00 – 11:30 A.M.

JOHN DOLIBOIS ROOM

(See presenter index on pages 53 - 73)

- A43 Daniel Pfeil**, Mechanical Engineering Major
Advisor(s): Paul Harding, Department of Biology
Sean Taylor, Department of Biology
Cellular Reprogramming into Brown Adipose Tissue (BAT) -like Cells Is Independent of Mature Heparin-binding EGF-like Growth Factor (HB-EGF) and HB-EGF C Domains
- A44 Abby Begezda**, Biology and Premedical Studies Major
Aonesti Williams, Biology and Premedical Studies Major
Amanda Hayes-Puttfarcken, Zoology Major
Advisor(s): Susan Hoffman, Department of Biology
Joseph Baumgartner, Department of Biology
Jeremy Papuga, Department of Biology
*Examining the Genetic Consequence of Habitat Fragmentation in the northern Michigan white-footed mouse (*Peromyscus leucopus noveboracensis*)*
- A45 Olivia Owens**, Botany and Environmental Science Major
Advisor(s): Carolyn Keiffer, Department of Biology
Growing American Chestnut Hybrids in southwest Ohio
- A46 Cassandra Worner**, Microbiology and Neuroscience Major
Austin Schafer, Biology and Premedical Studies Major
Advisor(s): Kathleen Killian, Department of Biology
Mollie Sorrell, Department of Biology
Role of Fragile X in Maintaining the Adult Neurogenic Niche
- A47 Yunhan Zhang**, Chemistry Major
Advisor(s): Benjamin Gung, Department of Chemistry and Biochemistry
Reinforce the Enantioselectivity by Introducing a Thermal Chiral Ligand to N-Heterocyclic Carbenes (NHCs) Au(I) Catalysts
- A48 Taylor Becker**, Biochemistry Major
Advisor(s): Michael Kennedy, Department of Chemistry and Biochemistry
Faizule Hassan, Department of Chemistry and Biochemistry
Adenovirus Mediated Delivery of an Engineered DNA Sequence for Pancreatic Cancer Treatment
- A49 Hannah Ruby**, Biochemistry and Premedical Studies Major
Sabina Bashir, Biochemistry and Premedical Studies Major
Advisor(s): Michael Kennedy, Department of Chemistry and Biochemistry
Tafadzwa Chihanga, Department of Chemistry and Biochemistry
Identification of Urine Metabolic Biomarkers for Hypoxia-Induced Acute Kidney Injury Mouse Model
- A50 Brian Spinello**, Biochemistry Major
Advisor(s): Scott Hartley, Department of Chemistry and Biochemistry
Gopi Nath Vemuri, Department of Chemistry and Biochemistry
Analyzing Functionalized ortho-Phenylenes Using ¹H NMR
- A51 Allison Theberge**, Biochemistry Major
Amy Trowbridge, Biology Major
Advisor(s): Richard Bretz, Department of Chemistry and Biochemistry
Marcia Lee, Department of Microbiology
*The Isolation and Determination of Two Related Compounds from the Leaf Gel of *Aloe cameronii**
- A52 Amy Trowbridge**, Biology Major
Sara Wagner, Microbiology Major
Advisor(s): Marcia Lee, Department of Microbiology
Richard Bretz, Department of Chemistry and Biochemistry
Investigating Antifungal Mechanisms of Plant-derived Compounds

Poster Presentation Listing by Poster Number

SESSION A: 10:00 – 11:30 A.M.

JOHN DOLIBOIS ROOM

(See presenter index on pages 53 – 73)

-
- A53 Joanna Orzel**, Chemistry and Spanish Major
Advisor(s): Stacey Lowery Bretz, Department of Chemistry and Biochemistry
Faculty Expectations for Meaningful Learning in the Undergraduate Chemistry Laboratory: How Do Students' Experiences Compare?
- A54 Annie Hause**, Psychology and Family Science and Social Work Major
Rebecca Wesseh, Psychology and Family Science and Social Work Major
Mercedes Obregon, Family Science and Social Work Major
Lillyanna Faimon, Psychology and Neuroscience Major
Rylan Moore, English Language Arts Education and Neuroscience Major
Advisor(s): Katherine Kuvalanka, Department of Family Science and Social Work
Chelsey Gates, Department of Family Science and Social Studies
*Trans*Kids Project: Sibling Relationships in Families With Trans Children*
- A55 Madison Jackson**, Zoology and Environmental Science Major
Advisor(s): Michael Vanni, Department of Biology
Tanner Williamson, Department of Biology
Seasonal Trends in Reservoir Denitrification Rates
- A56 Megan McBride**, Biology and Premedical Studies Major
Advisor(s): Michael Vanni, Department of Biology
Tanner Williamson, Department of Biology
Resilience of Eutrophic Aquatic Ecosystems to Storm Events
- A57 Wrik Chatterjee**, Geology and Biology Major
Advisor(s): Carrie Tyler, Department of Geology and Environmental Earth Science
Quantitative Analysis of Biotic Interactions with Echinoids
- A58 Mona-Mae Juwillie**, International Studies and Global Perspectives on Sustainability Major
Advisor(s): Jonathan Levy, Department of Geology and Environmental Earth Science
Creating Sustainable Clean Water Solutions in the Rural Villages of Ghana
- A59 Victoria Thompson**, Nutrition Major
Mickey Myers, Nutrition Major
Marla Guggenheimer, Nutrition Major
Denise Chan, Nutrition Major
Amy Skeels, Nutrition Major
Rachel Wyand, Nutrition Major
Aisha Fichtner, Nutrition Major
Advisor(s): Beth Miller, Department of Kinesiology and Health
Home Gardening: A Needs Assessment for a Gardening Program for Public Housing Residents
- A60 Hannah Robertson**, Biology and Premedical Studies Major
Advisor(s): Andor Kiss, Department of Microbiology
Molecular Characterization of Eye Lens Crystallins from Freeze Tolerant Wood Frog
- A61 Kris Horman**, Psychology Major
Advisor(s): Rose Marie Ward, Department of Kinesiology and Health
Are You That Happy to See Me, or Is It the Alcohol Talking? A Study of the Effects of Intimacy on Alcohol Consumption
- A62 Andrea Lee**, East Asian Languages and Cultures and Latin American, Latino/a, and Caribbean Studies Major
Advisor(s): Rose Marie Ward, Department of Kinesiology and Health
Correlating the Relationship between Personality Traits and Blacking Out Due to Alcohol Consumption
- A63 Dannie Roberts**, Kinesiology and Premedical Studies Major
Advisor(s): Rose Marie Ward, Department of Kinesiology and Health
Unusual Alcohol Consumption Methods and Risky Drinking

Poster Presentation Listing by Poster Number

SESSION A: 10:00 – 11:30 A.M.

JOHN DOLIBOIS ROOM

(See presenter index on pages 53 - 73)

- A64 Emily Wilson**, Biology Major
Advisor(s): Rose Marie Ward, Department of Kinesiology and Health
Exploring Alcohol Use in College Students
- A65 Josh Bradford**, Italian Studies Major
Advisor(s): Andrea Right, Department of French and Italian
Analyzing Tracking Narratives: Fitbit and Apple Watch
- A66 Carrie Helldoerfer**, Marketing Major
Opportunities in Appealing to Male Customers for Barefoot Wine
- A67 Sara Al-Zubi**, Management and Leadership and Premedical Studies Major
Sumedha Chakravarti, Business Economics and Information Systems Major
Advisor(s): Megan Gerhardt, Department of Management
Religious Bias in the Workplace
- A68 Trent Neubecker**, Accountancy and Marketing Major
Matt Diehl, Finance Major
Nate Sommerfield, Finance Major
Advisor(s): Megan Gerhardt, Department of Management
Perceptions about the Drinking Culture at Miami from Members of Miami Fraternities
- A69 Nicole Keshock**, Supply Chain and Operations Management and Comparative Media Studies Major
Advisor(s): Mack Hagood, Department of Media Journalism and Film
Netflix and Chill: A Cultural Investigation Regarding the New Identities Surrounding A Breakthrough Medium
- A70 Jayvon Howard**, Family Science and Social Work Major
Advisor(s): C. Lee Harrington, Department of Sociology and Gerontology
Talking Dick, Black Queer Masculinities and the Body: A Critical Auto-Ethnography
- A71 Kevin Summers**, Psychology and Premedical Studies Major
Advisor(s): Kurt Hugenberg, Department of Psychology
Paige LLOYD, Department of Psychology
The Effects of Target and Participant Gender on Deception Detection
- A72 Rachael Weesner**, Psychology and Neuroscience Major
Gabrielle Fernandez, Psychology and Premedical Studies Major
Eleanor Simmons, Psychology Major
Advisor(s): Kurt Hugenberg, Department of Psychology
Barefaced Beauty: Exposure to Other Women's Makeup Negatively Impacts Self-Esteem
- A73 Nick Fendinger**, English Professional Writing and Psychology Major
Kristin Mitchell, Psychology Major
Advisor(s): Kurt Hugenberg, Department of Psychology
Allen McConnell, Department of Psychology
Paige Lloyd, Department of Psychology
WHR and Sexism
- A74 Katherine Byrket**, Biology and Premedical Studies Major
Advisor(s): Elizabeth Kiel-Luebke, Department of Psychology
Anne Kalomiris, Department of Psychology
Error-Related Negativity and Social Anxiety in Kindergartners
- A75 Emily Ritchie**, Psychology Major
Advisor(s): Jonathan Kunstman, Department of Psychology
Christina Fitzpatrick, Department of Psychology
The Power of Labels: Differential Status Associations with African Americans and Black People

Poster Presentation Listing by Poster Number

SESSION A: 10:00 – 11:30 A.M.

JOHN DOLIBOIS ROOM

(See presenter index on pages 53 - 73)

- A76 Sierra Semko**, Psychology Major
Advisor(s): Jonathan Kunstman, Department of Psychology
Christina Fitzpatrick, Department of Psychology
Ryan Nicholls, Department of Psychology
Race Concerns Predict Academic and Health Outcomes for Students of Color
- A77 Alaina Swope**, Psychology and English Literature Major
Advisor(s): Aaron Luebbe, Department of Psychology
Kathryn Mancini, Department of Psychology
The Differential Influences of ADHD Symptoms and Sluggish Cognitive Tempo on Mother-Adolescent Emotional Flexibility
- A78 Carly Cooper**, Psychology Major
Advisor(s): Aaron Luebbe, Department of Psychology
Kathryn Mancini, Department of Psychology
Gender Differences in Mother-Adolescent Dyadic Affective Flexibility
- A79 Casey Gallagher**, Biochemistry Major
ADVISOR(S): Richard Taylor, Department of Chemistry and Biochemistry
Approaches to Bioconjugation of Heparin Using Click Chemistry
- A80 Andrew Pescovitz**, Nutrition and Kinesiology Major
Allison Feran, Nutrition Major
Advisor(s): Jennifer Pate, Department of Kinesiology and Health
Effect of Whey Protein Isolate and Inulin Powder on the Flavor and Texture of No-Fat Ice Cream
- A81 Ashley Miller**, Nutrition and Public Health Major
Abby Younce, Nutrition Major
Advisor(s): Jennifer Pate, Department of Kinesiology and Health
Acceptability of Baked Fries With and Without Oil
- A82 Mary Isenmann**, Nutrition and Public Health Major
Megan Rigot, Nutrition Major
Advisor(s): Jennifer Pate, Department of Kinesiology and Health
Substitution of Avocado Oil for Butter in Cookies
- A83 Lauren Hoover**, Nutrition Major
Jingwei Zhang, Nutrition Major
Advisor(s): Jennifer Pate, Department of Kinesiology and Health
Effect of Coconut Oil as Replacement for Butter in Chocolate Chip Cookies in Relation to Physical, Textural, and Sensory Attributes
- A84 Phillip Carr**, Nutrition and Kinesiology Major
Dolly Rinehart, Nutrition Major
Advisor(s): Jennifer Pate, Department of Kinesiology and Health
The Effect of Flour Types on the Consistency of Scones
- A85 Grace Petro**, Nutrition Major
Jess Bolton, Nutrition Major
Advisor(s): Jennifer Pate, Department of Kinesiology and Health
Sweetener Variations Influencing Custard
- A86 Sarah Ward**, Nutrition Major
Marisa Seitz, Nutrition Major
Advisor(s): Jennifer Pate, Department of Kinesiology and Health
Effects of Temperature on Perceived Sweetness of Mango-Peach Gelato
- A87 Hannah Merkle**, Nutrition Major
Rachel Keller, Nutrition Major
Advisor(s): Jennifer Pate, Department of Kinesiology and Health
What is the Best Lactose Free Alternative for Buttercream Frosting?

Poster Presentation Listing by Poster Number

SESSION A: 10:00 – 11:30 A.M.

JOHN DOLIBOIS ROOM

(See presenter index on pages 53 - 73)

- A88** **Ethan Hollingsworth**, Biology and Neuroscience Major
Shelby Lab, Psychology and Neuroscience Major
Angus Cady, Philosophy and Sustainability Major
Annastasia Babcock, Biology Major
Justin Heintz, Biomedical Engineering Major
Kelsey Demel, Diplomacy & Global Politics Major
Alexa Enders, Biology and Premedical Major
Rachel Hawkins, Chemistry and Microbiology Major
Carolina Garcia, Psychology and Neuroscience Major
Olivia Collins, Microbiology and Premedical Major
Lexi March, Speech Pathology and Audiology and Major
Advisor(s): Jennifer Quinn, Department of Psychology
Role of Orbitofrontal Cortex in Fear Memory Reconsolidation following an Expected Reactivation
- A89** **Ethan Hollingsworth**, Zoology and Neuroscience Major
Victoria Mordzinski, Biology and Premedical Studies Major
Katelyn Scheive, Psychology Major
Emily Pascoe, Psychology Major
Lauren Brady, Microbiology Major
Advisor(s): Jennifer Quinn, Department of Psychology
Daniel Kochli, Department of Psychology
Amnesic Manipulations Fail to Disrupt the Reconsolidation of Context Discrimination Fear Memories
- A90** **Shelby Lab**, Psychology and Neuroscience Major
Ethan Hollingsworth, Biology and Neuroscience Major
Jaylen Perkins, Biology and Premedical Major
Laney Naille, Biology and Neuroscience Major
Rebecca Willliam, Psychology and Neuroscience Major
Lili Scarlato, Microbiology and Premedical Major
Kelsey Woods, Nutrition and Premedical Major
Rachel Sullivan, Psychology and Computer Science Major
Molly McCudden, Chemical Engineering Major
Drew Schleicher, Biochemistry and Neuroscience Major
Danielle Ross, Psychology and Neuroscience Major
Advisor(s): Jennifer Quinn, Department of Psychology
Role of Orbitofrontal Cortex in Fear Memory Reconsolidation following an Unexpected Reactivation
- A91** **Briana Levikov**, Psychology and Premedical Studies Major
Advisor(s): Jennifer Quinn, Department of Psychology
Midazolam Has No Effect on Discrimination Fear Memory Reconsolidation in Adolescent Rats
- A92** **Mallory Myers**, Zoology and Neuroscience Major
Mallory Dunn, Zoology and Premedical Studies Major
Advisor(s): Jennifer Quinn, Department of Psychology
The Effect of Extinction on the Destabilization of an Overtrained Memory
- A93** **Lindsey States**, Mathematics Education and Mathematics Major
Advisor(s): Michael Todd Edwards, Teacher Education
Timing of Technology in the Classroom
- A94** **Kristina Taynor**, Zoology and Environmental Science Major
Advisor(s): David Berg, Department of Biology
Ashley Walters, Department of Biology
*Genetic Diversity in the Threatened Freshwater Mussel *Lampsilis powellii**

Poster Presentation Listing by Poster Number

SESSION A: 10:00 – 11:30 A.M.

JOHN DOLIBOIS ROOM

(See presenter index on pages 53 – 73)

- A95 Meredith Lloyd**, Chemical and Paper Engineering Major
Halle Miller, Chemical and Paper Engineering Major
Chris Hill, Chemical and Paper Engineering Major
Xin Dong, Chemical and Paper Engineering Major
Danika Whalen, Chemical and Paper Engineering Major
Advisor(s): Catherine Almquist, Department of Chemical, Paper and Biomedical Engineering
Justin Saul, Department of Chemical, Paper and Biomedical Engineering
Keratin-based Adsorbents for the Removal of Heavy Metals from Water
- A96 Emily Konrad**, Microbiology Major
Cole Goodrich, Microbiology Major
Jon Abell, Biology Major
Sydney Arlis, Biology Major
Annastasia Babcock, Biology Major
Allison Biedenharn, Microbiology Major
Amanda Burgess, Microbiology Major
Luke Carrafiello, Microbiology Major
Callen Conroy, Microbiology Major
Steven Madias, Biology Major
Cortney Mitchem, Microbiology Major
Paolo Palacios, Medical Laboratory Science Major
Julie Donna, Microbiology and Environmental Science Major
Steph Smith, Microbiology Major
Advisor(s): Luis Actis, Department of Microbiology
Mitchell Balish, Department of Microbiology
Rebecca Balish, Department of Microbiology
Mariah Squire, Department of Microbiology
Hailey Riggs, Department of Microbiology
Mystery DNA: A Three-Part Thriller Featuring Mycobacteriophage Clusters D, N, and A
- A97 Jamie Berray**, Nutrition and Public Health Major
Allison Henson, Nutrition Major
Advisor(s): Jennifer Pate, Department of Kinesiology and Health
Analyzing the Effect of Gluten-free Flours on Blueberry Muffins
- A98 Hannah Zerkle**, Zoology and Environmental Science Major
Advisor(s): Matthew McMurray, Department of Psychology
Danielle Tapp, Department of Psychology
Playing the Odds: Examining Decision Making Differences under Restricted Resources
- A99 Gabrielle Fernandez**, Psychology and Premedical Studies Major
Ellee Raker, Psychology Major
Francesca Sciacotta, Psychology and Biology Major
Advisor(s): Barbara Oswald, Department of Psychology
The Effects of Stimulant Drugs on Alcohol Self-Administration, Motor Coordination, and Novel Object Recognition in C57BL/6J Mice
- A100 Cody O'Donnell**, Kinesiology Major
Advisor(s): Barbara Oswald, Department of Psychology
Effects of Anabolic Steroid Use on Emotion
- A101 Sarah Wohl**, Biology and Environmental Science Major
Meghan Jones, Geography Major
Brooke Ecklar, Zoology and Environmental Science Major
Annie O'Brien, Finance and Accountancy Major
Noah Miller, Economics and Accountancy Major
Landen Stair, Finance Major
Tim Supeck, Economics Major
Austin Rust, English Creative Writing Major
Nicholas Brown, Geography Major
Brandon Street, Geography Major
Advisor(s): Jerry Green, Department of Geography
Evaluation of Pepper Park Landscape Site Characteristics

Poster Presentation Listing by Poster Number

SESSION A: 10:00 – 11:30 A.M.

JOHN DOLIBOIS ROOM

(See presenter index on pages 53 - 73)

A102 Jack Gruber, Zoology Major

Denae Garcia, Zoology Major

Caroline Kennedy, Biology Major

Advisor(s): Susan Hoffman, Department of Biology

*The Effects of Natural Bottlenecking on the Genetic
Diversity of Peromyscus leucopus in Michigan's
Lower Peninsula*

A103 Kyle Weaver, Mechanical Engineering and
Biochemistry Major

Advisor(s): Jeong-Hoi Koo, Department of

Mechanical and Manufacturing Engineering

*Indentation Testing of Artificial Skin Samples Based
on Magnetically-Active Elastomers*

A104 David Colston, Anthropology and Public
Administration Major

Advisor(s): Paul Flaspohler, Department

of Psychology

The Role of Government in Public Health

A105 Nick Baxter, Geology Major

Advisor(s): Mike Brudzinski, Department of Geology
and Environmental Earth Science

*Characterizing Hydraulic Fracturing Induced
Seismicity on a Network of Pre-Existing Faults in
Harrison County, Eastern Ohio*

A106 Stephanie Raudenbush, Athletic Training Major

Advisor(s): Eric Brooks, Department of Kinesiology
and Health

Triple Ipsilateral ACL Tear in Division I Softball Player

Poster Presentation Listing by Poster Number

SESSION B: 1:30 – 2:45 P.M.

SHRIVER LOBBY

(See presenter index on pages 53 - 73)

B01L Brandi McConahay, Anthropology and Interactive Media Studies Major
Advisor(s): Jeb Card, Department of Anthropology
Archaeological Pedagogy

B02L Amanda Burke, International Studies Major
Caitlin McElligott, Anthropology Major
Alexander Polinsky, Business Economics Major
Rachel Silber, Public Health Major
My Story
Zaheer Choudhury, Microbiology and Premedical Studies Major
Grace Hamilton, Business Economics Major
John Karikas, Biology and Premedical Studies Major
Lindsey Schad, Botany Major
"What Do You See When You See Me"
David Colston, Public Administration and Anthropology Major
Amber Henderson, Marketing Major
Reeti Pal, Zoology and Premedical Studies Major
Chanell Upshaw, Microbiology and Premedical Studies Major
My War, My Fight
Savannah Boerger, Zoology Major
Mona-Mar Juwillie, International Studies Major
Andrew Racadio, Biology Major
Rachel Serafin, Chemistry and Premedical Studies Major
"Still I Rise"
Advisor(s): Cameron Hay-Rollins, Department of Anthropology
Ann Elizabeth Armstrong, Department of Theatre
Digital Storytelling as Part of a Community Based Research Project: A Global Health Seminar

B03L Lindsey Schad, Botany Major
Advisor(s): Cameron Hay-Rollins, Department of Anthropology
Community-based Approaches to Alleviating Depression Among the Elderly in Rural India

B04L Lindsey Schad, Botany Major
Advisor(s): Cameron Hay-Rollins, Department of Anthropology
Emerging Adult Healthcare Decision Making: A Student Response to Mumps Cases at Miami University

B05L Lauren Antle, Anthropology Major
Lyric Melendez, Psychology and Neuroscience Major
Zachary Capretta, Psychology Major
Terry Reid, Psychology Major
Advisor(s): Joseph Johnson Department of Psychology
The Effects of Group Studying vs. Individual Studying

B06L Miranda Oates, Anthropology and Forensic Science Major
Advisor(s): Jeb Card, Department of Anthropology
Analysis of Unprepared and Prepared Human Osteological Collections: Assessment for Forensic Anthropology Teaching

B07L Miranda Oates, Anthropology and Forensic Science Major
Paulina Campos, Mathematics and Statistics Major
Grace Haring, Psychology Major
Advisor(s): Joseph Johnson, Department of Psychology
Understanding Sociosexual Habits of College Students

B08L Nathaniel Liesch, Architecture Major
Advisor(s): Murali Paranandi, Department of Architecture
Ghana Design+Build Performance Analysis

Poster Presentation Listing by Poster Number

SESSION B: 1:30 – 2:45 P.M.

JOHN DOLIBOIS ROOM

(See presenter index on pages 53 - 73)

- B01 Zoe Bolen**, Microbiology Major
Advisor(s): D.J. Ferguson, Department of Microbiology
Jeff Ringiesn, Department of Microbiology
Examination of a Putative Methyltransferase from the Quaternary Amine Degrading Methanogen Methanococcoides methylutens Strain Q3c
- B02 Nathan Burns**, Biochemistry Major
Advisor(s): Katia Del Rio-Tsonis, Department of Biology
The Role of miRNAs in Chick Retina Regeneration
- B03 Ethan DeVillez**, Biology Major
Advisor(s): David Berg, Department of Biology
Steven Hein, Department of Biology
Ashley Walters, Department of Biology
Identification of Sphaeriid Clam Populations in the Chihuahuan Desert
- B04 Kayla Bergmann**, Biology Major
Clay Curts, Biology Major
Meghan Bowers, Microbiology Major
Advisor(s): Joyce Fernandes, Department of Biology
Aswati Subramanian, Department of Biology
Remodeling of Drosophila Peripheral Nerve Ensheatment During Metamorphosis
- B05 Julia Behrend**, Biology Major
Advisor(s): Susan Hoffman, Department of Biology
Joseph Baumgartner, Department of Biology
Environmental Effects on Peromyscus leucopus Populations
- B06 Gil Phillips**, Biology Major
Connor Hueslman, Biology Major
Advisor(s): Susan Hoffman, Department of Biology
Jeremy Papuga, Department of Biology
Changes in Genetic Variability of Peromyscus maniculatus gracilis and Peromyscus leucopus noveboracensis in Northern Michigan over a Decade
- B07 Morgan Amigo**, Zoology Major
Advisor(s): Paul James, Department of Biology
Joe Powers, Department of Biology
Molecular and Functional Characterization of Mouse Na⁺/H⁺ exchanger 11 (NHE11): a Role in Male Reproduction?
- B08 James Lichter**, Biology Major
Advisor(s): Brian Keane, Department of Biology
Nancy Solomon, Department of Biology
Examining Male Sires of Unpaired Female Prairie Voles (Microtus ochrogaster) Using Microsatellite Markers
- B09 Carsen Cash**, Chemical and Paper Engineering Major
Kayla Thompson, Chemical and Paper Engineering Major
Advisor(s): Jason Berberich, Department of Chemical, Paper and Biomedical Engineering
Jake Stapleton, Chemical, Paper and Biomedical Engineering
Synthesis and Exploration of Protein-Polymer Conjugates
- B10 Katherine Sieman**, Biology and Premedical Studies Major
Advisor(s): Carole Dabney-Smith, Department of Chemistry and Biochemistry
Christopher Makaroff, Department of Chemistry and Biochemistry
Katie Eudy, Department of Chemistry and Biochemistry
Over-expression and Purification of Male Meiocyte Death-Like Proteins (MMDL-1 and MMDL-2)
- B11 Tori Seto**, Chemistry Major
Advisor(s): Benjamin Gung, Department of Chemistry and Biochemistry
Ruoyu Ma, Department of Chemistry and Biochemistry
Synthesis and Testing of Novel NHC-Au(I) Catalysis with Adamantyl Groups
- B12 Connor Henry**, Chemistry Major
Advisor(s): Scott Hartley, Department of Chemistry and Biochemistry
Synthesis of Thioether-Substituted Sanidic Liquid Crystals
- B13 Rathiesh Pandian**, Chemistry Major
Advisor(s): Scott Hartley, Department of Chemistry and Biochemistry
Gopi Nath Vemuri, Department of Chemistry and Biochemistry
Analysis of Handedness of ortho-Phenylenes

Poster Presentation Listing by Poster Number

SESSION B: 1:30 – 2:45 P.M.

JOHN DOLIBOIS ROOM

(See presenter index on pages 53 - 73)

- B14 Brian Long**, Chemistry Major
Advisor(s): Michael Kennedy, Department of Chemistry and Biochemistry
Shenyuan Xu, Department of Chemistry and Biochemistry
GTP Hydrolysis Restoration in K-Ras Mutants Using Engineered GAP
- B15 Aaron Simoni**, Microbiology Major
Advisor(s): Christopher Makaroff, Department of Chemistry and Biochemistry
A Natural Antisense RNA Plays an Important Role in Arabidopsis thaliana Growth and Development
- B16 Alexandra Glinos**, Spanish and Premedical Studies Major
Advisor(s): Stacey Lowery Bretz, Department of Chemistry and Biochemistry
Gregory Allen, Department of Chemistry and Biochemistry
Investigating General Chemistry Students' Misconceptions and Confidence Regarding Acid/Base Reactions
- B17 Rachel Serafin**, Chemistry and Premedical Studies Major
Advisor(s): Gary Lorigan, Department of Chemistry and Biochemistry
Daniel Drew, Department of Chemistry and Biochemistry
Probing the Secondary Structure of the S21 Pinholin Using Pulseed EPR ESEEM
- B18 Nick Frantz**, Biochemistry and Spanish Major
Tessa Wadsworth, Chemistry and Premedical Studies Major
Advisor(s): Gary Lorigan, Department of Chemistry and Biochemistry
Andrew Craig, Department of Chemistry and Biochemistry
Gunjan Dixit, Department of Chemistry and Biochemistry
Studying KCNQ1 Structure and Dynamics Using Electron Paramagnetic Resonance (EPR) Spectroscopy
- B19 Adam Rivers**, Biochemistry Major
Advisor(s): Michael Kennedy, Department of Chemistry and Biochemistry
Michelle Veite, Department of Chemistry and Biochemistry
Transgenic Mouse Model for the Early Detection of Pancreatic Cancer
- B20 Silvi Bajrami**, Biology and Premedical Studies Major
Advisor(s): Michael Robinson, Department of Biology
Creating a Fluorescent Detection System for Photoreceptor Differentiation from Mouse Embryonic Stem Cells via CRISPR/Cas9
- B21 Elaine Sidler**, Biology and Neuroscience Major
Advisor(s): Michael Robinson, Department of Biology
Stephanie Padula, Department of Biology
Analysis of FGFR and PTEN Interaction in Lens Development
- B22 Haley Boardman**, Chemistry Major
Collin Mullet, Biochemistry Major
Jacob Flum, Chemistry Major
Mara Viterisi, Chemistry and Premedical Studies Major
Olivia Rizzo, Biochemistry and Premedical Studies Major
Advisor(s): Michael Crowder, Department of Chemistry and Biochemistry
Climate Change and Its Effect on the Food Industry Relating to Meat, Fish, and Corn
- B23 Nicole Spellacy**, Chemistry Major
Gregory Kuznieski, Chemistry and Premedical Studies Major
Alec Krienon, Biochemistry Major
Gabriel Boris, Chemistry and Music Major
Nick Groth, Chemistry Major
Advisor(s): Michael Crowder, Department of Chemistry and Biochemistry
Climate Change

Poster Presentation Listing by Poster Number

SESSION B: 1:30 – 2:45 P.M.

JOHN DOLIBOIS ROOM

(See presenter index on pages 53 - 73)

- B24 Alexandra Statczar**, Chemistry Major
Thomas Schlueter, Chemistry Major
Tian Feng, Chemistry Major
Daniel Bussell, Chemistry Major
Emily Sullivan, Chemistry Major
Advisor(s): Michael Crowder, Department of Chemistry and Biochemistry
CHM 191 Zyth and Zym
- B25 Samantha Gawrys**, Biology and Spanish Major
Ben Gilbert, Biology Major
Advisor(s): Michael Robinson, Department of Biology
Peipei Qi, Department of Biology
Loss of miRNA26 Causes Post-natal Cataracts in Mice
- B26 Anna Porter**, Biology Major
Advisor(s): Michael Robinson, Department of Biology
Phuong Lam, Department of Biology
Creating Mouse Eye Cup Cell Cultures with RPE Lineage Tracing
- B27 Savannah Boerger**, Zoology Major
Advisor(s): David Russell, Department of Biology
Habitat Value of Hueston Woods State Park for Migrant Passerines of Contrasting Diet Type
- B28 Sabato Sorice**, Business Economics and Premedical Studies Major
Advisor(s): David Russell, Department of Biology
Tracking the Oriole Bird
- B29 Ashton Hall**, Microbiology and Premedical Studies Major
Advisor(s): Ann Rypstra, Department of Biology
Sex-Specific Starvation-Induced Cannibalism
- B30 Megan Hansen**, Biology and Premedical Studies Major
Erica Edwards, Economics Major
Vedha Nayak, Economics Major
Advisor(s): Joseph Johnson, Department of Psychology
Financial Risks in College Students
- B31 Hannah Caroscio**, Chemical and Paper Engineering Major
Hannah Caudill, Psychology Major
Maddie Black, Psychology Major
Kayla Elstien, Biology Major
Advisor(s): Joseph Johnson, Department of Psychology
Richard Smith, Department of Psychology
Effects of Caffeine on Higher Cognitive Tasks
- B32 Athena Chapekis**, Sociology Major
Francessca Gallowan, Diplomacy and Global Politics and Latin American, Latino/a, and Caribbean Studies Major
Emily Myers, Psychology Major
Juliana Rizzo, Psychology and Spanish Major
Advisor(s): Joseph Johnson, Department of Psychology
Participation in the Foreign Language Classroom
- B33 Sanchit Ram Arvind**, Mathematics and Statistics and Quantitative Economics Major
Advisor(s): Tatjana Miljkovic, Department of Statistics
Modeling Extreme Losses Using Generalized Pareto Distributions
- B34 Nicklaus Roach**, Mathematics and Statistics Major
Cristie Margerum, Mathematics and Statistics Major
Advisor(s): Tatjana Miljkovic, Department of Statistics
Modeling Job Satisfaction in Southern Ohio
- B35 Mackenzie Trevethan**, Psychology Major
Violette Hosey, Psychology and Premedical Studies Major
Grace Melanson, Psychology Major
Advisor(s): Joseph Johnson, Department of Psychology
Interoception and Objective Stress

Poster Presentation Listing by Poster Number

SESSION B: 1:30 – 2:45 P.M.

JOHN DOLIBOIS ROOM

(See presenter index on pages 53 - 73)

B36 Steven McPherson, Chemical Engineering Major

Alexandra Contestable, Psychology and Neuroscience Major

Lauren Poythress, Psychology and Black World Studies Major

Morgan Schroeder, Biology and Premedical Studies Major

Advisor(s): Joseph Johnson, Department of Psychology

Response Dynamics in Implicit Racial Bias in Real World Scenarios

B37 Spencer Milligan, Mechanical Engineering Major

Kirsten Fehlan, Psychology Major

Advisor(s): Joseph Johnson, Department of Psychology

Relations Between Academic Factors and Social and Illegal Risks

B38 Rita Kou, Speech Pathology and Audiology Major

Samantha Becker, Speech Pathology and Audiology Major

Olivia Wnek, Speech Pathology and Audiology Major

Advisor(s): Donna Scarborough, Department of Speech Pathology and Audiology

Michael Bailey-Van Kuren, Department of Mechanical and Manufacturing Engineering

Taylor Creech, Department of Speech Pathology and Audiology

Training Cup Prototype: Varied Viscosity Model

B39 Samantha Becker, Speech Pathology and Audiology Major

Audiology Major

Rita Kou, Speech Pathology and Audiology Major

Olivia Wnek, Speech Pathology and Audiology Major

Advisor(s): Donna Scarborough, Department of Speech Pathology and Audiology

Michael Bailey-Van Kuren, Department of Mechanical and Manufacturing Engineering

Taylor Creech, Department of Speech Pathology and Audiology

A Comparison of Measurements of a Pediatric Supplement: How Thin is Thin?

B40 Joslyn Andrews, Business Economics and Marketing Major

Caitlin Sifuentes, Business Economics Major

Advisor(s): Megan Gerhardt, Department of Management

How to Change Culture: A Case Study of Miami University Greek Life

B41 Tyler Latch, Finance Major

Chad Goss, Finance Major

Ethan Retcher, Finance and Accountancy Major

Advisor(s): Megan Gerhardt, Department of Management

Exploring the Drivers and Trends of Engagement and Perceived Value

B42 Samantha Youngwirth, Business Economics and Finance Major

Finance Major

Lauren Nobile, Finance Major

Blake Cortez, Marketing and Spanish Major

Advisor(s): Megan Gerhardt, Department of Management

Gender Bias in the Workplace

B43 Meena Bansal, Biology Major

Abigail Brown, Biology Major

Advisor(s): Janet Marshall, Department of Chemistry and Biochemistry

Howard Vail, Department of Chemistry and Biochemistry

Organic Chemistry Lab Development: Fischer Esterification Utilizing Benchtop NMR

B44 Dillon Frank, Life Science - Chemistry Education Major

Nicholas Spurgus, Biology and Premedical Studies Major

Advisor(s): Ellen Yeziarski, Department of Chemistry and Biochemistry

Justin Pratt, Department of Chemistry and Biochemistry

Documenting Chemistry Teacher Growth: Changing Descriptions of Symbolic, Macroscopic, and Particulate Levels During Inquiry-Focused Professional Development

Poster Presentation Listing by Poster Number

SESSION B: 1:30 – 2:45 P.M.

JOHN DOLIBOIS ROOM

(See presenter index on pages 53 - 73)

- B45 David Black**, Information Systems Major
Jackie Challoner, Marketing Major
Madison Cain, Business Economics and East Asian Languages and Cultures Major
Emma Reed, Accountancy Major
Advisor(s): Megan Gerhardt, Department of Management
Implicit Biases in Business Organization Affiliation
- B46 Micaela Wexler**, Finance Major
Leah Sprock, Marketing Major
Danny Molloy, Finance Major
Advisor(s): Megan Gerhardt, Department of Management
Attitudes on Disabilities and Accommodations in Professional and Academic Settings
- B47 Emma Geary**, Psychology and English Professional Writing Major
Advisor(s): Keisha Wagers, Department of Psychology
Parenting, Empathy and Externalizing Behaviors
- B48 Robert Poth**, Biochemistry and Premedical Studies Major
Advisor(s): Richard Page, Department of Chemistry and Biochemistry
Jamie VanPelt, Department of Chemistry and Biochemistry
Structural Characterization of Metallo-Beta Lactamases and Optimization of Novel Small Molecule Inhibitors
- B49 Brianna Minshall**, Psychology and Neuroscience Major
Advisor(s): Ellen Yezierski, Department of Chemistry and Biochemistry
Jorge Torres, Department of Chemistry and Biochemistry
Learning in the Moment: Identifying and Improving Student Conceptual Knowledge Construction in General Chemistry
- B50 Madison Cappas**, Middle Childhood Education Major
Ellie Stillman, Middle Childhood Education Major
Emily Culberson, Middle Childhood Education Major
Mikala Popovec, Middle Childhood Education Major
Britt Hochstetler, Middle Childhood Education e Major
Advisor(s): Michael Todd Edwards, Department of Teacher Education
Artistically Replicating Miami University Landmarks using Geometric Software
- B51 Chloe Dabrowski**, Middle Childhood Education Major
Jade Taylor, Middle Childhood Education Major
Meredith Schmitt, Middle Childhood Education Major
Brandon Stradling, Middle Childhood Education Major
Advisor(s): Michael Todd Edwards, Department of Teacher Education
Geometric Modeling of Everyday Objects using Mathematics Software
- B52 Paige Osterwisch**, Middle Childhood Education Major
Kelsey Borgarding, Middle Childhood Education and Anthropology Major
Erika Nisbet, Middle Childhood Education Major
Corey Manning, Middle Childhood Education Major
Advisor(s): Michael Todd Edwards, Department of Teacher Education
Real Life Interpretations of Coding
- B53 Craig Hanson**, Engineering Management and Manufacturing Engineering Major
Advisor(s): Muhammad Jahan, Department of Mechanical and Manufacturing Engineering
Investigating Tool Wear and Surface Finish in the Machining of Titanium Alloy
- B54 Alex Mazursky**, Mechanical Engineering and Energy Major
Advisor(s): Jeong-Hoi Koo, Department of Mechanical and Manufacturing Engineering
Design and Performance Evaluation of a Miniature Haptic Actuator based on Electrorheological Fluid

Poster Presentation Listing by Poster Number

SESSION B: 1:30 – 2:45 P.M.

JOHN DOLIBOIS ROOM

(See presenter index on pages 53 - 73)

- B55 Nicholas Vrzal**, Middle Childhood Education Major
Matthew Sheely, Middle Childhood Education Major
Kaleb Gauvey, Middle Childhood Education Major
Advisor(s): Michael Todd Edwards, Department of Teacher Education
Simplicity: The Artistic Ability of Mathematics and Technology
- B56 Carley Taggart**, Middle Childhood Education Major
Brooke Skelly, Middle Childhood Education Major
Hannah Lentz, Middle Childhood Education Major
Samantha Black, Middle Childhood Education Major
Advisor(s): Michael Todd Edwards, Department of Teacher Education
Art Recreation in Primary and Secondary Education Using Online Software
- B57 Kailee Colter**, Psychology Major
Advisor(s): Alexandria Intorcio, Department of Psychology
Social Influences of College Organizations: The Effects of Conformity on Self Esteem
- B58 Virginia Hollatz**, Psychology Major
Advisor(s): Yvette Harris, Department of Psychology
Seham Almutairi, Department of Psychology
Exploring the Use of Digital Technology in the Lives of Homeschooled Children
- B59 Aldiyar Kenes**, Mechanical Engineering Major
Advisor(s): James Moller, Department of Mechanical and Manufacturing Engineering
Investigation of Water Properties by Atomistic Simulation
- B60 John Germano**, Psychology Major
Advisor(s): Kurt Hugenberg, Department of Psychology
Allen McConnell, Department of Psychology
Paige Lloyd, Department of Psychology
Don't Lie to Me: Social Exclusion Influences the Ability to Detect Lies
- B61 Robert White**, Biology and Psychology Major
Austin Nader, Psychology and Neuroscience Major
Jack Frankel, Psychology and Premedical Studies Major
Advisor(s): Anna Radke, Department of Psychology
Aversion-resistant Alcohol Drinking in Male and Female Mice
- B62 Victoria Colvin**, Psychology Major
Emily Blumenthal, Psychology Major
Luke Evans, Psychology Major
Caitlyn Jones, Psychology Major
Tyler Schumacher, Psychology Major
Jessica Shields, Psychology Major
Advisor(s): Kurt Hugenberg, Department of Psychology
Jonathan Kunstman, Department of Psychology
Steven Almaraz, Department of Psychology
Jason Deska, Department of Psychology
The Effects of Face Inversion on Attention to the Eyes and the Desire to Interact Depend on Target Race
- B63 Reeti Pal**, Zoology and Premedical Studies Major
Advisor(s): Paul Flaspohler, Department of Psychology
Model to Decrease Malnutrition due to Food Insecurity
- B64 Megan Perry**, Psychology Major
Advisor(s): Elizabeth Kiel-Luebbe, Department of Psychology
The Role of Fearful Temperament and Maternal Control Behavior on the Development of Self-Consciousness in Toddlerhood
- B65 Kevin Summers**, Psychology and Premedical Studies Major
Advisor(s): Kurt Hugenberg, Department of Psychology
Steven Almaraz, Department of Psychology
Do You Trust Me? Trustworthiness and Dominance Cues Lie in Separate Regions of the Face
- B66 Maggie Winstel**, Psychology and Sustainability Major
Advisor(s): Amanda Diekman, Department of Psychology
Tessa Benson-Greenwald, Department of Psychology
Aimee Belanger, Department of Psychology
Proactive Personality and Satisfaction in STEM Fields

Poster Presentation Listing by Poster Number

SESSION B: 1:30 – 2:45 P.M.

JOHN DOLIBOIS ROOM

(See presenter index on pages 53 - 73)

- B67 Madeline Lundin**, Psychology Major
Advisor(s): Kurt Hugenberg, Department of Psychology
Jason Deska, Department of Psychology
Facial Width-to-Height Ratio Biases Job Selection
- B68 Grace Campe**, Psychology Major
Katie Kowalski, Psychology Major
Advisor(s): Amanda Diekman, Department of Psychology
Tessa Benson-Greenwald, Department of Psychology
Melissa Fuesting, Department of Psychology
Reactions to Mistakes
- B69 In Hong Lei**, Public Administration Major
Advisor(s): Mark Morris, Department of Political Science
Should Government Intervene in the Economy During Economic Recession?
- B70 Chanell Upshaw**, Microbiology and Premedical Studies Major
Advisor(s): Paul Flaspohler, Department of Psychology
Best Buds: Regulations on Marijuana Use and Possession between the Netherlands versus the United States
- B71 Ashley Albin**, Nursing Major
Courtney Strassburger, Nursing Major
Oliva Bowley, Nursing Major
MacKenzie Hickman, Nursing Major
Samantha Davis, Nursing Major
Advisor(s): Eyad Musallam, Department of Nursing
Interventions to Prevent UTI's in the ICU
- B72 Katy Alley**, Nursing Major
Christian McLaughlin, Nursing Major
Elizabeth Ingram, Nursing Major
Trevor Shelton, Nursing Major
Kaela Ghent, Nursing Major
Advisor(s): Eyad Musallam, Department of Nursing
The Effectiveness of Using Turn Teams to Prevent Pressure Ulcers
- B73 Brittany Goad**, Nursing Major
Claire Uwingeneye, Nursing Major
Eulalia Lopez Gonzalez, Nursing Major
Maria Lopez Gonzalez, Nursing Major
Patricia Koranteng, Nursing Major
Advisor(s): Eyad Musallam, Department of Nursing
Using Technological Reminders to Improve Compliance among Mental Health Patients: An Evidence-based Paper
- B74 Megan Knight**, Nursing Major
Corrie Patrick, Nursing Major
Allison Millhouse, Nursing Major
Morgan Heck, Nursing Major
Carrie Bartels, Nursing Major
Advisor(s): Eyad Musallam, Department of Nursing
Power of CAM
- B75 Lulu Abdun**, Psychology Major
Advisor(s): Vaishali Raval, Department of Psychology
Timothy Ovia, Department of Psychology
Public Discourses About Race in the United States
- B76 Le'Andra Wilson**, Nursing Major
Maria Pena-Lopez, Nursing Major
Ling Lin, Nursing Major
Samantha Short, Nursing Major
Kayla Ball, Nursing Major
Advisor(s): Eyad Musallam, Department of Nursing
The Efficacy of Sex Education Programs in Promoting Safer Sex Practices among Teens in USA
- B77 Tisa Williams**, Nursing Major
Dale Richter, Nursing Major
Kristen Davis, Nursing Major
Danielle Hale, Nursing Major
Kamari Blair, Nursing Major
Advisor(s): Eyad Musallam, Department of Nursing
Comprehensive Sex Education

Poster Presentation Listing by Poster Number

SESSION B: 1:30 – 2:45 P.M.

JOHN DOLIBOIS ROOM

(See presenter index on pages 53 - 73)

- B78** **Bridget Martin**, Nursing Major
Kimberly Richardson, Nursing Major
Brittany Chasteen, Nursing Major
Kaitlin Ball, Nursing Major
Brittney Wasson, Nursing Major
Advisor(s): Eyad Musallam, Department of Nursing
Reducing Alcohol Use Among College Students Through On-Campus Interventions
- B79** **Taylor Lambert**, Nursing Major
Ashley Selby, Nursing Major
Benjamin Proud, Nursing Major
Brook Dietz, Nursing Major
Ashley King, Nursing Major
Advisor(s): Eyad Musallam, Department of Nursing
Does the Use of Simulation as an Educational Tool Improve Undergraduate Nursing Students Knowledge and Skills?
- B80** **Jennifer Rub**, Microbiology Major
Kathy Everson, Microbiology Major
Advisor(s): Rachael Morgan-Kiss, Department of Microbiology
SEA Miami: Day-and-Night Prokaryotic Diversity in the Caribbean
- B81** **Jessica Simon**, Microbiology Major
Ciara Lawson, Microbiology Major
Thatcher Creber, Biology Major
Advisor(s): Rachael Morgan-Kiss, Department of Microbiology
SEA Miami: Microorganism Biodiversity and Nutrient Availability Near Populated Shorelines
- B82** **Krystina Hird**, Biochemistry and Botany Major
Advisor(s): Carole Dabney-Smith, Department of Chemistry and Biochemistry
C. Paul New, Department of Chemistry and Biochemistry
The Role of the Transmembrane Glutamate in Assembly of the Chloroplast Twin Arginine Transport Pathway Component Tha4
- B83** **Natalie Briggs**, Nutrition Major
Nikki Finkenthal, Nutrition Major
Advisor(s): Jennifer Pate, Department of Kinesiology and Health
The Effect of Fat Substitutes in Chocolate Cake
- B84** **Madeline Engelking**, Nutrition Major
Amy Shomo, Nutrition Major
Advisor(s): Jennifer Pate, Department of Kinesiology and Health
The Effect of Black Beans as a Flour Substitute in Brownies
- B85** **Allyson McArthur**, Nutrition Major
Clare Howard, Nutrition Major
Advisor(s): Jennifer Pate, Department of Kinesiology and Health
The Impact of Gluten In Baking
- B86** **Sarah Wyand**, Nutrition and Premedical Studies Major
Advisor(s): Rose Marie Ward, Department of Kinesiology and Health
Are College Students Playing Hard So That They Can Drink Harder?
- B87** **Joshua Trimboli**, Biology Major
Rachel Frankhauser, Biology and Sustainability Major
Jack Haught, Economics and Supply Chain and Operations Management Major
Advisor(s): Rachael Morgan-Kiss, Department of Microbiology
SEA Miami: Chlorophyll A at a 1% PAR
- B88** **Sarah Wilson**, Microbiology Major
Kayla Brown, Microbiology Major
Advisor(s): Rachael Morgan-Kiss, Department of Microbiology
SEA Miami: Alpha and Beta Diversity In Water Column Surrounding Puerto Rico
- B89** **Keiko Wilkins**, Biology Major
Koby Schneider, Mechanical Engineering Major
Trevor Holm, Biology Major
Advisor(s): Rachael Morgan-Kiss Department of Microbiology
SEA Miami: Factors Affecting Zooplankton Biodensity and Diversity in the Coastal and Open Waters around Puerto Rico

Poster Presentation Listing by Poster Number

SESSION B: 1:30 – 2:45 P.M.

JOHN DOLIBOIS ROOM

(See presenter index on pages 53 - 73)

- B90 Keiko Wilkins**, Biology Major
Sarah Hiner, Medical Laboratory Science and Microbiology Major
Advisor(s): Rachael Morgan-Kiss, Department of Microbiology
SEA Miami: The Diversity of Photosynthetic and Heterotrophic Microorganisms in a Transect of San Juan Harbor
- B91 Keiko Wilkins**, Biology Major
Advisor(s): Craig Williamson, Department of Biology
The Effects of Oxygen Depletion on Abundance and Vertical Distribution of Calanoid Copepods, Daphnia and Cyclopoid Copepods
- B92 Abigail Weiland**, Athletic Training Major
Advisor(s): Eric Brooks, Department of Kinesiology and Health
Lumbar Facet Syndrome in a Synchronized Skater
- B93 Netanya Lane**, Political Science Major
Advisor(s): Rodney Coates, Department of Black World Studies Program
Social Construct of Black Women
- B94 Bethany Strauss**, Social Work Major
Advisor(s): Leah Wasburn-Moses, Department of Educational Psychology
Foster Care, Kinship Care, and Adoption Preservice Training Youth Version
- B95 Allie Shea**, Psychology Major
Advisor(s): Virginia Wickline, Department of Psychology
Intercultural Competence
- B96 Emily Konrad**, Microbiology Major
Cole Goodrich, Microbiology Major
Jon Abell, Biology Major
Sydney Arlis, Biology Major
Annastasia Babcock, Biology Major
Allison Biedenharn, Microbiology Major
Amanda Burgess, Microbiology Major
Luke Carrafiello, Microbiology Major
Callen Conroy, Microbiology Major
Steven Madias, Biology Major
Cortney Mitchem, Microbiology Major
Paolo Palacios, Medical Laboratory Science Major
Julie Donna, Microbiology and Environmental Science Major
Steph Smith, Microbiology Major
Advisor(s): Luis Actis, Department of Microbiology
Mitchell Balish, Department of Microbiology
Rebecca Balish, Department of Microbiology
Mariah Squire, Department of Microbiology
Hailey Riggs, Department of Microbiology
Mystery DNA: A Three-Part Thriller Featuring Mycobacteriophage Clusters D, N, and A
- B97 Natalia Kellamis**, Chemistry Education Major
Advisor(s): Ellen Yezierski, Department of Chemistry and Biochemistry
From NSES to NGSS: How to Evaluate and Respond to Changing Curricula in High School Chemistry
- B98 Thomas Farnbacher**, Microbiology Major
Erin McGovern, Kinesiology Major
Advisor(s): Li Zhou, Department of Psychology
How Individuals Differentiate in Proactive Interference Inhibition
- B99 Kyle Schulte**, Biochemistry and Neuroscience Major
Advisor(s): Robin Thomas, Department of Psychology
Audrey Weil, Department of Psychology
Individual Differences in Working Memory and Belief Bias Reflected in Fronto-Parietal Coherence

Poster Presentation Listing by Poster Number

SESSION B: 1:30 – 2:45 P.M.

JOHN DOLIBOIS ROOM

(See presenter index on pages 53 - 73)

B100 Hannah Kempf, Geology Major

Advisor(s): Carrie Tyler, Department of Geology and Environmental Earth Science
Using Food Webs to Examine Ecosystem Dynamics during Biotic Invasions in Late Ordovician Shallow Communities

B101 Benjamin Jackson, Electrical Engineering and Energy Major

Bailey Hall, Electrical Engineering Major
Kyle Smith, Electrical Engineering Major
Advisor(s): Mark Scott, Department of Electrical and Computer Engineering
Design and Optimization of a Portable, Off-Grid Photovoltaic Energy System for an Irrigation System

B102 Max Leveridge, Environmental Earth Science and Environmental Science Major

Advisor(s): Mike Brudzinski, Department of Geology and Environmental Earth Science
Improved Seismological and Geological Characterization of Seismicity Induced by Wastewater Disposal Near Marietta, Ohio

B103 Rebeca Garcia De Jesus, Physics and French Major

Kon Grewal, Kinesiology and Premedical Studies Major
Danielle Lott, Psychology and Neuroscience Major
Juliana Rizzo, Psychology and Spanish Major
Advisor(s): Vrinda Kalia, Department of Psychology
Karthik Vishwanath, Department of Physics
Utilizing FNIRS as a Marker to identify Risk Taking in Males Post Stress Induction

B104 Mason Tate, Biochemistry Major

Jayeola Apapa, Biochemistry Major
Allison Peguero, Biochemistry and Neuroscience Major
Eric Timmons, Biochemistry Major
Kendall Smith, Chemistry Major
Advisor(s): Michael Crowder, Department of Chemistry and Biochemistry
Antibiotic Resistance

B105 Rachel Polak, Biochemistry Major

Quinn Kistenfeger, Biochemistry Major
Haley Ferguson, Biochemistry Major
Advisor(s): Ann Hagerman, Department of Chemistry and Biochemistry
Chemical Models of Tannin Biodegradation

B106 Jason Flint, Biology Major

Durga Samanthula, Microbiology Major
Advisor(s): Tracy Haynes, Department of Biology
Pi3K Induces Retinal Regeneration in Embryonic Chicks

Poster Presentation Listing by Poster Number

SESSION C: 3:00 – 4:30 P.M.

SHRIVER LOBBY

(See presenter index on pages 53 - 73)

C01L Brandi McConahay, Anthropology and Interactive Media Studies Major
Anglo-Saxon Mortuary Archaeology
Kelly Marcus, Anthropology Major
Medical Decision Making Among Homeless Populations
Gwen Lloyd, Anthropology Major
Discovering the Past
Demi Dilenge, Anthropology and Psychology Major
This is Caroline
Savana Rosalez, Anthropology and Psychology Major
Deciding what is Healthy and Unhealthy Play for Children
David Colston, Anthropology and Public Administration Major
This is Juan Garcia
Caitlin McElligott, Anthropology and History Major
The Complex Problems of Single Mothers of Color
Advisor(s): Cameron Hay-Rollins, Department of Anthropology
Public Anthropology: Making Scholarly Research Accessible

C02L Emma Brzezinski, Anthropology Major
Nicole Schapker, Anthropology and Biochemistry Major
Advisor(s): Linda Marchant, Department of Anthropology
Gombe Chimpanzee Termite Fishing Behavior: Using Noldus Observer Software to Examine Laterality

C03L Erika Jeffers, Microbiology and Premedical Studies Major
Quentin Stickley, Anthropology Major
Advisor(s): Melissa Rosenzweig, Department of Anthropology
Archeobotanical Analysis from Ziyaret Tepe

C04L James Harris, Individualized Studies - Western Program Major
Advisor(s): Christopher Meyers, Department of Biology
Urbanization's Effect on Gray Squirrel Foraging Behavior

C05L Jason Simpson, Interactive Media Studies Major
Advisor(s): Murali Paranandi, Department of Architecture
Sequence Site

C06L Elena Penhos, Biology and Neuroscience Major
Danny Heller, Marketing Major
Advisor(s): Matthew McMurray, Department of Psychology
Danielle Tapp, Department of Psychology
Pick a Prize: Influence of Reward Type on Impulsive Decision Making

C07L Antonia Caba, Public Health Major
Advisor(s): Rose Marie Ward, Department of Kinesiology and Health
Exploring the Relationship between Body Image and Alcohol Consumption among Sorority Members and Non-members

Poster Presentation Listing by Poster Number

SESSION C: 3:00 – 4:30 P.M.

JOHN DOLIBOIS ROOMS

(See presenter index on pages 53 - 73)

- C01 Margaret Carney**, Biology Major
Christine Clark, Biology and Neuroscience Major
Advisor(s): Kathleen Killian, Department of Biology
Mollie Sorrell, Department of Biology
The Role of the Enzyme Phenoloxidase in the Immune Function and Aggressive Behavior of the Cricket Acheta Domesticus
- C02 Kendall Smith**, Chemistry and Premedical Studies Major
Ross Rybakowicz, Biology and Premedical Studies Major
Advisor(s): Kathleen Killian, Department of Biology
Mollie Sorrell, Department of Biology
Junctional Communication in the Neurogenic Niche
- C03 Alexandra Unger**, Biology and Premedical Studies Major
Kelsy Schultz, English Creative Writing and Premedical Studies Major
Elizabeth Jacobs, Biology and Premedical Studies Major
Advisor(s): Kathleen Killian, Department of Biology
Kathryn Kohl, Department of Biology
Effects of Cold Stress on Reproductive Behavior in Male Acheta domesticus Crickets
- C04 Zachary Fields**, Biology Major
Advisor(s): Michael Robinson, Department of Biology
Stephanie Padula, Department of Biology
Creation of a Transgenic Mouse Line with Tamoxifen-Induced Cre Expression in the Lens
- C05 Justin Poth**, Biochemistry and Premedical Studies Major
Emma Buck, Biology and German Major
Advisor(s): Michael Robinson, Department of Biology
Brad Wagner, Department of Biology
Phoung Lam, Department of Biology
Unlocking Our Inner Newt: CRISPR/Cas9 Mediated Retina Pigmented Epithelium to Neural Retina Trans-Differentiation
- C06 Malory Owen**, Zoology and Environmental Science Major
Advisor(s): Nancy Solomon, Department of Biology
Brian Keane, Department of Biological Sciences
Connor Lambert, Department of Biology
Effects of Vegetation Characteristics on Nest Site Selection and Reproduction of Female Prairie Voles (Microtus ochrogaster)
- C07 Taft Marsh**, Botany Major
Advisor(s): Brian Grubb, Department of Biology
Daniel Gladish, Department of Biology
Audubon Ash Tree Project
- C08 Leah Davey**, Biology Major
Advisor(s): Richard Moore, Department of Biology
Bao Tram Hoang, Department of Biology
Distribution and Frequency of Red and Yellow Papaya Alleles in Central America
- C09 Kyle Bueter**, Botany Major
Advisor(s): Richard Moore, Department of Biology
Taylor Chae, Department of Biology
Epigenetic Modification of Sex Expression in Papaya
- C10 Avan Colah**, Biology and Premedical Studies Major
Advisor(s): Richard Bretz, Department of Chemistry and Biochemistry
Marcia Lee, Department of Microbiology
Characterization of an Anti-Fungal Compound in Aloe Arborescens
- C11 Hailey Hirata**, Biochemistry Major
Advisor(s): Richard Bretz, Department of Chemistry and Biochemistry
Marcia Lee, Department of Microbiology
Isolation of Potential Anti-fungal Compound(s) from Aloe Barbadensis

Poster Presentation Listing by Poster Number

SESSION C: 3:00 – 4:30 P.M.

JOHN DOLIBOIS ROOMS

(See presenter index on pages 53 - 73)

- C12 Michael Strickley**, Biology Major
Advisor(s): Richard Bretz, Department of Chemistry and Biochemistry
The Uptake of Phosphate and Nitrate Ions in Carex comosa and Carex hystericia
- C13 Bri Cooper**, Environmental Earth Science and Sustainability Major
Sean Davis, Earth Science Education Major
Kimberly Spowles, Earth Science Education Major
Jessica Goldstein, Geology Major
Advisor(s): Brian Currie, Department of Geology and Environmental Earth Science
Patrick Cullen, Department of Geology and Environmental Earth Science
Identifying Structural Features for the Southern Extent of the Rome Trough in Gilmer County, West Virginia
- C14 Brianne Safer**, Psychology Major
Marie Yamada-Killilea, Psychology Major
Advisor(s): Amanda Diekman, Department of Psychology
Melissa Fuesting, Department of Psychology
Tessa Benson-Greenwald, Department of Psychology
Preferred Traits of Science, Technology, Engineering, and Mathematics Role Models
- C15 Kiley Duhn**, Accountancy and Economics Major
Nikki Weaver, Marketing Major
Samantha Bosse, Economics Major
Jacob Brown, Supply and Operations Management and Information Systems Major
Advisor(s): Megan Gerhardt, Department of Management
Major Motivations: The Choice Behind a Business Major
- C16 Jordan Lilly**, Marketing Major
Mackenzie Craney, Accountancy Major
Giuliana Pudlo, Supply Chain and Operations Management Major
Mary McKenna, Accountancy Major
Advisor(s): Megan Gerhardt, Department of Management
Ethical Behavior Inside and Outside of the Classroom
- C17 Graham von Carlowitz**, German Major
Advisor(s): Mila Ganeva, Department of German
Exploring Germany's Immigration History in Light of the Refugee Crisis: An Examination of Integration
- C18 Kira Osowski**, Psychology Major
Advisor(s): Vrinda Kalia, Department of Psychology
Silence is Golden? Examining the Impact of Silence versus Brief Mindfulness on Risky Decision Making
- C19 Bryan Von Der Vellen**, Psychology and Premedical Studies Major
Jose Jacobo, Psychology Major
Kira Osowski, Psychology Major
Advisor(s): Vrinda Kalia, Department of Psychology
Stressed Out: Examining the Effect of Stress on Executive Functioning in Females
- C20 Zachary Digby**, Biochemistry Major
Advisor(s): Dominik Konkolewicz, Department of Chemistry and Biochemistry
Progyateg Chakma, Department of Chemistry and Biochemistry
New Dynamic Materials using Reversible Maleimide Thiol-Michael Chemistry
- C21 Elizabeth Foster**, Chemistry and Neuroscience Major
Advisor(s): Dominik Konkolewicz, Department of Chemistry and Biochemistry
Importance of Network Architecture: Healable, Malleable, Tough and Stable Soft Materials using Orthogonal Dynamic Bonds in an Interpenetrating Network
- C22 Carrie Dobbs**, Chemistry and Premedical Studies Major
Advisor(s): Stacey Lowery Bretz, Department of Chemistry and Biochemistry
Timothy Abell, Department of Chemistry and Biochemistry
Investigating Students' Misconceptions about Concentration of Aqueous Solutions

Poster Presentation Listing by Poster Number

SESSION C: 3:00 – 4:30 P.M.

JOHN DOLIBOIS ROOMS

(See presenter index on pages 53 - 73)

- C23 Katie Ferguson**, Chemistry and Premedical Studies Major
Advisor(s): Stacey Lowery Bretz, Department of Chemistry and Biochemistry
Maia Popova, Department of Chemistry and Biochemistry
General Chemistry Students' Abilities to Translate Between Symbolic and Space-filling Representations When Reasoning About Bonding in a Combustion Reaction
- C24 Kevin Rarden**, Chemistry Education Major
Advisor(s): Stacey Lowery Bretz, Department of Chemistry and Biochemistry
Timothy Abell, Department of Chemistry and Biochemistry
Multiple Representations of Bonding: An Analysis of Students' Ideas about Molecular Polarity
- C25 Lydia Schneider**, Zoology and Neuroscience Major
Anelise Kollias, Zoology Major
David Sullivan, Biology Major
Advisor(s): Lori Isaacson, Department of Biology
Jessie Maloney, Department of Biology
Plasticity of Glial Cells in the Spinal Cord Following Injury of Peripheral Axons
- C26 Mengyang Xu**, Chemistry Major
Meng Lu, Chemistry Major
Advisor(s): Jiangjiang Zhu, Department of Chemistry and Biochemistry
Evaluating Metabolic Response of Human Gut Cells Effected by Polyphenols Influenced Gut Bacteria using Targeted LC-MS/MS Metabolic Profiling
- C27 Danyelle Roan**, Microbiology Major
Advisor(s): Matthew McMurray, Department of Psychology
Danielle Tapp, Department of Psychology
Oxytocin and Its Influence on Gambling Behavior
- C28 Hannah Woods**, Psychology and Classical Humanities Major
Advisor(s): Terri Messman-Moore, Department of Psychology
Lee Eshelman, Department of Psychology
Lifetime Sexual Violence and Alexithymia: The Mediating Role of Dissociation, Thought Suppression, and Shame
- C29 Caitlyn Jones**, Psychology and English Professional Writing Major
Advisor(s): Molly Metz, Department of Psychology
What We Talk About When We Talk About Trigger Warnings: Defining a Problem
- C30 Lamuel Bean**, Public Health Major
Advisor(s): Rose Marie Ward, Department of Kinesiology and Health
Correlation Between Alcohol Consumption and Basal Metabolic Rate
- C31 Olivia Callahan**, Kinesiology Major
Advisor(s): Rose Marie Ward, Department of Kinesiology and Health
Determining the Relationship Between Greek and non-Greek members and Their Likelihood of Having a Second Social Media Account (Finsta)
- C32 Alyssa Fuhr**, Kinesiology Major
Advisor(s): Rose Marie Ward, Department of Kinesiology and Health
How Does Chronotype Influence Alcohol Consumption Among College Students?
- C33 Jourdan Greenlee**, Kinesiology and Nutrition Major
Advisor(s): Rose Marie Ward, Department of Kinesiology and Health
Influence of Age Difference on Alcohol Use within Couples

Poster Presentation Listing by Poster Number

SESSION C: 3:00 – 4:30 P.M.

JOHN DOLIBOIS ROOMS

(See presenter index on pages 53 - 73)

- C34 Micah Morris**, Biochemistry Major
Advisor(s): David Tierney, Department of Chemistry and Biochemistry
Whitney Craig, Department of Chemistry and Biochemistry
Modeling Matrix Metalloproteinase Inhibition with Spectroscopic Study of Carbonic Anhydrase
- C35 Caroline Roti**, Chemical and Paper Engineering Major
Advisor(s): Rose Marie Ward, Department of Kinesiology and Health
Bars, Booze, and Benzodiazepine: An Examination of Alcohol and Xanax
- C36 Isaiah Stewart**, Environmental Earth Science Major
Advisor(s): Rose Marie Ward, Department of Kinesiology and Health
Drinking Away the Pain: Exploring the Relation between Depression and Alcohol Consumption among Men and Women
- C37 Nick Vanderhoof**, Kinesiology Major
Advisor(s): Rose Marie Ward, Department of Kinesiology and Health
Sexual Assault Victimization among Varied Personality Traits
- C38 Jacqueline Ziegman**, Kinesiology and Premedical Studies Major
Advisor(s): Rose Marie Ward, Department of Kinesiology and Health
Perceived Importance of Alcohol and Peer Pressure Predict Alcohol Consumption among College Students
- C39 Claudia Worley**, Chemistry Major
Advisor(s): David Tierney, Department of Chemistry and Biochemistry
Nuclear Magnetic Resonance (NMR) Temperature Dependent Studies of Five Coordinate Cobalt (II) Complexes
- C40 Jenna Rajczyk**, Kinesiology Major
Nathan Giangardella, Kinesiology Major
Advisor(s): Kyle Timmerman, Department of Kinesiology and Health
Victoria Warren, Department of Kinesiology and Health
Associations Among Indices of Physical and Cognitive Function in Older Adults
- C41 Lana Amer**, Bioengineering Major
Advisor(s): Valerie Ubbes, Department of Kinesiology and Health
Increasing Access to Pediatric Oral Health Education
- C42 Martin Heidelman**, Biological Physics Major
Advisor(s): Paul Urayama, Department of Physics
Time Gating Optimization for Measurements of Cellular Autofluorescence
- C43 John Bowman**, Biology Major
Advisor(s): Karthik Vishwanath, Department of Physics
Anthony Young, Department of Physics
In vivo Applications of Diffuse Optical Techniques for Measuring Hemodynamics in Mouse Models of Cerebral Stroke
- C44 Adam Eggert**, Biological Physics Major
Advisor(s): Karthik Vishwanath, Department of Physics
Simmy Mirchandani, Department of Chemical and Paper Engineering
Smartphone Spectroscopy for Measurement of Diffuse Reflectance
- C45 Megan Rigot**, Nutrition Major
Connor Cashman, Kinesiology Major
Advisor(s): Kyle Timmerman, Department of Kinesiology and Health
Predictors of Lean Body Mass and Function in Older Adults

Poster Presentation Listing by Poster Number

SESSION C: 3:00 – 4:30 P.M.

JOHN DOLIBOIS ROOMS

(See presenter index on pages 53 - 73)

-
- | | |
|------------------------------------------------------------------------------------------------------------------------------------------------------------------------------------------------------------------------------------------------------------------------------------------------------------------------------------------------------------------------------------------------------------------------------------------------------------------------------------------------------------------------------------------------------------------------------------------------------------------------------------------------------------------------------------------------------------------------------------------------------------------------------------------------------------------------------------------------------------------------------------------------------------------------------------------------------------------------------------------------------------------------------------------------------------------------------------------------------------------------------------------------------------------------------------------------------------------------------------------------------------------------------------------------------------------------------------------------------------------------------------------------------------------------------------------------------------------------------------------------------------------------------------------------------------------------------------------------------------------------------------------------------------------------------------|-----------------------------------------------------------------------------------------------------------------------------------------------------------------------------------------------------------------------------------------------------------------------------------------------------------------------------------------------------------------------------------------------------------------------------------------------------------------------------------------------------------------------------------------------------------------------------------------------------------------------------------------------------------------------------------------------------------------------------------------------------------------------------------------------------------------------------------------------------------------------------------------------------------------------------------------------------------------------------------------------------------------------------------------------------------------------------------------------------------------------------------------------------------------------------------------------------------------------------------------------------------------------------------------------------------------------------------------------------------------------------------------------------------------------------------------------------------------------------------------------------------------------------------------------------------------------------------------------------------------------------------------------------------------------------------------------------------------------------------------------------------------------------------------------------------------------------------------------------------------------------------------|
| <p>C46 Zachary Roebel, Kinesiology and Public Health Major
Advisor(s): Valerie Ubbes, Department of Kinesiology and Health
Samantha Bettinger, Department of Kinesiology and Health
<i>Vegetable Habits of Children: Frequency of Consumption and Social Modeling Correlates</i></p> <p>C47 Emma Geary, Psychology and English Professional Writing Major
Advisor(s): Allen McConnell, Department of Psychology
<i>Environmentally-friendly Behaviors in the Real World</i></p> <p>C48 Michael Saaranen, Physics Major
Jacob McFarland, Physics Major
Advisor(s): Burcin Bayram, Department of Physics
<i>Time-Resolved Laser-induced Molecular Fluorescence Spectroscopy</i></p> <p>C49 Marian Kelley Patterson, University Studies Major
Advisor(s): Karthik Vishwanath, Department of Physics
Sara Zanfardino, Department of Physics
<i>Development and Testing of an Optical Method for Quantifying Flow in Turbid Media</i></p> <p>C50 Marissa Lane, English Creative Writing and English Literature Major
Advisor(s): Joseph Bates, Department of English
<i>Breaking the Mold: Redefining the Novel</i></p> <p>C51 Olivia Lahey, Biology and Spanish Major
Advisor(s): David Beard, Department of Spanish and Portuguese
<i>Production of Subject-Verb Agreement in Second Language Learners of Spanish at Miami University</i></p> <p>C52 JP Roach, Sport Leadership and Management Major
Advisor(s): Helaine Alessio, Department of Kinesiology and Health
<i>Heart Rate Variability</i></p> | <p>C53 Cailin Gatts, Kinesiology Major
Kristina Arslain, Nutrition Major
Advisor(s): Kevin Ballard, Department of Kinesiology and Health
Robert Duguid, Department of Kinesiology and Health
Craig Berry, Department of Kinesiology and Health
<i>Effect of Prior Aerobic Exercise on Plasma Endothelin-1 Responses to Prolonged Sitting in Healthy Men</i></p> <p>C54 Dillon Campbell, Athletic Training Major
Advisor(s): Eric Brooks, Department of Kinesiology and Health
<i>Chronic Exertional Compartment Syndrome in a Collegiate Swimmer: A Case Report</i></p> <p>C55 Everett Ritter, Spanish Education and Spanish Major
Advisor(s): David Beard, Department of Spanish and Portuguese
<i>A Comparative Analysis of Authentic vs. Inauthentic Text Syntax in the L2 Classroom</i></p> <p>C56 Naomi Wiater, Spanish and Spanish Education Major
Advisor(s): David Beard, Department of Spanish and Portuguese
<i>The Implications of por and para in an L2 Spanish Classroom</i></p> <p>C57 Jiayu Wu, Statistics Major
Lin Fang, Statistics Major
Advisor(s): Tatjana Miljkovic, Department of Statistics
<i>Modeling Impact of Natural Disasters on Income Distribution in the United States</i></p> <p>C58 Xiaoxiao Zhao, Statistics Major
Junrong Wu, Mathematics Major
Advisor(s): Tatjana Miljkovic, Department of Statistics
<i>Statistical Modeling the Inventory Allocation of Bay Area Bike Share</i></p> <p>C59 Alan Tatro, Mathematics and Statistics Major
Advisor(s): Jing Zhang, Department of Statistics
Thomas Fisher, Department of Statistics
<i>Bayesian Variable Selection in Time Series Regression with an Application to Ecological Data</i></p> |
|------------------------------------------------------------------------------------------------------------------------------------------------------------------------------------------------------------------------------------------------------------------------------------------------------------------------------------------------------------------------------------------------------------------------------------------------------------------------------------------------------------------------------------------------------------------------------------------------------------------------------------------------------------------------------------------------------------------------------------------------------------------------------------------------------------------------------------------------------------------------------------------------------------------------------------------------------------------------------------------------------------------------------------------------------------------------------------------------------------------------------------------------------------------------------------------------------------------------------------------------------------------------------------------------------------------------------------------------------------------------------------------------------------------------------------------------------------------------------------------------------------------------------------------------------------------------------------------------------------------------------------------------------------------------------------|-----------------------------------------------------------------------------------------------------------------------------------------------------------------------------------------------------------------------------------------------------------------------------------------------------------------------------------------------------------------------------------------------------------------------------------------------------------------------------------------------------------------------------------------------------------------------------------------------------------------------------------------------------------------------------------------------------------------------------------------------------------------------------------------------------------------------------------------------------------------------------------------------------------------------------------------------------------------------------------------------------------------------------------------------------------------------------------------------------------------------------------------------------------------------------------------------------------------------------------------------------------------------------------------------------------------------------------------------------------------------------------------------------------------------------------------------------------------------------------------------------------------------------------------------------------------------------------------------------------------------------------------------------------------------------------------------------------------------------------------------------------------------------------------------------------------------------------------------------------------------------------------|

Poster Presentation Listing by Poster Number

SESSION C: 3:00 – 4:30 P.M.

JOHN DOLIBOIS ROOMS

(See presenter index on pages 53 - 73)

- C60 Audrey Short**, Biochemistry Major
Advisor(s): Michael Kennedy, Department of Chemistry and Biochemistry
William Joesten, Department of Chemistry and Biochemistry
Examining Longitudinal Immunohistochemistry of Alpha and Beta Cells in the NOD-Mouse Model
- C61 Kirsten Gonzales**, Biochemistry Major
Advisor(s): Carole Dabney-Smith, Department of Chemistry and Biochemistry
Qianqian Ma, Department of Chemistry and Biochemistry
Characterization of the Chloroplast Twin Arginine Transport Mutant, hcf106, Arabidopsis thaliana
- C62 Gwendolyn Thomas**, Biochemistry and Premedical Studies Major
Advisor(s): Carole Dabney-Smith, Department of Chemistry and Biochemistry
Aman Habtemichael, Department of Chemistry and Biochemistry
Interaction Points between Stromally Exposed CpTatC and Precursor Signal Peptide
- C63 Elise Leonard**, Chemistry and Premedical Studies Major
Advisor(s): Neil Danielson, Department of Chemistry and Biochemistry
Ashley Richardson, Department of Chemistry and Biochemistry
Anion Exchange Chromatography of Sulfonated Compounds Using a Protamine Coated Column
- C64 Nachiket Potineni**, Microbiology Major
Advisor(s): Katia Del Rio-Tsonis, Department of Biology
Zeyu Han, Department of Biology
Knockdown and Knockout of DNMT3a Affects Chick Eye Morphogenesis
- C65 Shelby Thompson**, Biochemistry Major
Julia Walton, Biochemistry Major
Kelsey Cottingim, Biochemistry Major
Lyndsey Gregerson, Biochemistry Major
Justin Gassaway-Steere, Biochemistry Major
Advisor(s): Michael Crowder, Department of Chemistry and Biochemistry
Antibiotic Resistance: Why You Should Care
- C66 Kenna Koehler**, Biochemistry Major
Taylor Bussell, Chemistry Major
Maggie Feazell, Chemistry Major
Erin Lensmeyer, Chemistry Major
Nicole VanDoren, Biochemistry Major
Advisor(s): Michael Crowder, Department of Chemistry and Biochemistry
Antibiotic Resistance in Healthcare
- C67 Matthew Kelly**, Biochemistry Major
Patrick McHenry, Biochemistry Major
Dylan Bailey Van-Kuren, Biochemistry Major
Andrew Donahey, Chemistry Education Major
Zach Higgins, Biochemistry Major
Advisor(s): Michael Crowder, Department of Chemistry and Biochemistry
Ellen Yezierski, Department of Chemistry and Biochemistry
Exploring Fermentation Sciences in the Classroom
- C68 Sam George**, Biochemistry and Neuroscience Major
Aaron Abraham, Biochemistry and Premedical Studies Major
Advisor(s): Michael Crowder, Department of Chemistry and Biochemistry
David Tierney, Department of Chemistry and Biochemistry
Whitney Richert, Department of Chemistry and Biochemistry
Overexpression, Purification and Kinetic Characterization of Matrix Metalloproteinase 12 (MMP-12)

Poster Presentation Listing by Poster Number

SESSION C: 3:00 – 4:30 P.M.

JOHN DOLIBOIS ROOMS

(See presenter index on pages 53 - 73)

-
- C69 Zachary Adkins**, Biochemistry Major
Advisor(s): Michael Crowder, Department of Chemistry and Biochemistry
Alexander Bergstrom, Department of Chemistry and Biochemistry
Mechanistic Studies of Metallo- β -Lactamase Inhibitor Aspergillomarasmine A (AMA)
- C70 Emelia Acheampong**, Nursing Major
Prisca Obih, Nursing Major
Victoria Bosomefi, Nursing Major
Linda Asomani, Nursing Major
Advisor(s): Jennifer Rode, Department of Nursing
Does Early Tracheostomy Reduce the Length of Stay in Intensive Care Unit?
- C71 Addison Bryant**, Nursing Major
Sarah Titterington, Nursing Major
Kylie Turoff, Nursing Major
Hanna Powers, Nursing Major
Advisor(s): Jennifer Rode, Department of Nursing
Homebirth and Neonatal Outcomes
- C72 Abby Cooper**, Nursing Major
Nicoline Nshom, Nursing Major
Chanely Rodriguez, Nursing Major
Brittany Simpson, Nursing Major
Advisor(s): Jennifer Rode, Department of Nursing
Misshapenness
- C73 Dana Severin**, Nursing Major
Josh Padgett, Nursing Major
Haylee Blevins, Nursing Major
Anna Fry, Nursing Major
Advisor(s): Jennifer Rode, Department of Nursing
Protecting the Prostate
- C74 Ashantia Collins**, Psychology Major
Haleigh Lindner, Psychology Major
Sarah Moore, Psychology Major
Advisor(s): Amy Summerville, Department of Psychology
Ryan Walker, Department of Psychology
Fate Perceptions and Counterfactual Thinking
- C75 Storm Bollenbach**, Nursing Major
Jane Wittman, Nursing Major
Doreen Aidoo, Nursing Major
Leah Glover, Nursing Major
Advisor(s): Jennifer Rode, Department of Nursing
Medical CannaBLISS?
- C76 Shelby Capitulik**, Nursing Major
Sherry Akins, Nursing Major
Alain Oyeh, Nursing Major
Kristin Harbeson, Nursing Major
Advisor(s): Jennifer Rode, Department of Nursing
TLC: Does Kangaroo Care Reduce the Effects of Procedural Pain in Preterm Infants?
- C77 Emily Cornett**, Nursing Major
Emily Mossman, Nursing Major
Megan Wise, Nursing Major
Jamie Jones, Nursing Major
Advisor(s): Jennifer Rode, Department of Nursing
Is It Worth the Stick?
- C78 Mary Truster**, Nursing Major
Madison Bustle, Nursing Major
Leah Kreiner, Nursing Major
Advisor(s): Jennifer Rode, Department of Nursing
Easing Labor Pains with Essential Oils
- C79 Jalen Noble**, Psychology and Strategic Communication Major
Alec Taylor, Kinesiology Major
Nick Schwabe, Psychology Major
Liam Byrne, History Major
Advisor(s): L. James Smart, Department of Psychology
It's All in the Posture: Influence of Stance on Adaptation and Performance in a Virtual Task
- C80 Nhat Pham**, Microbiology and Premedical Studies Major
Daniel Jones, Microbiology Major
Advisor(s): Rachael Morgan-Kiss, Department of Microbiology
SEA Miami: Influence of Biogeography vs. Day and Night Cycles for Microbial Diversity in the Caribbean

Poster Presentation Listing by Poster Number

SESSION C: 3:00 – 4:30 P.M.

JOHN DOLIBOIS ROOMS

(See presenter index on pages 53 - 73)

- C81 Zachary Smith**, Microbiology and Premedical Studies Major
Sean Graham, Microbiology Major
Advisor(s): Rachael Morgan-Kiss, Department of Microbiology
SEA Miami: Measuring the Abundance and Diversity of Microbial Dark Matter in Marine Samples [Caribbean Sea, Puerto Rico]
- C82 Andrew Woodruff**, Microbiology Major
Zoe Bolen, Microbiology Major
Advisor(s): Rachael Morgan-Kiss, Department of Microbiology
SEA Miami: Comparison of Microbial Diversity Nearshore [San Juan Harbor and Vieques] vs. Open Ocean [Caribbean]
- C83 Danielle Belzer**, Speech Pathology and Audiology Major
Advisor(s): Aaron Shield, Department of Speech Pathology and Audiology
The Development of Joint Attention in a Bimodal Bilingual Child with Autism
- C84 Wil Hughes**, Speech Pathology and Audiology Major
Danielle Stelzer, Speech Pathology and Audiology Major
Advisor(s): Aaron Shield, Department of Speech Pathology and Audiology
Do Deaf Children with Autism Differ from Typically-developing Deaf Children in their Use of the Face?
- C85 Kristina Randall**, Speech Pathology and Audiology Major
Advisor(s): Aaron Shield, Department of Speech Pathology and Audiology
Language Development in a Bimodal Bilingual Child with Autism
- C86 Marie Claire Papamarcos**, Microbiology and Spanish Major
Alex Lanoue, Medical Laboratory Science and Biology Major
Thatcher Creber, Biology Major
Advisor(s): Rachael Morgan-Kiss, Department of Microbiology
SEA Miami: Trends in Chlorophyll-a and Dissolved Oxygen in the Water Column
- C87 Benjamin Keller**, Microbiology Major
Brittany Nordhaus, Psychology and Biology Major
Advisor(s): Rachael Morgan-Kiss, Department of Microbiology
SEA Miami: Primary Driver of Copepod Diel Vertical Migration Pattern; Ultra-Violet Radiation Versus Predation in the Waters Surrounding Puerto Rico
- C88 Benjamin Keller**, Microbiology and Premedical Studies Major
Martha Carter, Microbiology and Premedical Studies Major
Advisor(s): Rachael Morgan-Kiss, Department of Microbiology
SEA Miami: Comparing Community Composition of Diatoms to Bacteria
- C89 Noah Ising**, Microbiology Major
Casey Horan, Microbiology Major
Advisor(s): Rachael Morgan-Kiss, Department of Microbiology
Keely Icardi, Department of Microbiology
Isha Kalra, Department of Microbiology
SEA Miami: The Relationship of the Day and Night Cycle and Nutrient Concentration on Bacterial Diversity
- C90 Martha Carter**, Microbiology and Premedical Studies Major
Sarah Hiner, Medical Laboratory Science and Microbiology Major
Advisor(s): Rachael Morgan-Kiss, Department of Microbiology
SEA Miami: Phytoplankton Biodiversity: A Comparison of Coastal and Open Ocean Waters

Poster Presentation Listing by Poster Number

SESSION C: 3:00 – 4:30 P.M.

JOHN DOLIBOIS ROOMS

(See presenter index on pages 53 - 73)

- C91** **Zev Cariani**, Microbiology Graduate Student
Jyoti Kashyap, Microbiology Graduate Student
Simin Zhao, Geology Graduate Student
Advisor(s): Rachael Morgan-Kiss, Department of Microbiology
SEA Miami: Microbial Community Analysis of San Juan Surface Transect Samples
- C92** **Joseph Baumgartner**, Microbiology Major
Meghan Bowers, Microbiology and Premedical Studies Major
Cassandra Worner, Microbiology and Neuroscience Major
Advisor(s): Rachael Morgan-Kiss, Department of Microbiology
SEA Miami: Bacterial Diversity by Time of Day in Marine Samples Near Puerto Rico
- C93** **Lauren Brady**, Microbiology Major
Katelyn Scheive, Psychology Major
Advisor(s): Jennifer Quinn, Department of Psychology
Brett East, Department of Psychology
Contributions of the Medial and Lateral Entorhinal Cortex in the Acquisition of Fear Memory
- C94** **Tiffany Campbell**, Biology, Psychology and Neuroscience Major
Shelby Lab, Psychology and Neuroscience Major
Ethan Hollingsworth, Biology and Neuroscience Major
Victoria Mordzinski, Biology and Premedical Studies Major
Megan Perry, Psychology Major
Advisor(s): Jennifer Quinn, Department of Psychology
Daniel Kochli, Department of Psychology
The Role of NMDA Receptors in the Retrieval and Reconsolidation of Context Fear Discrimination Memory
- C95** **Haleigh Lindner**, Psychology Major
Megan Perry, Psychology Major
Jessica Genaro, Psychology Major
Advisor(s): Jennifer Quinn, Department of Psychology
Daniel Kochli, Department of Psychology
Role of the VTA in the Destabilization of Established Fear Memories
- C96** **Emily Konrad**, Microbiology Major
Cole Goodrich, Microbiology Major
Jon Abell, Biology Major
Sydney Arlis, Biology Major
Annastasia Babcock, Biology Major
Allison Biedenharn, Microbiology Major
Amanda Burgess, Microbiology Major
Luke Carrafiello, Microbiology Major
Callen Conroy, Microbiology Major
Steven Madias, Biology Major
Cortney Mitchem, Microbiology Major
Paolo Palacios, Medical Laboratory Science Major
Julie Donna, Microbiology and Environmental Science Major
Steph Smith, Microbiology Major
Advisor(s): Luis Actis, Department of Microbiology
Mitchell Balish, Department of Microbiology
Rebecca Balish, Department of Microbiology
Mariah Squire, Department of Microbiology
Hailey Riggs, Department of Microbiology
Mystery DNA: A Three-Part Thriller Featuring Mycobacteriophage Clusters D, N, and A
- C97** **Bryn McElroy**, Speech Pathology and Audiology Major
Sarah Kingsbury, Speech Pathology and Audiology and Spanish Major
Megan Igel, Speech Pathology and Audiology Major
Advisor(s): Aaron Shield, Department of Speech Pathology and Audiology
A Linguistic Analysis of Narratives Produced by Adolescents with High-Functioning Autism

Poster Presentation Listing by Poster Number

SESSION C: 3:00 – 4:30 P.M.

JOHN DOLIBOIS ROOMS

(See presenter index on pages 53 - 73)

C98 Madeline DiFilippo, Accountancy and Political Science Major
Advisor(s): Monica Schneider, Department of Political Science
Running as a Woman: The Reality of Penalties Based on Role Incongruity

C99 Nicholas Thomas, Sport Leadership and Management Major
Advisor(s): Thelma Horn, Department of Kinesiology and Health
An Investigation of Coaching Career Tracks in Collegiate Basketball: Relationships to Gender and Race/Ethnicity

C100 Troy Meyer, Biology Major
Advisor(s): Thomas Crist, Department of Biology
Michael Cunningham-Minnick, Department of Biology
Effects of Water Body Type on Dragonfly Community Composition

C101 Alex Mueller, Athletic Training Major
Advisor(s): Eric Brooks, Department of Kinesiology and Health
Posterior Sternoclavicular Joint Dislocation During Spring Football

C102 Charles Asselmeier, Zoology and Premedical Studies Major
Jennifer Rowe, Biology and Premedical Studies Major
Advisor(s): Brad Wagner, Department of Biology
Michael Robinson, Department of Biology
Stephanie Padula, Department of Biology
Dissecting the Mechanism by which Pten Deficiency Rescues Lens Development in Fgfr2 Deficient Mice

C103 Kimberly Bowman, Chemistry and Neuroscience Major
Advisor(s): David Tierney, Department of Chemistry and Biochemistry
The Effect of Ionic Liquids on Co(II) Complexes and their Counter Ions

C104 Amanda Burke, International Studies Major
Advisor(s): Paul Flaspohler, Department of Psychology
Cameron Hay-Rollins, Department of Anthropology
The Role of Educational Resource Centers in Decreasing Infant Mortality

C105 Kole Sedlack, Biology Major
Arya Chalke, Microbiology Major
Justin Crookes, Biology and Psychology Major
Erin Enright, Biochemistry Major
Advisor(s): Joyce Fernandes, Department of Biology
Manipulation of EGF Ligands During Flight Muscle Development in Drosophila

C106 Blake Rasor, Biology and Microbiology Major
Advisor(s): Michael Robinson, Department of Biology
Developing an in vitro Assay for Transdifferentiation between Retinal Cell Types

RECOGNITION:

Miami Mentors Engaging Students in Research

By Martha E. Weber

Recognition: Miami Mentors Engaging Students in Research

Our 23rd annual undergraduate research forum embodies Miami's 2020 Plan "unifying goal:" to promote a vibrant learning and discovery environment that produces extraordinary student and scholarly outcomes."

In addition, undergraduate student research at Miami:

- Ensures vitality and sustainability by building a forward-looking, efficient, and caring culture that stimulates, recognizes, and rewards creativity, entrepreneurial thinking, and exemplary performance.
- Promotes a diverse culture of inclusion, integrity, and collaboration that deepens understanding and embraces intercultural and global experiences.

Our student presenters represent a wide range from first year researchers through seniors who are in various stages of developing their identity as a student scholar. During your visit to the oral and poster sessions we invite you to chat with these researchers about their unique experiences that have prepared them for future careers.

As a (Carnegie) Doctoral Intensive University, Miami attracts faculty members who have a passion for advanced research and scholarship, as well as a commitment to teaching. Miami consistently graduates the second highest number of science students among Ohio public universities.

Today and throughout the year, we hope you will take a few moments to recognize the truly amazing contributions from our dedicated faculty and staff who consistently include students in these crucial research partnerships that explore the process of learning.

The undergraduate research forum illustrates the strong commitment of Miami faculty to provide hands-on interactions with students in the role of teacher-mentor. Mentors recognized in this publication for their dedication to stimulate student inquiry-based learning are representative of the efforts of a myriad of faculty and staff providing research experiences inside and outside the classroom.

This emphasis on personal attention from faculty and graduate students introduces incoming students to examine the possibility of how to get started in research. For Miami upper class students, the opportunity to continue research involvement during their entire undergraduate experience allows numerous opportunities to expand knowledge in their chosen discipline.

¹ http://miamioh.edu/_files/documents/2020plan/2020Plan_10-13.pdf

² Miami recognized in STEM Jobs Magazine and online as part of the entire 2016-2017 list of STEM JobsSM Approved Colleges by Victory Media.

Key indicators that demonstrate the extent to which a school works to:

1. Provide opportunities for students to explore STEM subjects.
2. Promote partnerships that foster STEM literacy and connect classrooms to careers.
3. Ensure coursework and activities that have a focus on careers.

Promote STEM programs that actively attract and engage underrepresented student populations

³ "Miami's "exceptionally strong commitment" to teaching has placed it first or second among public universities for the seventh year in a row in a U.S. News & World Report ranking. Miami is also regularly listed in Kiplinger's Personal Finance magazine, Forbes and the Fiske Guide as among the best quality/best value public colleges in the U.S.

RESEARCH MENTORS

2017 Undergraduate Research Forum

Anthropology

James S. Bielo
Jeb Card
Cameron Hay-Rollins
Linda Marchant
Melisa Rosenzweig
John Schaefer

Architecture and Interior Design

Murali Parandi

Armstrong Institute for Interactive

Media Studies

Eric Hodgson

Biology

Joseph Baumgartner
David Berg
Dawn Blitz
Taylor Chae
Courtney Clark-Hachtel
Jon Costanzo
Thomas Crist
Michael Cunningham-Minnick
Katia Del Rio-Tsonis
Joyce Fernandes
Melany Fisk
JD Gantz
Daniel Gladish
Jake Godfrey
Maria Gonzalez
David Gorchoy
Shinjini Goswami
Brian Grubb
Zeyu Han
Paul Harding
Tracy Haynes
Steven Hein
Bao Tram Hoang
Susan Hoffman
Lori Isaacson
Paul James
Brian Keane
Carolyn Keiffer
Kathleen Killian
Kathryn Kohl

Phuong Lam
Connor Lambert
Richard Lee
Chung Liang
David Linz
Agustin Luz-Madrigal
Jessie Maloney
Richard Moore
Nancy Paola Ruiz-Echeverri
Stephanie Padula
Jeremy Papuga
Joe Powers
Peipe Qi
Valerie Rajathi
Michael Robinson
Amber Rock
David Russell
Ann Rypstra
Minqian Shen
Haifei Shi
Nancy Solomon
Mollie Sorrell
Divyalakshmi Soundararajan
Michael Stanley
Aswati Subramanian
Sean Taylor
Yoshinori Tomoyasu
Mike Vanni
Brad Wagner
Ashley Walters
James Wiebler
Tanner Williamson
Craig Williamson
Qi Zhu

Black World Studies

Rodney Coates

Chemical, Paper and Biomedical Engineering

Catherine Almquist
Jason Berberich
Simmy Mirchandani
Andrew Paluch
Justin Saul
Jake Stapleton

Chemistry and Biochemistry

Timothy Abell
Gregory Allen
Abdullah Bilal Altundas
Alexander Bergstrom
Richard Bretz
Progyateg Chakma
Tafadzwa Chihanga
Andrew Craig
Whitney Craig
Michael Crowder
Carole Dabney-Smith
Neil Danielson
Gunjan Dixit
Daniel Drew
Katie Eudy
Benjamin Gung
Aman Habtemichael
Ann Hagerman
Scott Hartley
Faizule Hassan
William Joesten
Michael Kennedy
Dominik Konkolewicz
Gary Lorigan
Stacey Lowery Bretz
Qianqian Ma
Ruoyu Ma
Christopher Makaroff
Janet Marshall
C. Paul New
Richard Page
Maia Popova
Justin Pratt
Ashley Richardson
Whitney Richert
Anthony Sallese
Ramja Sritharan
Richard Taylor
David Tierney
Jorge Torres
Howard Vail
Jamie VanPelt
Michelle Veite
Gopi Nath Vemuri
Shenyuan Xu

RESEARCH MENTORS

2017 Undergraduate Research Forum

Hong Wang
Ellen Yezierski
Jiangjiang Zhu

Educational Psychology

Leah Wasburn-Moses

Electrical and Computer Engineering

Mark Scott

English

Joseph Bates
Andrew Hebard

Family Studies and Social Work

Chelsey Gates
Katherine Kuvalanka
Elise Radina

French and Italian

Andrea Righi

Geography

Bruce D'Arcus
Jerry Green

Geology and Environmental

Earth Science

Mike Brudzinski
Patrick Cullen
Brian Currie
Jonathan Levy
Carrie Tyler

Global & Intercultural Studies

Tani Sebro
Marguerite Shaffer

GRAMELAC

Mila Ganeva
Kazue Harada

History

Elana Albarrán

Information Systems and Analytics

Ying-Ju Chen

Latin American, Latino/a, & Caribbean Studies

Elena Albarrán
José Amador

Kinesiology and Health

Helaine Alessio
Kevin Ballard
Craig Berry
Samantha Bettinger
Eric Brooks
Robert Duguid
Karly Geller
Thelma Horn
Callie Maddox
Beth Miller
Jennifer Pate
Kyle Timmerman
Valerie Ubbes
Rose Marie Ward
Victoria Warren

Management and Leadership

Rhett Brymer
Scott Dust
Megan M. Gerhardt

Mathematics

Anna Ghazaryan

Mechanical and Manufacturing Engineering

Michael Bailey-Van Kuren
Muhammad Jahan
Jeong-Hoi Koo
James Moller

Media, Journalism and Film

Mack Hagood

Microbiology

Luis Actis

Rebecca Balish
Mitchell F. Balish
Annette Bollman
DJ Ferguson
Keely Icardi
Isha Kalra
Andor Kiss
Marcia R. Lee
Rachael Morgan-Kiss
Valerine Rajathi
Hailey Riggs
Jeff Ringiesn
Mariah Squire

Nursing

Eyad Musallam
Jennifer Rode

Physics

Lalit Bali
Samir Bali
Burcin Bayram
Jennifer Blue
Jeffrey Brock
Andrew Hachtel
Mahmud Khan
Patrick Janovick
Paul K. Urayama
Karthik Vishwanath
Anthony Young
Sara Zanfardino

Political Science

Erica Edwards
Mark Morris
Monica Schneider

Psychology

Steven Almaraz
Seham Almutairi
Aimee L. Belanger
Tessa Benson-Greenwald
Jason Deska
Amanda Diekman
Brett East

RESEARCH MENTORS

2017 Undergraduate Research Forum

Lee Eshelman
Christina Fitzpatrick
Paul Flaspohler
Melissa A. Fuesting
Yvette Harris
Kurt Hugenberg
Alexandria Intorcio
Joseph Johnson
Vrinda Kalia
Anne Kalomiris
Elizabeth Kiel Luebbe
Daniel Kochli
Jonathan Kuntsman
Paige Lloyd
Aaron Luebbe
Kathryn Mancini
Allen R. McConnell
Matthew McMurray
Terri Messman-Moore
Molly Metz
Ryan Nicholls
Barbara Oswald
Timothy Ovia
Jennifer J. Quinn
Anna Radke
Vaishali Raval
Leonard Jay Smart
Richard Smith
Amy Summerville
Danielle Tapp
Robin Thomas
Keisha Wagers
Ryan Walker
Audrey Weil
Virginia Wickline
Li Zhou

Sociology and Gerontology

Kristen Budd
C. Lee Harrington
Stephen Lippmann

Spanish and Portuguese

David Beard
Paula Gandara
Shelly Bromberg Jarrett

Speech Pathology and Audiology

Taylor Creech
Donna Scarborough
Aaron Shield

Statistics

Thomas Fisher
Tatjana Miljkovic
Jing Zhang

Teacher Education

Todd Edwards

Western Program

Jacqueline Daugherty
Christopher Meyers

MIAMI UNIVERSITY

Undergraduate Research Opportunities

The Office of the Provost and funds from individual gifts and grants to various departments across Miami University support Miami students' exploration of research.

Office of Research for Undergraduates

In fall 2014, Miami celebrated the opening of the Office of Research for Undergraduates (ORU) in King Library under the direction of Dr. Joseph Johnson, Professor of Psychology.

The ORU champions the vision, marketing, and coordination of research and creative efforts by Miami University undergraduate students. The ORU focuses on increasing participation in research and creative efforts of students in all majors; increasing the overall quality of undergraduate research at Miami as evidenced through publications, grants, and fellowships; and broadening student participation and faculty mentorship in diverse disciplines and backgrounds. In addition to the Undergraduate Research Forum, the ORU is responsible for:

- Promoting and publicizing the research achievements of Miami students
- Coordinating multi-disciplinary curricular efforts such as the First Year Research Experience
- Administering university-wide undergraduate research programs such as DUOS, URA and USS¹
- Offering co-curricular support programming including workshops, seminars, site visits, etc.
- Assisting with the identification of appropriate funding opportunities for student-led research
- Offering clear routes to research opportunities for our undergraduates, both at Miami as well as across the nation (e.g. summer programs, internships)
- Collaborating with other offices such as: Global Initiatives, Honors Program, Howe Writing Center, and the University Libraries
- Advocating beyond the university for support of undergraduate research through professional memberships

Council on Undergraduate Research Enhanced Membership thru ORU

ORU sponsors Miami's Enhanced Institutional Membership in Council on Undergraduate Research, to provide an unlimited number of our faculty, students, administrators, and staff to join CUR for free.

The Council on Undergraduate Research (CUR) is a national non-profit educational organization that provides research opportunities for students and faculty. The CUR Mission is "to support and promote high-quality undergraduate student-faculty collaborative research and scholarship". The council achieves its vision through the efforts of members within varying disciplines including: arts and humanities, biology, chemistry, geosciences, health sciences, mathematics and computer science, physics and astronomy, psychology, and social sciences. Representing over 900 colleges and universities, this organization provides publications and outreach activities to share strategies for establishing undergraduate research programs. For more information, visit the CUR **website at <http://www.cur.org/>**.

¹FYRE, DUOS, URA and USS program details available at: <http://www.MiamiOH.edu/oru>

Undergraduate Research Opportunities

Doctoral-Undergraduate Opportunities for Scholarship (DUOS)

Miami's DUOS program heightens the synergy between our graduate and undergraduate programs. Sponsored by The Graduate School and the Office of Advancement of Research and Scholarship, and in partnership with Miami's Preparing Future Faculty initiative, DUOS enables Miami undergraduates to do research or other creative activities guided by a talented graduate student mentor. Either graduates or undergraduates may initiate applications, but the undergraduate student maintains intellectual ownership of the project. Publication of research results is expected, and funds are awarded to the undergraduate and doctoral student for use in the research project. Any Miami University undergraduate student and any post-master's doctoral student in good standing may apply to participate.

First Year Research Experience (FYRE)

Miami's Office of Research for Undergraduates sponsors the First Year Research Experience (FYRE) Program. Over 500 Miami students have participated in the program since 2009. The program aims to impact student achievement and retention through involvement in research and inquiry at the very start of their college experience. The program encourages students to develop meaningful relationships with Miami faculty, graduate students and their peers outside of the classroom.

The FYRE program provides students with authentic, hands-on research experiences in small teams led by research-active faculty during a two-semester course sequence UNV171 and UNV172. Student researchers review their topic, design a study, and complete necessary training during the fall semester; they implement the study, analyze data, and present the results in the spring. This experience prepares students early for subsequent research opportunities such as summer research positions across the nation and independent research supervised by Miami faculty.

Joining the program requires a two-semester commitment from the student who must agree to:

- enroll in the 2-credit required seminar (UNV171 or UNV172)
- dedicate 2-4 additional hours per week to a faculty-mentored team research project

FYRE Research Tracks are conducted by a combination of faculty, graduate assistants, and undergraduate peer mentors with previous research experience. It is common for representatives from other university offices (e.g. University Libraries, Howe Writing Center) to contribute to instruction in UNV 171 and UNV 172. Additionally, there are several workshops, colloquia, and other professional development opportunities that are offered, some of which are exclusive to FYRE students.

Undergraduate Research Award (URA)

The ORU provides administrative support to the Miami University Senate Committee on Undergraduate Research. Since the early 1980's university senate has sponsored the URA to provide Miami Undergraduates faculty-mentored experience in developing grant applications. These partnerships encourage discovery, creative activity and novel, inquiry-based activity. The purpose of these funds is to foster and support research and creative activity from all disciplines, as well as to provide students with a hands-on opportunity to engage in the research process -- from conception to proposal to results. While students can propose projects that augment or are related to an existing faculty project, proposals are developed by student applicant(s), under the supervision of and with sponsorship by a faculty member.

Students may submit individual projects or team projects. Typical awards range from \$150 to \$500, but individual projects of exceptional merit or projects involving student teams may be funded up to \$1,000. Each individual student project or team project must be endorsed by a sponsor who certifies that the project is worth doing, has educational value to the student(s) and can be accomplished in the proposed time frame. The aim and result of specific projects supported by the program may be modest as long as the work can reasonably be interpreted as research or a creative endeavor. Applications may be made for support of a research project that is also being conducted for academic credit.

Undergraduate Research Opportunities

Undergraduate Summer Scholars (USS)

Miami's nationally-recognized USS program offers a premier undergraduate research experience. The USS initiative supports students in research and other creative activities during the summer under the supervision of faculty. Funds from the Provost's Office make 100 awards available per year. Each award includes a stipend for the student, a student allowance for supplies and services, 6 credit hours with academic fees waived, plus a faculty mentor allowance. Open to students from all disciplines, the focus of this 9-week summer program is the individual student/faculty mentor relationship. Applications by individual student/faculty pairs form the basis for subsequent allocation of USS positions to departments. Although coordinated by the Office of Research for Undergraduates (ORU), departments are primarily responsible for selecting particular student/faculty projects, approving those projects for academic credit, and evaluating the student experiences.

College of Arts and Science Dean's Scholars Program

Undergraduates who have exhibited excellence in the classroom and the ability to take on the extra challenges of research and scholarly work may be invited to participate in a Dean's Scholar Program within their division. Individual departments develop their own criteria for selecting scholars, but those selected must have conceived and proposed a project that is endorsed by a faculty mentor. During the senior year, Dean's Scholars conduct independent study with a departmental mentor. The scholar and the mentor each receive a professional expense stipend. Students conduct the study under the individual department's independent study or departmental honors course numbers, thereby earning academic credit for the project. Dean's Scholars projects culminate in significant work of scholarship aimed towards national/international publication, performance, or dissemination. For more information, contact the chair of your College of Arts and Science department.

College of Arts and Science

Hughes Medical Institute Summer Research Internships

Named after the original sponsoring foundation, the Hughes Summer internship is available for undergraduates interested in the biomedical sciences. Approximately 15 internships per year for Miami University students are supported with funds from the College of Arts and Science. Students in this program work with Miami faculty from the departments of biology, chemistry, and microbiology. The 10-week internship includes a participant stipend and provides twelve hours of credit with tuition costs waived.

Visit the College of Arts & Science Website for information on Dean's Scholar and Howard Hughes awards.

Undergraduate Research Opportunities

National Prestigious Fellowships Application

The University Honors Program and Global Initiatives collaborate to assist all Miami University Students and alumni to identify, plan for, and win national prestigious scholarships and fellowships to pursue graduate school, study or research abroad, and professional development.

To compete for a prestigious scholarship or fellowship, students should generally have the following:

- A cumulative grade point average of 3.75 or higher
- A history of substantial intellectual or creative projects
- Evidence of exemplary leadership or public service
- Three or more faculty members who can write you detailed letters of support.

Visit the national fellowship page: <http://www.miamioh.edu/fellowships>.

To get information about specific fellowship and scholarship opportunities and for help with the application process.

Global Initiatives

Aligned with Miami University's commitment to advance global learning, Global Initiatives promotes the dynamic, comprehensive internationalization of the University through the infusion of multicultural and comparative perspectives in scholarship, teaching, and service.

Our offices include Education Abroad Services, International Student and Scholar Services, the Center for American and World Cultures, the Confucius Institute and Continuing Education.

Visit: <http://www.MiamiOH.edu/global>

University Honors Program

UHP supports and provides opportunities for academically motivated students who want a highly challenging and intellectually enriched learning environment. The program emphasizes student discussion, intellectual exchange, reflection, and other active learning. Honors and Scholars students have frequent contact with faculty; many complete research or other projects working closely with a faculty mentor. UHP provides opportunities that include study abroad, funding for research and travel, internships, and social and cultural activities. The Honors community is comprised of students from all divisions at the University.

Visit: <http://www.honors.MiamiOH.edu>.

Acknowledgements

Undergraduate Research Forum Planning Committee Members:

Graduate School and Office for Advancement of Research and Scholarship and Office of Research for Undergraduates

James T. Oris, Joseph G. Johnson, Martha E. Weber, Valerie O. Robinson

The UR Forum planning committee comes together each year to invite the community to celebrate the research, scholarship and creative activities of our students. We appreciate the yearlong efforts and support of all of the mentors, departments, programs, and divisions who engage with students to foster creativity and research. The committee would also like to express our sincere appreciation to Valerie Robinson (Graduate School), and the many faculty, graduate students and staff members whose continued commitment to serve as moderators for the oral presentation format fosters undergraduate research and inquiry. The UR Forum planning committee commends the exemplary efforts of Martha E. Weber, Undergraduate Research Coordinator in the Office of Research for Undergraduates for the many hours of work to manage the details of this signature event.

Our special thanks to the dedicated staff members and students who contribute so much to this event:

- Technical Staff Supporting the Oral Presentations: Paula Fogt, Guy Moore, Larry Downes.
- Staff members: Lou Ann Haines, Vanessa Gordon, Jennifer Sutton, and Valerie Robinson.
- Miami's Trucking and Physical Facilities staff members delivering the poster boards
- Shriver Center Staff members: Susan Coleman, Alicia Rizzo, Neila Hanges, Jim Baker, Dennis Brown and their crew.
- Alpha Phi Omega Zeta Delta Chapter for their assistance with the poster session set up.

Undergraduate research at Miami is funded in part by the following contributors:

Arnold and Mabel Beckman Foundation	Madelene and George Shetler Diabetes Research Award Fund	The Cleveland Foundation
Clark Crannell Research Award Fund	Marjorie C. Britton Fund	The E.F. and Fern F. Patten Student Research Fund
Edward Kezur Scholarships	Miami Honors Program Student Initiative Fund	The Gund Foundation
Garden Club of Ohio	Miami Provost Office	The Ohio Board of Regents
Gary W. Barrett Research Award Fund	Nancy Anderson Brown Honors Program Fund	
Goldie Nott Student Research Fund	Susan Roberson Wilson Fund	
James E. Bever/David M. Scotford	William Borchers Fund	
Laboratory Research Fund	William and Caroline Stevenson Research Scholar Fund	
J. Beldon Dennison Scholar Room Fund	William Turrell Herbarium Fund	
Joseph F. Hogan Research Scholar Fund		
Kettering Fund		

To support undergraduate research at Miami, please contact:

Miami University, Director of Development • 725 East Chestnut • Oxford, OH 45056 • Phone: (513) 529-9260

PRESENTERS INDEX BY STUDENT LAST NAME

As a courtesy to the oral presenters, please enter the sessions during the 15-minute break and stay for entire oral session that begins on the hour. Reminder: Please check event locations on day of the event.

Oral Session I 9:00 – 9:45 a.m. (Break 9:45 a.m.)

Oral Session II 10:00 – 10:45 a.m. (Break 10:45 a.m.)

Oral Session III 11:00 – 11:45 a.m.

Oral Session IV 1:30 – 2:15 p.m. (Break 2:15 p.m.)

Oral Session V 2:30 – 3:15 p.m. (Break 3:15 p.m.)

Oral Session VI 3:30 – 4:15 p.m.

Poster presenters will be with their poster during their assigned time.

Session A (10:00 – 11:30 a.m.) **Session B** (1:30 – 2:45 p.m.) or **Session C** (3:00 – 4:30 p.m.)

Poster* = primary presenter

Last Name	First Name	Type	Poster Session	Poster Number	Building Location
Abdun	Lulu	Poster*	B	075	Shriver JDOL
Abell	Jon	Poster	A-B-C	096	Shriver JDOL
Abraham	Aaron	Poster	C	068	Shriver JDOL
Acheampong	Emelia	Poster*	C	070	Shriver JDOL
Adkins	Zachary	Poster*	C	069	Shriver JDOL
Aidoo	Doreen	Poster	C	075	Shriver JDOL
Akins	Sherry	Poster	C	076	Shriver JDOL
Al-Zubi	Sara	Poster*	A	067	Shriver JDOL
Albin	Ashley	Poster*	B	071	Shriver JDOL
Alley	Katy	Poster*	B	072	Shriver JDOL
Amend	Ben	Poster	A	011	Shriver JDOL
Amer	Lana	Poster*	C	041	Shriver JDOL
Amigo	Morgan	Poster*	B	007	Shriver JDOL
Andrews	Joslyn	Poster*	B	040	Shriver JDOL
Antle	Lauren	Poster*	B	05L	Shriver Lobby
Apapa	Jayeola	Poster	B	104	Shriver JDOL
Arlis	Sydney	Poster	A-B-C	096	Shriver JDOL
Arslain	Kristina	Poster	C	053	Shriver JDOL
Arvind	Sanchit Ram	Poster*	B	033	Shriver JDOL
Asomani	Linda	Poster	C	070	Shriver JDOL
Asselmeier	Charles	Poster*	C	102	Shriver JDOL
Babcock	Annastasia	Poster	A	088	Shriver JDOL
Babcock	Annastasia	Poster	A-B-C	096	Shriver JDOL
Bailey Van-Kuren	Dylan	Poster	C	067	Shriver JDOL
Bajrami	Silvi	Poster*	B	020	Shriver JDOL
Baker	Madison	Poster*	A	039	Shriver JDOL

PRESENTERS INDEX BY STUDENT LAST NAME

Last Name	First Name	Type	Poster Session	Poster Number	Building Location
Ball	Kaitlin	Poster	B	078	Shriver JDOL
Ball	Kayla	Poster	B	076	Shriver JDOL
Banerjee	Rishav	Poster	A	035	Shriver JDOL
Banerjee	Rishav	Poster	A	036	Shriver JDOL
Bansal	Meena	Poster*	B	043	Shriver JDOL
Bartels	Carrie	Poster	B	074	Shriver JDOL
Bashir	Sabina	Poster	A	049	Shriver JDOL
Baumgartner	Joseph	Poster*	C	092	Shriver JDOL
Baxter	Nick	Poster*	A	105	Shriver JDOL
Bean	Lamuel	Poster*	C	030	Shriver JDOL
Becker	Samantha	Poster	B	038	Shriver JDOL
Becker	Taylor	Poster*	A	048	Shriver JDOL
Becker	Samantha	Poster*	B	039	Shriver JDOL
Begezda	Abby	Poster*	A	044	Shriver JDOL
Behrend	Julia	Oral*	Session III	ASC-3001	Armstrong
Behrend	Julia	Poster*	B	005	Shriver JDOL
Belzer	Danielle	Poster*	C	083	Shriver JDOL
Benjamin	Benjamin	Poster	A	017	Shriver JDOL
Bennett	Jack	Poster*	A	031	Shriver JDOL
Bergmann	Kayla	Poster*	B	004	Shriver JDOL
Berray	Jamie	Poster*	A	097	Shriver JDOL
Biedenharn	Allison	Poster	A-B-C	096	Shriver JDOL
Bissmeyer	Paul	Poster	A	022	Shriver JDOL
Black	David	Poster*	B	045	Shriver JDOL
Black	Maddie	Poster	B	031	Shriver JDOL
Black	Samantha	Poster	B	056	Shriver JDOL
Blair	Kamari	Poster	B	077	Shriver JDOL
Blevins	Haylee	Poster	C	073	Shriver JDOL
Blumenthal	Emily	Poster	B	062	Shriver JDOL
Boardman	Haley	Poster*	B	022	Shriver JDOL
Boerger	Savannah	Poster	B	02L	Shriver Lobby
Boerger	Savannah	Poster*	B	027	Shriver JDOL
Bolen	Zoe	Poster	C	082	Shriver JDOL
Bolen	Zoe	Poster*	B	001	Shriver JDOL
Boll	Taylor	Poster	A	035	Shriver JDOL
Boll	Taylor	Poster	A	036	Shriver JDOL
Bollenbach	Storm	Poster*	C	075	Shriver JDOL
Bolton	Jess	Poster	A	085	Shriver JDOL
Bonsky	Heather	Oral	Session I	ASC-3056B	Armstrong

PRESENTERS INDEX BY STUDENT LAST NAME

Last Name	First Name	Type	Poster Session	Poster Number	Building Location
Borgarding	Kelsey	Poster	B	052	Shriver JDOL
Boris	Gabriel	Poster	B	023	Shriver JDOL
Bosomefi	Victoria	Poster	C	070	Shriver JDOL
Bosse	Samantha	Poster	C	015	Shriver JDOL
Bowers	Meghan	Poster	B	004	Shriver JDOL
Bowers	Meghan	Poster	C	092	Shriver JDOL
Bowley	Oliva	Poster	B	071	Shriver JDOL
Bowman	John	Poster*	C	043	Shriver JDOL
Bowman	Kimberly	Poster*	C	103	Shriver JDOL
Boyles	Sean	Poster*	A	006	Shriver JDOL
Bradford	Josh	Poster*	A	065	Shriver JDOL
Brady	Lauren	Poster	A	089	Shriver JDOL
Brady	Lauren	Poster*	C	093	Shriver JDOL
Brake	Marie	Poster*	A	021	Shriver JDOL
Briggs	Natalie	Poster	A	005	Shriver JDOL
Briggs	Natalie	Poster*	B	083	Shriver JDOL
Brinck	Sydney	Oral*	Session I	ASC-3056B	Armstrong
Brown	Abigai	Poster	B	043	Shriver JDOL
Brown	Jacob	Poster	C	015	Shriver JDOL
Brown	Kayla	Poster	B	088	Shriver JDOL
Brown	Nicholas	Poster	A	101	Shriver JDOL
Bryan	Annie	Poster*	A	027	Shriver JDOL
Bryant	Addison	Poster*	C	071	Shriver JDOL
Brzezinski	Emma	Poster*	C	02L	Shriver Lobby
Buck	Emma	Poster	C	005	Shriver JDOL
Buckingham	Brooke	Poster	A	031	Shriver JDOL
Bueter	Kyle	Poster*	C	009	Shriver JDOL
Burgess	Amanda	Poster	A-B-C	096	Shriver JDOL
Burke	Amanda	Poster*	B	02L	Shriver Lobby
Burke	Amanda	Poster*	C	104	Shriver JDOL
Burns	Nathan	Oral*	Session I	ASC-2042	Armstrong
Burns	Nathan	Poster*	B	002	Shriver JDOL
Bussell	Daniel	Poster	B	024	Shriver JDOL
Bussell	Taylor	Poster	C	066	Shriver JDOL
Bustle	Madison	Poster	C	078	Shriver JDOL
Byrket	Katherine	Poster*	A	074	Shriver JDOL
Byrne	Liam	Poster	C	079	Shriver JDOL
Caba	Antonia	Poster*	C	07L	Shriver Lobby
Cady	Angus	Poster	A	088	Shriver JDOL

PRESENTERS INDEX BY STUDENT LAST NAME

Last Name	First Name	Type	Poster Session	Poster Number	Building Location
Cai	Hong	Poster*	A	012	Shriver JDOL
Cain	Madison	Poster	B	045	Shriver JDOL
Caldwell II	Jeffrey	Poster*	A	029	Shriver JDOL
Callahan	Olivia	Poster*	C	031	Shriver JDOL
Campbell	Dillon	Poster*	C	054	Shriver JDOL
Campbell	Tiffany	Poster*	C	094	Shriver JDOL
Campe	Grace	Poster*	B	068	Shriver JDOL
Camper	Kristine	Poster*	A	03L	Shriver Lobby
Campos	Paulina	Poster	B	07L	Shriver Lobby
Capitulik	Shelby	Poster*	C	076	Shriver JDOL
Cappas	Madison	Poster*	B	050	Shriver JDOL
Capretta	Zachary	Poster	B	05L	Shriver Lobby
Carew	Jermaine	Poster	A	033	Shriver JDOL
Cariani	Zev	Poster*	C	091	Shriver JDOL
Carney	Margaret	Poster*	C	001	Shriver JDOL
Caroscio	Hannah	Poster*	B	031	Shriver JDOL
Carr	Phillip	Poster*	A	084	Shriver JDOL
Carrafiello	Luke	Poster	A-B-C	096	Shriver JDOL
Carroll	Patrick	Poster*	A	001	Shriver JDOL
Carter	Martha	Poster	C	088	Shriver JDOL
Carter	Martha	Poster*	C	090	Shriver JDOL
Cash	Carsen	Poster*	B	009	Shriver JDOL
Cashman	Connor	Poster	C	045	Shriver JDOL
Caudill	Hannah	Poster	B	031	Shriver JDOL
Cavagnaro	Anna	Oral*	Session II	ASC-3056B	Armstrong
Cavalco	Natalie	Poster*	A	033	Shriver JDOL
Chakravarti	Sumedha	Poster	A	067	Shriver JDOL
Chalke	Arya	Poster	C	105	Shriver JDOL
Challoner	Jackie	Poster	B	045	Shriver JDOL
Chan	Denise	Poster	A	059	Shriver JDOL
Chang	Le	Poster*	A	020	Shriver JDOL
Chapekis	Athena	Poster*	B	032	Shriver JDOL
Chasteen	Brittany	Poster	B	078	Shriver JDOL
Chatterjee	Wrik	Poster*	A	057	Shriver JDOL
Choudhury	Zaheer	Poster	B	02L	Shriver Lobby
Clark	Christine	Poster	C	001	Shriver JDOL
Colah	Avan	Poster*	C	010	Shriver JDOL
Collins	Ashantia	Poster*	C	074	Shriver JDOL
Collins	Olivia	Poster	A	088	Shriver JDOL

PRESENTERS INDEX BY STUDENT LAST NAME

Last Name	First Name	Type	Poster Session	Poster Number	Building Location
Colston	David	Poster	B	02L	Shriver Lobby
Colston	David	Poster	C	01L	Shriver Lobby
Colston	David	Poster*	A	104	Shriver JDOL
Colter	Kailee	Poster*	B	057	Shriver JDOL
Colussi	Nubia	Oral	Session III	ASC-3001	Armstrong
Colvin	Victoria	Poster*	B	062	Shriver JDOL
Conroy	Callen	Poster	A-B-C	096	Shriver JDOL
Contestable	Alexandra	Poster	B	036	Shriver JDOL
Cooper	Abby	Poster*	C	072	Shriver JDOL
Cooper	Bri	Poster*	C	013	Shriver JDOL
Cooper	Carly	Poster*	A	078	Shriver JDOL
Cornett	Emily	Poster*	C	077	Shriver JDOL
Cortez	Blake	Poster	B	042	Shriver JDOL
Cottingim	Kelsey	Poster	C	065	Shriver JDOL
Craney	Mackenzie	Poster	C	016	Shriver JDOL
Creber	Thatcher	Poster	B	081	Shriver JDOL
Creber	Thatcher Creber	Poster	C	086	Shriver JDOL
Crist	McKenzie	Oral*	Session V	ASC-3056B	Armstrong
Crookes	Justin	Poster	C	105	Shriver JDOL
Culberson	Emily	Poster	B	050	Shriver JDOL
Curen	Emily	Poster	A	031	Shriver JDOL
Curts	Clay	Poster	B	004	Shriver JDOL
Dabrowski	Chloe	Poster*	B	051	Shriver JDOL
Davey	Leah	Poster*	C	008	Shriver JDOL
Davis	Kristen	Poster	B	077	Shriver JDOL
Davis	Samantha	Poster	B	071	Shriver JDOL
Davis	Sean	Poster	C	013	Shriver JDOL
Davisson	Adam	Poster	A	035	Shriver JDOL
Davisson	Adam	Poster	A	036	Shriver JDOL
Deal	Mike	Poster*	A	018	Shriver JDOL
DeMartini	Zachary	Poster	A	023	Shriver JDOL
Demel	Kelsey	Poster	A	088	Shriver JDOL
DeRose	Ken	Oral*	Session II	ASC-2042	Armstrong
DeVillez	Ethan	Poster*	B	003	Shriver JDOL
Devitt	Jimmy	Poster*	A	05L	Shriver Lobby
Diana	Victoria	Oral*	Session IV	ASC-3056B	Armstrong
Diana	Victoria	Oral*	Session V	ASC-3056B	Armstrong
Diehl	Matt	Poster	A	068	Shriver JDOL
Dietz	Brook	Poster	B	079	Shriver JDOL

PRESENTERS INDEX BY STUDENT LAST NAME

Last Name	First Name	Type	Poster Session	Poster Number	Building Location
DiFilippo	Madeline	Poster*	C	098	Shriver JDOL
Digby	Zachary	Poster*	C	020	Shriver JDOL
Dilenge	Demi	Poster	C	01L	Shriver Lobby
Dobbs	Carrie	Poster*	C	022	Shriver JDOL
Donahey	Andrew	Poster	C	067	Shriver JDOL
Dong	Xin	Oral*	Session II	ASC-2042	Armstrong
Dong	Xin	Poster	A	095	Shriver JDOL
Donna	Julie	Poster	A-B-C	096	Shriver JDOL
Douglas	Caitlin	Poster	A	035	Shriver JDOL
Douglas	Caitlin	Poster	A	036	Shriver JDOL
Duhn	Kiley	Poster*	C	015	Shriver JDOL
Dunn	Mallory	Poster	A	092	Shriver JDOL
Ebenroth	Christina	Poster	A	035	Shriver JDOL
Ebenroth	Christina	Poster	A	036	Shriver JDOL
Ecklar	Brooke	Poster	A	101	Shriver JDOL
Edwards	Erica	Poster	B	030	Shriver JDOL
Eggert	Adam	Poster*	C	044	Shriver JDOL
Elstien	Kayla	Poster	B	031	Shriver JDOL
Enders	Alexa	Poster	A	088	Shriver JDOL
Enderson	Madison	Poster	A	035	Shriver JDOL
Enderson	Madison	Poster	A	036	Shriver JDOL
Engelking	Madeline	Poster*	B	084	Shriver JDOL
Enright	Erin	Poster	C	105	Shriver JDOL
Enright	Erin	Poster*	A	023	Shriver JDOL
Ethridge	Tori	Poster*	A	022	Shriver JDOL
Evans	Luke	Poster	B	062	Shriver JDOL
Everson	Kathy	Poster	B	080	Shriver JDOL
Faimon	Lillyanna	Poster	A	054	Shriver JDOL
Fang	Lin	Poster	C	057	Shriver JDOL
Farinazo	Giovanna	Oral	Session III	ASC-3001	Armstrong
Farnbacher	Thomas	Poster*	B	098	Shriver JDOL
Feazell	Maggie	Poster	C	066	Shriver JDOL
Fehlan	Kirsten	Poster	B	037	Shriver JDOL
Fendinger	Nick	Poster*	A	073	Shriver JDOL
Feng	Tian	Poster	B	024	Shriver JDOL
Feran	Allison	Poster	A	080	Shriver JDOL
Ferguson	Haley	Poster	B	105	Shriver JDOL
Ferguson	Katie	Poster*	C	023	Shriver JDOL
Fernandez	Gabrielle	Poster	A	072	Shriver JDOL

PRESENTERS INDEX BY STUDENT LAST NAME

Last Name	First Name	Type	Poster Session	Poster Number	Building Location
Fernandez	Gabrielle	Poster*	A	099	Shriver JDOL
Fernandez	Monica	Poster*	A	007	Shriver JDOL
Fichtner	Aisha	Poster	A	059	Shriver JDOL
Fields	Zachary	Poster*	C	004	Shriver JDOL
Finkenthal	Nikki	Poster	B	083	Shriver JDOL
Flint	Jason	Poster*	B	106	Shriver JDOL
Flum	Jacob	Poster	B	022	Shriver JDOL
Foley	Elizabeth	Oral*	Session III	ASC-3056B	Armstrong
Foster	Elizabeth	Poster*	C	021	Shriver JDOL
Frank	Dillon	Poster*	B	044	Shriver JDOL
Frankel	Jack	Poster	B	061	Shriver JDOL
Frankhauser	Rachel	Poster	B	087	Shriver JDOL
Frantz	Nick	Poster*	B	018	Shriver JDOL
Fredrick	Paul	Oral*	Session VI	ASC-3001	Armstrong
Frey	Noah	Poster	A	024	Shriver JDOL
Fry	Anna	Poster	C	073	Shriver JDOL
Fuhr	Alyssa	Poster*	C	032	Shriver JDOL
Gallagher	Casey	Poster*	A	079	Shriver JDOL
Gallowan	Francessca	Poster	B	032	Shriver JDOL
Garcia	Carolina	Poster	A	088	Shriver JDOL
Garcia	Denae	Poster	A	102	Shriver JDOL
Garcia De Jesus	Rebeca	Poster*	B	103	Shriver JDOL
Gassaway-Steere	Justin	Poster	C	065	Shriver JDOL
Gatts	Cailin	Poster*	C	053	Shriver JDOL
Gauvey	Kaleb	Poster	B	055	Shriver JDOL
Gawrys	Samantha	Poster*	B	025	Shriver JDOL
Geary	Emma	Poster*	B	047	Shriver JDOL
Geary	Emma	Poster*	C	047	Shriver JDOL
Gemma	Carly	Poster*	A	042	Shriver JDOL
Genaro	Jessica	Poster	C	095	Shriver JDOL
George	Sam	Poster*	C	068	Shriver JDOL
Gerber	Reed	Poster*	A	11L	Shriver Lobby
Germano	John	Poster*	B	060	Shriver JDOL
Ghent	Kaela	Poster	B	072	Shriver JDOL
Giangardella	Nathan	Poster	C	040	Shriver JDOL
Gilbert	Ben	Poster	B	025	Shriver JDOL
Glazer	Sandra	Oral*	Session V	ASC-2042	Armstrong
Glazier	Bradley	Poster*	A	017	Shriver JDOL
Glinos	Alexandra	Poster*	B	016	Shriver JDOL

PRESENTERS INDEX BY STUDENT LAST NAME

Last Name	First Name	Type	Poster Session	Poster Number	Building Location
Glover	Leah	Poster	C	075	Shriver JDOL
Goad	Brittany	Poster*	B	073	Shriver JDOL
Goldstein	Jessica	Poster	C	013	Shriver JDOL
Gonzales	Kirsten	Poster*	C	061	Shriver JDOL
Goodrich	Cole	Poster	A-B-C	096	Shriver JDOL
Goss	Chad	Poster	B	041	Shriver JDOL
Gottschalk	Lauren	Oral*	Session V	ASC-2042	Armstrong
Graham	Sean	Poster	C	081	Shriver JDOL
Greenlee	Jourdan	Poster*	C	033	Shriver JDOL
Gregerson	Lyndsey	Poster	C	065	Shriver JDOL
Grewal	Kon	Poster	B	103	Shriver JDOL
Groth	Nick	Poster	B	023	Shriver JDOL
Gruber	Jack	Poster*	A	102	Shriver JDOL
Gruenhagen	George	Oral*	Session II	ASC-3001	Armstrong
Guggenheimer	Marla	Poster	A	059	Shriver JDOL
Gunderman	Michael	Poster*	A	010	Shriver JDOL
Haffey	Christina	Oral*	Session II	ASC-3001	Armstrong
Hale	Danielle	Poster	B	077	Shriver JDOL
Hall	Ashton	Poster*	B	029	Shriver JDOL
Hall	Bailey	Poster	B	101	Shriver JDOL
Hamilton	Grace	Poster	B	02L	Shriver Lobby
Hansen	Megan	Poster*	B	030	Shriver JDOL
Hanson	Craig	Poster*	B	053	Shriver JDOL
Haralson	Anna	Poster	A	014	Shriver JDOL
Harbeson	Kristin	Poster	C	076	Shriver JDOL
Haring	Grace	Poster	B	07L	Shriver Lobby
Harris	Michael	Poster	A	023	Shriver JDOL
Harris	James	Poster*	C	04L	Shriver Lobby
Haught	Jack	Poster	B	087	Shriver JDOL
Hause	Annie	Poster*	A	054	Shriver JDOL
Hawkins	Rachel	Poster	A	088	Shriver JDOL
Hayes-Puttfarcken	Amanda	Poster	A	044	Shriver JDOL
He	Yitong	Poster	A	035	Shriver JDOL
He	Yitong	Poster	A	036	Shriver JDOL
Heath	Mary	Oral*	Session IV	ASC-3001	Armstrong
Heck	Morgan	Poster	B	074	Shriver JDOL
Heidelman	Martin	Poster*	C	042	Shriver JDOL
Heinrich	Greg	Poster	A	04L	Shriver Lobby
Heintz	Justin	Poster	A	088	Shriver JDOL

PRESENTERS INDEX BY STUDENT LAST NAME

Last Name	First Name	Type	Poster Session	Poster Number	Building Location
Helldoerfer	Carrie	Poster*	A	066	Shriver JDOL
Heller	Danny	Poster	C	06L	Shriver Lobby
Henderson	Amber	Poster	B	02L	Shriver Lobby
Henry	Connor	Poster*	B	012	Shriver JDOL
Henson	Allison	Poster	A	097	Shriver JDOL
Hickman	MacKenzie	Poster	B	071	Shriver JDOL
Higgins	Zachary	Poster	C	067	Shriver JDOL
Higgins	Bri	Poster*	A	005	Shriver JDOL
Hill	Chris	Poster	A	095	Shriver JDOL
Hiner	Sarah	Poster	B	090	Shriver JDOL
Hiner	Sarah	Poster	C	090	Shriver JDOL
Hiner	Sarah	Poster*	A	002	Shriver JDOL
Hirata	Hailey	Poster*	C	011	Shriver JDOL
Hird	Krystina	Poster*	B	082	Shriver JDOL
Hochstetler	Britt	Poster	B	050	Shriver JDOL
Holcomb	Palmer	Oral	Session II	ASC-3056B	Armstrong
Hollatz	Virginia	Poster*	B	058	Shriver JDOL
Hollingsworth	Ethan	Poster	A	090	Shriver JDOL
Hollingsworth	Ethan	Poster	C	094	Shriver JDOL
Hollingsworth	Ethan	Poster*	A	088	Shriver JDOL
Hollingsworth	Ethan	Poster*	A	089	Shriver JDOL
Holm	Trevor	Poster	B	089	Shriver JDOL
Hoover	Lauren	Poster*	A	083	Shriver JDOL
Horan	Casey	Poster	C	089	Shriver JDOL
Horman	Kris	Poster*	A	061	Shriver JDOL
Hosey	Violette	Poster	B	035	Shriver JDOL
Howard	Clare	Poster	B	085	Shriver JDOL
Howard	Jayvon	Poster*	A	070	Shriver JDOL
Hueslman	Connor	Poster	B	006	Shriver JDOL
Hughes	Wil	Poster*	C	084	Shriver JDOL
Huo	Zhengjia	Poster	A	11L	Shriver Lobby
Hurt	Taylor	Poster	A	014	Shriver JDOL
Igel	Megan	Poster	C	097	Shriver JDOL
Ingram	Elizabeth	Poster	B	072	Shriver JDOL
Inutsuka	Sean	Poster	A	023	Shriver JDOL
Ising	Noah	Poster*	C	089	Shriver JDOL
Issenmann	Mary	Poster*	A	082	Shriver JDOL
Jackson	Benjamin	Poster*	B	101	Shriver JDOL
Jackson	Madison	Poster*	A	055	Shriver JDOL

PRESENTERS INDEX BY STUDENT LAST NAME

Last Name	First Name	Type	Poster Session	Poster Number	Building Location
Jackson	Megan	Poster	A	034	Shriver JDOL
Jacobo	Jose	Poster	C	019	Shriver JDOL
Jacobs	Elizabeth	Poster	C	003	Shriver JDOL
Jacques	Isaiah	Poster*	A	032	Shriver JDOL
James	Samuel	Poster*	A	008	Shriver JDOL
Jeffers	Erika	Poster*	C	03L	Shriver Lobby
Jones	Caitlyn	Poster	B	062	Shriver JDOL
Jones	Caitlyn	Poster*	C	029	Shriver JDOL
Jones	Daniel	Poster	C	080	Shriver JDOL
Jones	Danielle	Oral	Session VI	ASC-3056B	Armstrong
Jones	Jamie	Poster	C	077	Shriver JDOL
Jones	Meghan	Poster	A	101	Shriver JDOL
Juwillie	Mona-Mae	Poster*	A	058	Shriver JDOL
Juwillie	Mona-Mar	Poster	B	02L	Shriver Lobby
Kaplevatsky	Ryan	Poster	A	032	Shriver JDOL
Karikas	John	Poster	B	02L	Shriver Lobby
Kashyap	Jyoti	Poster	C	091	Shriver JDOL
Kellamis	Natalia	Poster*	B	097	Shriver JDOL
Keller	Benjamin	Poster*	C	088	Shriver JDOL
Keller	Benjamin	Poster*	C	087	Shriver JDOL
Keller	Rachel	Poster	A	087	Shriver JDOL
Kelly	Matthew	Poster*	C	067	Shriver JDOL
Kempf	Hannah	Poster*	B	100	Shriver JDOL
Kenes	Aldiyar	Poster*	B	059	Shriver JDOL
Kennedy	Caroline	Poster	A	102	Shriver JDOL
Keshock	Nicole	Poster*	A	069	Shriver JDOL
King	Ashley	Poster	B	079	Shriver JDOL
Kingsbury	Sara	Poster	C	097	Shriver JDOL
Kistenfeger	Quinn	Poster	B	105	Shriver JDOL
Knight	Megan	Poster*	B	074	Shriver JDOL
Koehler	Kenna	Poster*	C	066	Shriver JDOL
Koehler	Matthew	Poster*	A	003	Shriver JDOL
Kollias	Anelise	Poster	C	025	Shriver JDOL
Konrad	Emily	Poster*	A-B-C	096	Shriver JDOL
Koranteng	Patricia	Poster	B	073	Shriver JDOL
Kosse	Sarah	Poster*	A	026	Shriver JDOL
Kou	Rita	Poster	B	039	Shriver JDOL
Kou	Rita	Poster*	B	038	Shriver JDOL
Kowalski	Katie	Poster	B	068	Shriver JDOL

PRESENTERS INDEX BY STUDENT LAST NAME

Last Name	First Name	Type	Poster Session	Poster Number	Building Location
Kreiner	Leah	Poster	C	078	Shriver JDOL
Krienen	Alec	Poster	B	023	Shriver JDOL
Kuhn	Leah	Poster*	A	034	Shriver JDOL
Kuperman	Daniel	Oral*	Session II	ASC-3056B	Armstrong
Kuznieski	Gregory	Poster	B	023	Shriver JDOL
Lab	Shelby	Poster	A	088	Shriver JDOL
Lab	Shelby	Poster	C	094	Shriver JDOL
Lab	Shelby	Poster*	A	090	Shriver JDOL
Lahey	Olivia	Poster*	C	051	Shriver JDOL
Lambert	Taylor	Poster*	B	079	Shriver JDOL
Landers	Joseph	Oral*	Session I	ASC-2042	Armstrong
Lane	Marissa	Poster*	C	050	Shriver JDOL
Lane	Netanya	Poster*	B	093	Shriver JDOL
Lanoue	Alex	Poster	C	086	Shriver JDOL
Latch	Tyler	Poster*	B	041	Shriver JDOL
Latimer	John	Poster*	A	030	Shriver JDOL
Lawson	Ciara	Poster	B	081	Shriver JDOL
Le	Linh	Poster	A	014	Shriver JDOL
Leaman	Henry	Oral*	Session I	ASC-3001	Armstrong
Lee	Andrea	Poster*	A	062	Shriver JDOL
Lei	In Hong	Poster*	B	069	Shriver JDOL
Lensmeyer	Erin	Poster	C	066	Shriver JDOL
Lentz	Hannah	Poster	B	056	Shriver JDOL
Leonard	Elise	Poster*	C	063	Shriver JDOL
Leveridge	Max	Poster*	B	102	Shriver JDOL
Levikov	Briana	Poster*	A	091	Shriver JDOL
Levin	Stephanie	Oral*	Session I	ASC-3001	Armstrong
Lewis	Sam	Poster	A	033	Shriver JDOL
Lichter	James	Poster*	B	008	Shriver JDOL
Liesch	Nathaniel	Poster*	B	08L	Shriver Lobby
Lilly	Jordan	Poster*	C	016	Shriver JDOL
Lin	Ling	Poster	B	076	Shriver JDOL
Lindner	Haleigh	Poster	C	074	Shriver JDOL
Lindner	Haleigh	Poster*	C	095	Shriver JDOL
Lloyd	Gwen	Poster	C	01L	Shriver Lobby
Lloyd	Meredith	Poster*	A	095	Shriver JDOL
Long	Brian	Poster*	B	014	Shriver JDOL
Long	Garrett	Oral*	Session V	ASC-3001	Armstrong
Lopez Gonzalez	Eulalia	Poster	B	073	Shriver JDOL

PRESENTERS INDEX BY STUDENT LAST NAME

Last Name	First Name	Type	Poster Session	Poster Number	Building Location
Lopez Gonzalez	Maria Lopez	Poster	B	073	Shriver JDOL
Lott	Danielle	Poster	B	103	Shriver JDOL
Lovell	Caleb	Oral*	Session III	ASC-3001	Armstrong
Lu	Meng	Poster	C	026	Shriver JDOL
Lundin	Madeline	Poster*	B	067	Shriver JDOL
Madias	Steven	Poster	A-B-C	096	Shriver JDOL
Manning	Corey	Poster	B	052	Shriver JDOL
March	Lexi	Poster	A	088	Shriver JDOL
Marcus	Kelly	Poster	C	01L	Shriver Lobby
Margerum	Cristie	Poster	B	034	Shriver JDOL
Marsh	Taft	Poster*	C	007	Shriver JDOL
Martin	Bridget	Poster*	B	078	Shriver JDOL
Martin	Mary	Oral	Session VI	ASC-3056B	Armstrong
Martin	Mary	Oral*	Session IV	ASC-3056B	Armstrong
Mazanek	Catherine	Oral*	Session V	ASC-3056B	Armstrong
Mazursky	Alex	Poster*	B	054	Shriver JDOL
McArthur	Allyson	Poster*	B	085	Shriver JDOL
McBride	Megan	Poster*	A	056	Shriver JDOL
McBride	Zack	Oral*	Session II	ASC-3056B	Armstrong
McConahay	Brandi	Oral*	Session I	ASC-3056B	Armstrong
McConahay	Brandi	Poster*	A	02L	Shriver Lobby
McConahay	Brandi	Poster*	B	01L	Shriver Lobby
McConahay	Brandi	Poster*	C	01L	Shriver Lobby
McCudden	Molly	Poster	A	090	Shriver JDOL
McElligott	Caitlin	Oral*	Session VI	ASC-3056B	Armstrong
McElligott	Caitlin	Poster	B	02L	Shriver Lobby
McElligott	Caitlin	Poster	C	01L	Shriver Lobby
McElroy	Bryn	Poster*	C	097	Shriver JDOL
McFarland	Jacob	Oral*	Session IV	ASC-2042	Armstrong
McFarland	Jacob	Poster	C	048	Shriver JDOL
McGovern	Eri	Poster	B	098	Shriver JDOL
McHenry	Patrick	Poster	C	067	Shriver JDOL
McKenna	Mary	Poster	C	016	Shriver JDOL
McLaughlin	Christian	Poster	B	072	Shriver JDOL
McPherson	Steven	Poster*	B	036	Shriver JDOL
Megura	Matt	Poster	A	032	Shriver JDOL
Meisler	Adam	Poster	A	018	Shriver JDOL
Melanson	Grace	Poster	B	035	Shriver JDOL
Melendez	Lyric	Poster	B	05L	Shriver Lobby

PRESENTERS INDEX BY STUDENT LAST NAME

Last Name	First Name	Type	Poster Session	Poster Number	Building Location
Merkle	Hannah	Poster*	A	087	Shriver JDOL
Meyer	Troy	Poster*	C	100	Shriver JDOL
Miles	Jack	Poster	A	024	Shriver JDOL
Miller	Ashley	Poster*	A	081	Shriver JDOL
Miller	Halle	Poster	A	095	Shriver JDOL
Miller	Noah	Poster	A	101	Shriver JDOL
Miller	Tara	Poster*	A	08L	Shriver Lobby
Millhouse	Allison	Poster	B	074	Shriver JDOL
Milligan	Spencer	Poster*	B	037	Shriver JDOL
Minshall	Brianna	Poster*	B	049	Shriver JDOL
Mitchell	Kristin	Poster	A	073	Shriver JDOL
Mitchell	Mikayla	Oral*	Session III	ASC-3056B	Armstrong
Mitchem	Cortney	Poster	A-B-C	096	Shriver JDOL
Molloy	Danny	Poster	B	046	Shriver JDOL
Moon	Justin	Poster	A	031	Shriver JDOL
Moore	Rylan	Poster	A	054	Shriver JDOL
Moore	Sarah	Poster	C	074	Shriver JDOL
Mordzinski	Victoria	Poster	A	089	Shriver JDOL
Mordzinski	Victoria	Poster	C	094	Shriver JDOL
Moro	Carly	Poster*	A	10L	Shriver Lobby
Morris	Micah	Poster*	C	034	Shriver JDOL
Moser	Meredith	Poster*	A	019	Shriver JDOL
Mossman	Emily	Poster	C	077	Shriver JDOL
Mueller	Alex	Poster*	C	101	Shriver JDOL
Mullen	Quentin	Poster*	A	004	Shriver JDOL
Mullet	Collin	Poster	B	022	Shriver JDOL
Musolff	Clayton	Poster*	A	04L	Shriver Lobby
Myers	Emily	Poster	B	032	Shriver JDOL
Myers	Mallory	Poster	A	035	Shriver JDOL
Myers	Mallory	Poster	A	036	Shriver JDOL
Myers	Mallory	Poster*	A	092	Shriver JDOL
Myers	Mickey	Poster	A	059	Shriver JDOL
Nader	Austin	Poster	B	061	Shriver JDOL
Naille	Laney	Poster	A	090	Shriver JDOL
Nakano	Mayu	Poster*	A	038	Shriver JDOL
Nayak	Vedha	Poster	B	030	Shriver JDOL
Neubecker	Trent	Poster*	A	068	Shriver JDOL
Nisbet	Erika	Poster	B	052	Shriver JDOL
Nixdorf	Jennifer	Poster	A	035	Shriver JDOL

PRESENTERS INDEX BY STUDENT LAST NAME

Last Name	First Name	Type	Poster Session	Poster Number	Building Location
Nixdorf	Jennifer	Poster	A	036	Shriver JDOL
Nobile	Lauren	Poster	B	042	Shriver JDOL
Noble	Jalen	Poster*	C	079	Shriver JDOL
Nordhaus	Brittany	Poster	C	087	Shriver JDOL
Nordhaus	Brittany	Poster*	A	035	Shriver JDOL
Nordhaus	Brittany	Poster*	A	036	Shriver JDOL
Noviski	David	Poster*	A	014	Shriver JDOL
Nshom	Nicoline	Poster	C	072	Shriver JDOL
O'Donnell	Cody	Poster*	A	100	Shriver JDOL
O'Wesney	Sydney	Poster*	A	037	Shriver JDOL
O'Brien	Annie	Poster	A	101	Shriver JDOL
Oates	Miranda	*	B	07L	Shriver Lobby
Oates	Miranda	Poster*	B	06L	Shriver Lobby
Obih	Prisca	Poster	C	070	Shriver JDOL
Obregon	Mercedes	Poster	A	054	Shriver JDOL
Oddo	Alyssa	Oral	Session VI	ASC-3056B	Armstrong
Okolo	Imokhai	Oral	Session VI	ASC-2042	Armstrong
Olmsted	Sam	Poster	A	11L	Shriver Lobby
Orzel	Joanna	Poster*	A	053	Shriver JDOL
Osowski	Kira	Poster	A	035	Shriver JDOL
Osowski	Kira	Poster	A	036	Shriver JDOL
Osowski	Kira	Poster	C	019	Shriver JDOL
Osowski	Kira	Poster*	C	018	Shriver JDOL
Osterholt	Maren	Poster*	A	025	Shriver JDOL
Osterwisch	Paige	Poster*	B	052	Shriver JDOL
Owen	Malory	Poster*	C	006	Shriver JDOL
Owens	Olivia	Poster*	A	045	Shriver JDOL
Oyeh	Alain	Poster	C	076	Shriver JDOL
Padgett	Josh	Poster	C	073	Shriver JDOL
Pair	Julia	Oral*	Session I	ASC-3001	Armstrong
Pal	Reeti	Poster	B	02L	Shriver Lobby
Pal	Reeti	Poster*	B	063	Shriver JDOL
Palacios	Paolo	Poster	A-B-C	096	Shriver JDOL
Palo	Dylan	Poster*	A	013	Shriver JDOL
Pandian	Rathiesh	Poster*	B	013	Shriver JDOL
Papamarcos	Marie	Poster*	C	086	Shriver JDOL
Pascoe	Emily	Poster	A	089	Shriver JDOL
Patel	Nikita	Poster	A	035	Shriver JDOL
Patel	Nikita	Poster	A	036	Shriver JDOL

PRESENTERS INDEX BY STUDENT LAST NAME

Last Name	First Name	Type	Poster Session	Poster Number	Building Location
Patrick	Corrie	Poster	B	074	Shriver JDOL
Patterson	Marian	Poster*	C	049	Shriver JDOL
Peguero	Allison	Poster	B	104	Shriver JDOL
Pena-Lopez	Maria	Poster	B	076	Shriver JDOL
Penhos	Elena	Poster*	C	06L	Shriver Lobby
Perkins	Jaylen	Poster	A	090	Shriver JDOL
Perry	Megan	Poster	C	094	Shriver JDOL
Perry	Megan	Poster	C	095	Shriver JDOL
Perry	Megan	Poster*	B	064	Shriver JDOL
Pescovitz	Andrew	Poster*	A	080	Shriver JDOL
Peters	Jenn	Poster	A	034	Shriver JDOL
Petro	Grace	Poster*	A	085	Shriver JDOL
Pfeil	Daniel	Poster*	A	043	Shriver JDOL
Pham	Nhat	Poster*	C	080	Shriver JDOL
Phillips	Gil	Poster*	B	006	Shriver JDOL
Pochiro	Lana	Poster*	A	028	Shriver JDOL
Polak	Rachel	Poster*	B	105	Shriver JDOL
Polinsky	Alexander	Poster	B	02L	Shriver Lobby
Popovec	Mikala	Poster	B	050	Shriver JDOL
Porter	Anna	Poster*	B	026	Shriver JDOL
Poth	Justin	Poster*	C	005	Shriver JDOL
Poth	Robert	Poster*	B	048	Shriver JDOL
Potineni	Nachiket	Poster*	C	064	Shriver JDOL
Powers	Hanna	Poster	C	071	Shriver JDOL
Poyfair	Rachel	Poster*	A	01L	Shriver Lobby
Poythress	Lauren	Poster	B	036	Shriver JDOL
Preissing	Ali	Oral*	Session VI	ASC-3001	Armstrong
Prior	Anjali	Poster*	A	016	Shriver JDOL
Proud	Benjamin	Poster	B	079	Shriver JDOL
Pudlo	Giuliana	Poster	C	016	Shriver JDOL
Racadio	Andrew	Poster	B	02L	Shriver Lobby
Rajczyk	Jenna	Poster*	C	040	Shriver JDOL
Raker	Ellee	Poster	A	099	Shriver JDOL
Ramsey	Lauren	Oral*	Session VI	ASC-3056B	Armstrong
Randall	Kristina	Poster*	C	085	Shriver JDOL
Rapp	Anthony	Poster*	A	011	Shriver JDOL
Rarden	Kevin	Poster*	C	024	Shriver JDOL
Rasor	Blake	Poster*	C	106	Shriver JDOL
Raudenbush	Stephanie	Poster*	A	106	Shriver JDOL

PRESENTERS INDEX BY STUDENT LAST NAME

Last Name	First Name	Type	Poster Session	Poster Number	Building Location
Reece	Adam	Oral*	Session VI	ASC-2042	Armstrong
Reed	Emma	Poster	B	045	Shriver JDOL
Regan	Hannah	Oral*	Session VI	ASC-3001	Armstrong
Reid	Terry	Poster	B	05L	Shriver Lobby
Retcher	Ethan	Poster	B	041	Shriver JDOL
Rhoades	Jeffrey	Poster	A	033	Shriver JDOL
Rice	Savannah	Poster*	A	024	Shriver JDOL
Richardson	Kimberly	Poster	B	078	Shriver JDOL
Richter	Dale	Poster	B	077	Shriver JDOL
Richter	Olivia	Poster*	A	040	Shriver JDOL
Rigot	Megan	Poster	A	082	Shriver JDOL
Rigot	Megan	Poster*	C	045	Shriver JDOL
Rinehart	Dolly	Poster	A	084	Shriver JDOL
Ritchie	Emily	Poster*	A	075	Shriver JDOL
Ritter	Everett	Poster*	C	055	Shriver JDOL
Rivers	Adam	Poster*	B	019	Shriver JDOL
Rizzo	Juliana	Poster	B	032	Shriver JDOL
Rizzo	Juliana	Poster	B	103	Shriver JDOL
Rizzo	Olivia	Poster	B	022	Shriver JDOL
Roach	JP	Poster*	C	052	Shriver JDOL
Roach	Nicklaus	Poster*	B	034	Shriver JDOL
Roan	Danyelle	Poster*	C	027	Shriver JDOL
Roberts	Dannie	Poster*	A	063	Shriver JDOL
Robertson	Hannah	Poster*	A	060	Shriver JDOL
Rodriguez	Chanely	Poster	C	072	Shriver JDOL
Roebel	Zachary	Poster*	C	046	Shriver JDOL
Rook	Jayson	Poster	A	011	Shriver JDOL
Rosalez	Savana	Poster	C	01L	Shriver Lobby
Ross	Danielle	Poster	A	090	Shriver JDOL
Roti	Caroline	Poster*	C	035	Shriver JDOL
Rowe	Jennifer	Poster	C	102	Shriver JDOL
Rub	Jennifer	Poster*	B	080	Shriver JDOL
Ruby	Hannah	Poster*	A	049	Shriver JDOL
Rumsey	Ann	Oral*	Session V	ASC-3001	Armstrong
Rust	Austin	Poster	A	101	Shriver JDOL
Rutherford	Lena	Oral*	Session I	ASC-3056B	Armstrong
Rutowski	Joshua	Poster*	A	015	Shriver JDOL
Rybakowicz	Ross	Poster	C	002	Shriver JDOL
Saaranen	Michael	Poster*	C	048	Shriver JDOL

PRESENTERS INDEX BY STUDENT LAST NAME

Last Name	First Name	Type	Poster Session	Poster Number	Building Location
Safer	Brianne	Poster*	C	014	Shriver JDOL
Samanthula	Durga	Poster	B	106	Shriver JDOL
Scarlato	Lili	Poster	A	090	Shriver JDOL
Schad	Lindsey	Poster	B	02L	Shriver Lobby
Schad	Lindsey	Poster*	B	03L	Shriver Lobby
Schad	Lindsey	Poster*	B	04L	Shriver Lobby
Schaeffer	Tiago	Poster	A	011	Shriver JDOL
Schaeffer	Tiago	Oral*	Session IV	ASC-2042	Armstrong
Schafer	Austin	Poster	A	046	Shriver JDOL
Schapker	Nicole	Poster	C	02L	Shriver Lobby
Scheive	Katelyn	Poster	A	089	Shriver JDOL
Scheive	Katelyn	Poster	C	093	Shriver JDOL
Scheper	Madison	Poster*	A	06L	Shriver Lobby
Schilstra	Keith	Poster	A	035	Shriver JDOL
Schilstra	Keith	Poster	A	036	Shriver JDOL
Schleicher	Drew	Poster	A	090	Shriver JDOL
Schlueter	Thomas	Poster	B	024	Shriver JDOL
Schmitt	Meredith	Poster	B	051	Shriver JDOL
Schneider	Koby	Poster	B	089	Shriver JDOL
Schneider	Lydia	Poster*	C	025	Shriver JDOL
Schroeder	Morgan	Poster	B	036	Shriver JDOL
Schulte	Kyle	Poster*	B	099	Shriver JDOL
Schultz	Jacob	Poster*	A	009	Shriver JDOL
Schultz	Kelsy	Poster	C	003	Shriver JDOL
Schumacher	Tyler	Poster	B	062	Shriver JDOL
Schwabe	Nick	Poster	C	079	Shriver JDOL
Sciaccotta	Francesca	Poster	A	099	Shriver JDOL
Sedacca	Ella	Poster*	A	041	Shriver JDOL
Sedlack	Kole	Poster*	C	105	Shriver JDOL
Seitz	Marisa	Poster	A	086	Shriver JDOL
Sekerak	Joshua	Oral	Session I	ASC-3056B	Armstrong
Selby	Ashley	Poster	B	079	Shriver JDOL
Semko	Sierra	Poster*	A	076	Shriver JDOL
Serafin	Rachel	Poster	B	02L	Shriver Lobby
Serafin	Rachel	Poster*	B	017	Shriver JDOL
Seto	Tori	Poster*	B	011	Shriver JDOL
Severin	Dana	Poster*	C	073	Shriver JDOL
Shea	Allie	Poster*	B	095	Shriver JDOL
Sheely	Matt	Poster	B	055	Shriver JDOL

PRESENTERS INDEX BY STUDENT LAST NAME

Last Name	First Name	Type	Poster Session	Poster Number	Building Location
Shelton	Trevor	Poster	B	072	Shriver JDOL
Shields	Jessica	Poster	B	062	Shriver JDOL
Shin	Eric	Oral	Session VI	ASC-2042	Armstrong
Shomo	Amy	Poster	B	084	Shriver JDOL
Short	Audrey	Poster*	C	060	Shriver JDOL
Short	Samantha	Poster	B	076	Shriver JDOL
Sidler	Elaine	Poster*	B	021	Shriver JDOL
Sieman	Katherine	Poster*	B	010	Shriver JDOL
Sifuentes	Caitlin	Poster	B	040	Shriver JDOL
Silber	Rachel	Poster	B	02L	Shriver Lobby
Simbartl	Nick	Poster	A	034	Shriver JDOL
Simmons	Eleanor	Poster	A	072	Shriver JDOL
Simon	Jessica	Poster	B	081	Shriver JDOL
Simoni	Aaron	Poster*	B	015	Shriver JDOL
Simpson	Brittany	Poster	C	072	Shriver JDOL
Simpson	Jason	Poster*	C	05L	Shriver Lobby
Singstock	Mitchell	Poster	A	032	Shriver JDOL
Skeels	Amy	Poster	A	059	Shriver JDOL
Skelly	Brooke	Poster	B	056	Shriver JDOL
Slattery	Jessie	Oral*	Session V	ASC-3001	Armstrong
Smith	Kendall	Poster	B	104	Shriver JDOL
Smith	Kendall	Poster*	C	002	Shriver JDOL
Smith	Kyle	Poster	B	101	Shriver JDOL
Smith	Steph	Poster	A-B-C	096	Shriver JDOL
Smith	Zachary	Poster*	C	081	Shriver JDOL
Sommerfield	Nate	Poster	A	068	Shriver JDOL
Sorice	Sabato	Poster*	B	028	Shriver JDOL
Spellacy	Nicole	Poster*	B	023	Shriver JDOL
Spinello	Brian	Poster*	A	050	Shriver JDOL
Sprock	Leah	Poster	B	046	Shriver JDOL
Sprowles	Kimberly	Poster	C	013	Shriver JDOL
Spurgus	Nicholas	Poster	B	044	Shriver JDOL
Stair	Landen	Poster	A	101	Shriver JDOL
Statczar	Alexandra	Poster*	B	024	Shriver JDOL
States	Lindsey	Poster*	A	093	Shriver JDOL
Stefan	Symeon	Poster	A	013	Shriver JDOL
Stelzer	Danielle	Poster	C	084	Shriver JDOL
Stemen	Claire	Oral*	Session IV	ASC-3056B	Armstrong

PRESENTERS INDEX BY STUDENT LAST NAME

Last Name	First Name	Type	Poster Session	Poster Number	Building Location
Stewart	Isaiah	Poster*	C	036	Shriver JDOL
Stickley	Stickley	Poster	C	03L	Shriver Lobby
Stillman	Ellie	Poster	B	050	Shriver JDOL
Stoecklein	Danie	Poster	A	023	Shriver JDOL
Stradling	Brandon	Poster	B	051	Shriver JDOL
Strassburger	Courtney	Poster	B	071	Shriver JDOL
Strauss	Bethany	Poster*	B	094	Shriver JDOL
Street	Brandon	Poster	A	101	Shriver JDOL
Strickley	Michael	Poster*	C	012	Shriver JDOL
Suarez	Diana	Poster*	A	07L	Shriver Lobby
Sullivan	David	Poster	C	025	Shriver JDOL
Sullivan	Emily	Poster	B	024	Shriver JDOL
Sullivan	Rachel	Poster	A	090	Shriver JDOL
Sumaita	Inma	Oral*	Session IV	ASC-3001	Armstrong
Summers	Kevin	Poster*	A	071	Shriver JDOL
Summers	Kevin	Poster*	B	065	Shriver JDOL
Supeck	Tim	Poster	A	101	Shriver JDOL
Swope	Alaina	Poster*	A	077	Shriver JDOL
Taggart	Carley	Poster*	B	056	Shriver JDOL
Tailor	Jade	Poster	B	051	Shriver JDOL
Tangeman	Jared	Oral*	Session I	ASC-2042	Armstrong
Tantiartyanontha	Takdanai	Oral*	Session VI	ASC-2042	Armstrong
Tate	Mason	Poster*	B	104	Shriver JDOL
Tatro	Alan	Poster*	C	059	Shriver JDOL
Taylor	Alec	Poster	C	079	Shriver JDOL
Taynor	Kristina	Poster*	A	094	Shriver JDOL
Terrace	Brad	Oral*	Session IV	ASC-3001	Armstrong
Theberge	Allison	Poster*	A	051	Shriver JDOL
Thomas	Gwendolyn	Poster*	C	062	Shriver JDOL
Thomas	Nicholas	Poster*	C	099	Shriver JDOL
Thompson	Kaitlin	Oral*	Session III	ASC-3056B	Armstrong
Thompson	Kayla	Poster	B	009	Shriver JDOL
Thompson	Shelby	Poster*	C	065	Shriver JDOL
Thompson	Victoria	Poster*	A	059	Shriver JDOL
Thurston	Lindsay	Poster*	A	09L	Shriver Lobby
Timmons	Eric	Poster	B	104	Shriver JDOL
Titterington	Sarah	Poster	C	071	Shriver JDOL
Trevethan	Mackenzie	Poster*	B	035	Shriver JDOL
Trimboli	Joshua	Poster*	B	087	Shriver JDOL

PRESENTERS INDEX BY STUDENT LAST NAME

Last Name	First Name	Type	Poster Session	Poster Number	Building Location
Trowbridge	Amy	Poster	A	051	Shriver JDOL
Trowbridge	Amy	Poster*	A	052	Shriver JDOL
Truster	Mary	Poster*	C	078	Shriver JDOL
Turoff	Kylie	Poster	C	071	Shriver JDOL
Unger	Alexandra	Poster*	C	003	Shriver JDOL
Upshaw	Chanell	Poster	B	02L	Shriver Lobby
Upshaw	Chanell	Poster*	B	070	Shriver JDOL
Uwingeneye	Claire	Poster	B	073	Shriver JDOL
Vanderhoof	Nick	Poster*	C	037	Shriver JDOL
VanDoren	Nicole	Poster	C	066	Shriver JDOL
Victoria	Ruben	Poster	A	04L	Shriver Lobby
Viterisi	Marai	Poster	B	022	Shriver JDOL
von Carlowitz	Graham	Poster*	C	017	Shriver JDOL
Von Der Vellen	Bryan	Poster*	C	019	Shriver JDOL
Vrzal	Nick	Poster*	B	055	Shriver JDOL
Wadsworth	Tessa	Poster	B	018	Shriver JDOL
Wagner	Sara	Poster	A	052	Shriver JDOL
Walton	Julia	Poster	C	065	Shriver JDOL
Wang	Hehe	Oral*	Session II	ASC-3001	Armstrong
Ward	Sarah	Poster*	A	086	Shriver JDOL
Wasson	Brittney	Poster	B	078	Shriver JDOL
Weaver	Kyle	Poster*	A	103	Shriver JDOL
Weaver	Nikki	Poster	C	015	Shriver JDOL
Weesner	Rachael	Poster*	A	072	Shriver JDOL
Weiland	Abigail	Poster*	B	092	Shriver JDOL
Wesseh	Rebecca	Poster	A	054	Shriver JDOL
Wexler	Micaela	Poster*	B	046	Shriver JDOL
Whalen	Danika	Poster	A	095	Shriver JDOL
White	Robert	Poster*	B	061	Shriver JDOL
Wiater	Naomi	Poster*	C	056	Shriver JDOL
Wigton	Connor	Poster	A	11L	Shriver Lobby
Wilkins	Keiko	Poster*	B	089	Shriver JDOL
Wilkins	Keiko	Poster*	B	090	Shriver JDOL
Wilkins	Keiko	Poster*	B	091	Shriver JDOL
Williams	Aonesti	Poster	A	044	Shriver JDOL
Williams	Tisa	Poster*	B	077	Shriver JDOL
William	Rebecca	Poster	A	090	Shriver JDOL
Wilson	Emily	Poster*	A	064	Shriver JDOL
Wilson	Le'Andra	Poster*	B	076	Shriver JDOL

PRESENTERS INDEX BY STUDENT LAST NAME

Last Name	First Name	Type	Poster Session	Poster Number	Building Location
Wilson	Sarah	Poster*	B	088	Shriver JDOL
Winstel	Maggie	Poster*	B	066	Shriver JDOL
Wise	Megan	Poster	C	077	Shriver JDOL
Wittman	Jane	Poster	C	075	Shriver JDOL
Wnek	Olivia	Poster	B	038	Shriver JDOL
Wnek	Olivia	Poster	B	039	Shriver JDOL
Wohl	Sarah	Poster*	A	101	Shriver JDOL
Woodruff	Andrew	Poster*	C	082	Shriver JDOL
Woods	Hannah	Poster*	C	028	Shriver JDOL
Woods	Kelsey	Poster	A	090	Shriver JDOL
Worley	Claudia	Poster*	C	039	Shriver JDOL
Worner	Cassandra	Poster	C	092	Shriver JDOL
Worner	Cassandra	Poster*	A	046	Shriver JDOL
Wu	Jiayu	Poster*	C	057	Shriver JDOL
Wu	Junrong	Poster	C	058	Shriver JDOL
Wyand	Rachel	Poster	A	059	Shriver JDOL
Wyand	Sarah	Poster*	B	086	Shriver JDOL
Xu	Mengyang	Poster*	C	026	Shriver JDOL
Yamada-Killilea	Marie	Poster	C	014	Shriver JDOL
Younce	Abby	Poster	A	081	Shriver JDOL
Young	Anthony	Oral*	Session IV	ASC-2042	Armstrong
Youngwirth	Samantha	Poster*	B	042	Shriver JDOL
Zerkle	Hannah	Poster*	A	098	Shriver JDOL
Zhang	Jingwei	Poster	A	083	Shriver JDOL
Zhang	Yunhan	Poster*	A	047	Shriver JDOL
Zhao	Simin	Poster	C	091	Shriver JDOL
Zhao	Xiaoxiao	Poster*	C	058	Shriver JDOL
Zhuo	Linzhao	Oral*	Session II	ASC-2042	Armstrong
Ziegman	Jacqueline	Poster*	C	038	Shriver JDOL

Notes

Notes

DO YOU HAVE...

A HIGH
GPA

RESEARCH, SCHOLARLY,
INTERNATIONAL OR
PRE-PROFESSIONAL
EXPERIENCES

FACULTY
MENTORSHIP
LEADERSHIP
ABILITY



THEN YOU MAY BE COMPETITIVE FOR A

NATIONAL FELLOWSHIP



PRESTIGIOUS NATIONAL AWARDS
OFFERING FUNDING FOR STUDY ABROAD
AND POSTGRADUATE STUDY OR RESEARCH



INTERESTED?

WWW.MIAMIOH.EDU/FELLOWSHIPS

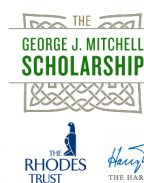



Your work goes on from today

An invitation from Jerome U. Conley
Dean and University Librarian

Congratulations on presenting your research at Miami University's 23rd annual Undergraduate Research Forum. Our University Libraries team commends you for using your time as an undergraduate student to not only learn and grow but also to create and contribute something to the collected knowledge of our world.

That contribution does not need to end with today's Undergraduate Research Forum.

The Miami University Scholarly Commons, hosted by the University Libraries, serves as an institutional repository for high quality academic work like yours. It preserves journals, capstone projects, presentation posters, award-winning papers and more, making the important scholarly work of our students and faculty accessible for the future.

We would like to extend you the opportunity to publish your poster in the Miami Scholarly Commons.

In addition to having your work preserved and retaining ownership of your copyright, you will receive a permanent citable reference to your work for your résumé. To upload your files to the Scholarly Commons, visit **[MiamiOH.formstack.com/forms/msc](https://miamiOH.formstack.com/forms/msc)**.

Again, congratulations on your achievement. We hope, in the midst of your research, that you have discovered a passion for discovery that extends beyond today. Through the resources and expertise we offer, the Miami University Libraries are eager to support you in the next leg of your research journey.

Sincerely,

Jerome U. Conley
Dean and University Librarian

Contact Information

ORU

Office of Research
for Undergraduates

P: 513-529-2455

122 King Library
[MiamiOH.edu/oru](https://miamiOH.edu/oru)

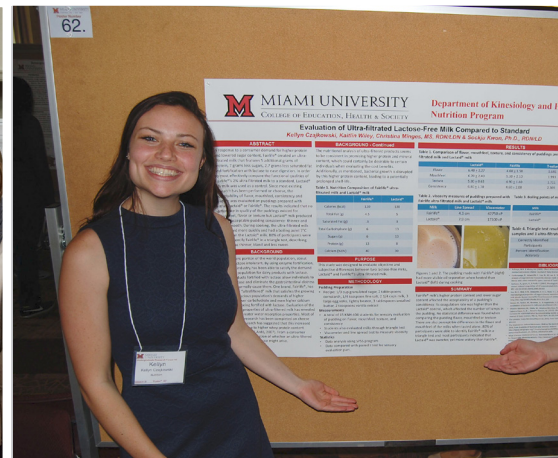
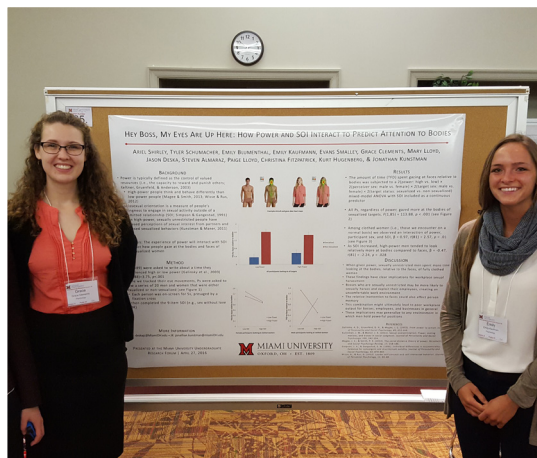
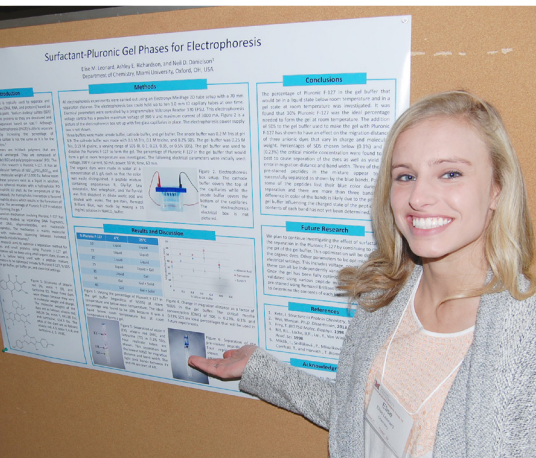
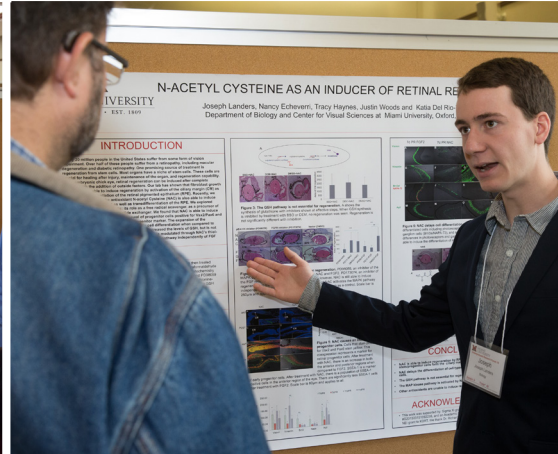
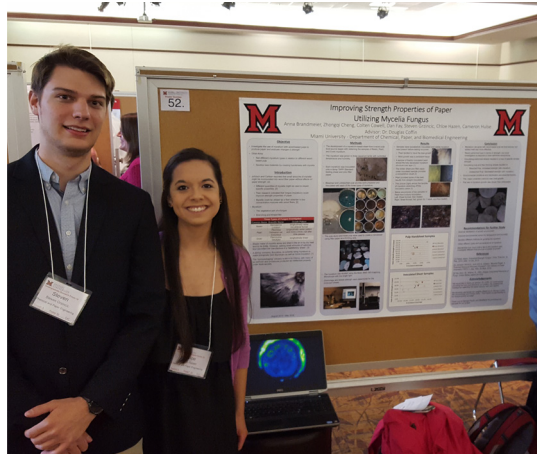
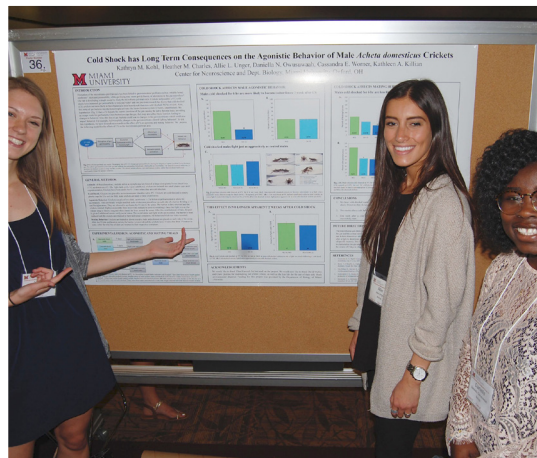
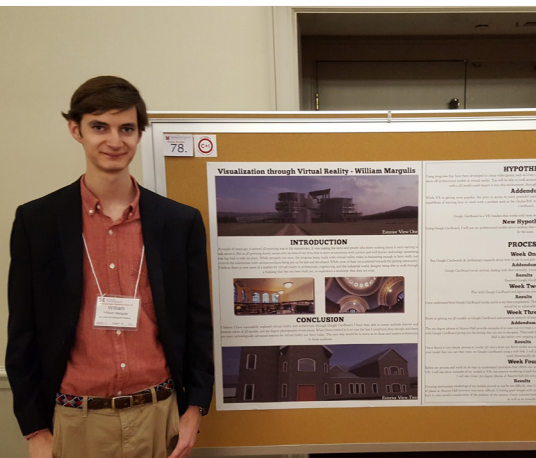

MiamiOH.edu/oru